

1 PLAYGROUND PAVING ENLARGEMENT PLAN
1" = 10'-0"

LEGEND

- RUBBER SURFACING
- 8" WIDE, 6" HIGH RAISED CONCRETE CURB - SEE CIVIL DETAILS
- 6" WIDE FLUSH CONCRETE CURB - SEE CIVIL DETAILS
- 18" WIDE, 18" HIGH CONCRETE SEATWALL - SEE SHEET L3.2, DTL 5 AND GRADING PLAN FOR ELEVATIONS
- GROUND COVER/PERENNIALS
- CP CENTER POINT
- INTERPRETATIVE SIGNAGE

GENERAL NOTES:

1. COMPLY WITH ALL APPLICABLE FEDERAL, STATE AND LOCAL CODES AND ORDINANCES FOR ALL WORK AND OPERATIONS.
2. KEEP ALL AREAS CLEAN, NEAT AND ORDERLY AT ALL TIMES. CLEAR OF RUBBISH AND DEBRIS. LEGALLY DISPOSE OF ALL MATERIALS REMOVED FROM THE SITE.
3. DO NOT INTERFERE WITH USE OF ADJACENT PROPERTIES INCLUDING BUT NOT LIMITED TO BUILDINGS, PARKING LOTS, STREETS OR ALLEYS.
4. PROTECT STRUCTURES, UTILITIES, SIDEWALKS, PAVEMENTS, FENCING, FURNISHINGS AND PLANTINGS, TREES AND LAWNS FROM DAMAGE CAUSED BY SETTLEMENT, LATERAL MOVEMENT, UNDERMINING, WASHOUTS, AND OTHER HAZARDS CREATED BY SITE IMPROVEMENTS. IF ANY DAMAGE OCCURS, REPAIR TO ORIGINAL CONDITION AT NO ADDITIONAL COST.
5. PROTECT AND/OR RESTORE EXISTING LAWN TO EXCELLENT CONDITION WITH TOPSOIL AND SO2.
6. VERIFY SITE CONDITIONS BEFORE PROCEEDING WITH WORK AND REPORT ANY CONFLICT TO AOR.
7. VERIFY DIMENSIONS IN FIELD.
8. COORDINATE WORK WITH ALL OTHER TRADES.

PAVING NOTES:

1. FINAL LOCATION AND DIMENSIONS OF PREGOLA FOOTINGS TO BE COORDINATED WITH THE EXISTING PERGOLA DIMENSIONS TO BE REINSTALLED.
2. MAINTAIN ALL ADA CLEARANCES AT CONCRETE SEATWALL OPENINGS AT RELOCATED PERGOLA AREA.
3. COORDINATE ALL PLAYGROUND EQUIPMENT FOUNDATION LOCATIONS WITH ALL UTILITY LINES AND PLAYGROUND UNDER DRAINS.

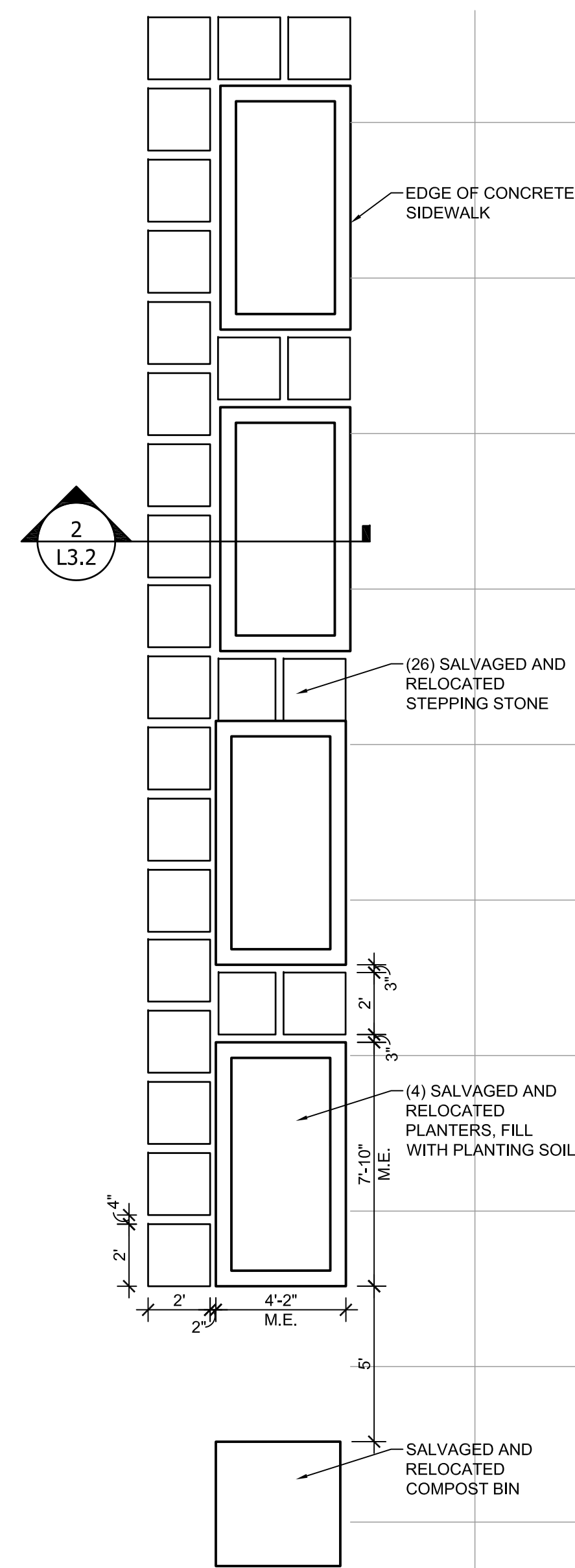

2 RELOCATED PLANTERS ENLARGEMENT PLAN
1/4" = 1'-0"

NOTES:
1. DIMENSIONS SHOWN ARE TYPICAL AND CONTINUE FOR ENTIRE LENGTH OF THE STEPPING STONE AREA.

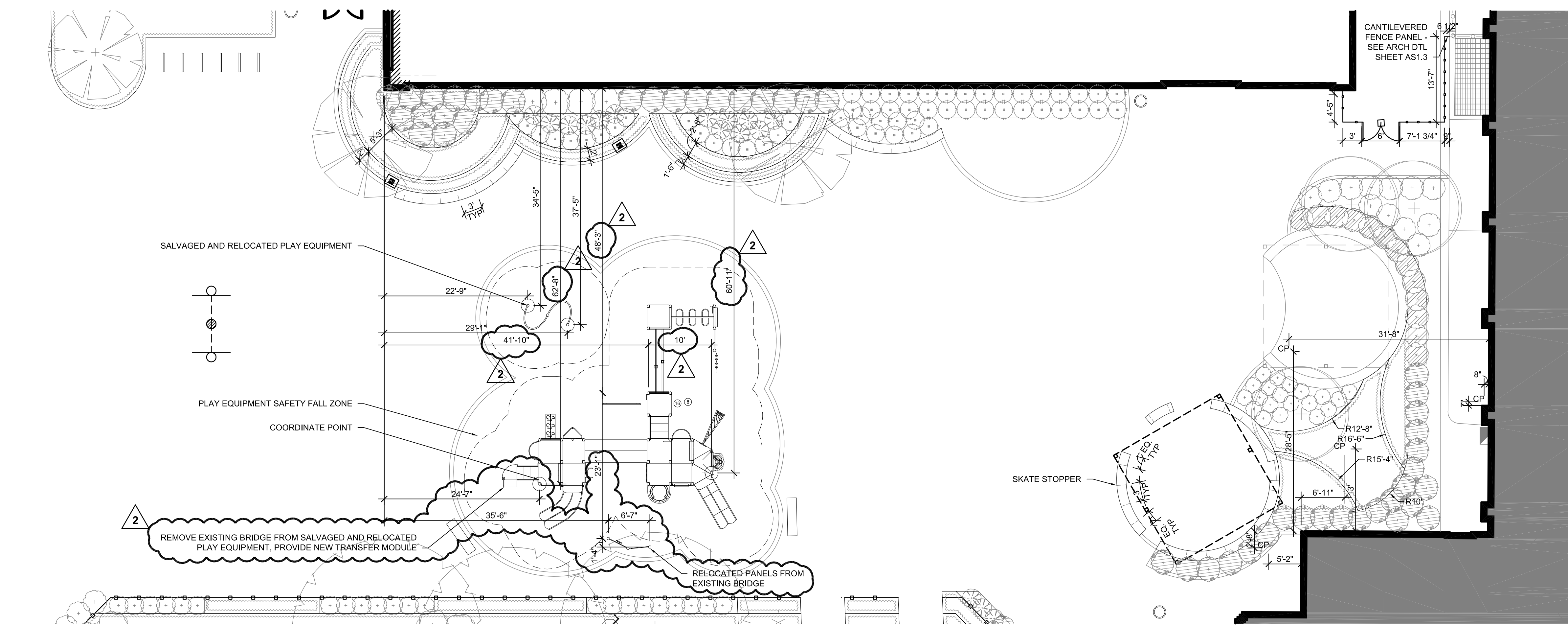

3 PLAYGROUND EQUIPMENT AND LANDSCAPE ENLARGEMENT PLAN
1" = 10'-0"

The Illinois Prairie

What is a prairie?
A prairie is a large area of flat, rolling grassland, with few trees and very rich soil. The word prairie comes from a French word meaning "meadow".

The prairie in Illinois was created by glaciers that drifted across the land from even further north than Wisconsin hundreds of thousands of years ago. The glaciers left behind deep fertile soil covered with grasses and wildflowers.

Over half of Illinois was once covered with 22 million acres of prairie. That is 5.5 million Chicago Cubs Wrigley Field!

The prairie changes each season. What do you see now?

Spring comes quietly with the emergence of bright green sprouts and flowers with delicate early blooms.

Autumn is the time for the plants to show off their seed heads and for the wind carry the seeds to new places.

Summer arrives and the prairie bursts into a colorful playground for hummingbirds, butterflies and bees.

Winter gives prairie roots a long sleep under the snow. Grasses and grasses provide food and shelter for birds.

4 INTERPRETATIVE SIGNAGE TYPE A
NOT TO SCALE

Roots

Roots are the living part of the prairie plants hidden deep within the earth. They wiggle through the soil searching for water and nutrients.

Roots help the plant grow strong leaves, flowers and seeds. Some roots are as long as your arm. Some prairie plants have roots that can grow longer than YOU with your arms stretched way up to the sky!

Weeds

Weeds are plants that are not welcome in the garden.

Sneaky little weeds try to disguise themselves and hide among the native plants. Do not let them fool you. They take away the nutrients, sun and water from the plants.

Weeds usually have very shallow roots and they grow FAST! Keep your eyes peeled for these common garden invaders.

Can you find any of these common weeds?

Carrot Weeds, Ragwort, Nightshade, Garlic Mustard, Chickweed, Yellow Flowers, Green Leaves

5 INTERPRETATIVE SIGNAGE TYPE B
NOT TO SCALE

WARNING: LEAD-BASED PAINT MAY BE PRESENT WITHIN THE BUILDING. IT IS THE RESPONSIBILITY OF THE CONTRACTOR TO TAKE APPROPRIATE SAFETY MEASURES IN ACCORDANCE WITH APPLICABLE FEDERAL, STATE, AND LOCAL RULES AND REGULATIONS INCLUDING OSHA 1926.62 COMPLIANCE, WASTE CHARACTERIZATION AND WASTE DISPOSAL. ALL WORK WITH SURFACES CONTAINING LEAD-BASED PAINT SHALL BE DONE IN ACCORDANCE WITH SECTION 02133.



EDISON PARK ELEMENTARY SCHOOL ANNEX
6220 N. OLCOTT AVE
CHICAGO, IL 60631
CHICAGO PUBLIC SCHOOLS
CITY OF CHICAGO, MAYOR RAHM EMANUEL

THESE DRAWINGS HAVE BEEN PREPARED AT AND FOR UNDER MY SUPERVISION AND TO THE BEST OF MY KNOWLEDGE AND BELIEF CONFORM AND COMPLY WITH THE REQUIREMENTS OF THE CHICAGO DEPARTMENT OF BUILDING.

ILLINOIS
KATHLEEN O'DONNELL
REGISTERED ARCHITECT
001-016351
EXPIRATION DATE: NOVEMBER 30, 2014

TRIPARTITE, INC
Architecture Restoration Design
4720 N. Virginia Ave.
Chicago, Illinois 60625
P: 773-451-0034
www.tripartiteinc.com

MATRIX ENGINEERING CORPORATION
3318 N. JACKSON BLVD. 4TH FLOOR CHICAGO, IL 60654
STRUCTURAL ENGINEERING

SITE DESIGN GROUP, LTD.
888 S. MICHIGAN AVE. SUITE 1801 CHICAGO, IL 60605
LANDSCAPE ARCHITECTURE

TERRA ENGINEERING, LTD.
235 W. OHIO STREET, 4TH FLOOR CHICAGO, IL 60604
CIVIL ENGINEERING

CALOR DESIGN GROUP, LTD.
2017 N. WESTERN AVE. CHICAGO, IL 60647
MECHANICAL, PLUMBING, FIRE PROTECTION

TECHKNOW ENGINEERING, LLC
1316 S. MICHIGAN ST. SUITE 1101 CHICAGO, IL 60605
QUALITY CONTROL, LOW VOLTAGE, SECURITY, FIRE ALARM

HJ KESSLER ASSOCIATES
1880 N. LAKE SHORE DRIVE, SUITE 501 CHICAGO, IL 60613
LEED CONSULTING

EDGE ASSOCIATES, INC
203 E. LAKE STREET, SUITE 303 / ADDISON, IL 60101
FOOD SERVICES

DOOR SECURITY SOLUTIONS
1110 PETER AVE. HANDELSPARK, IL 60146
HARDWARE CONSULTANT

PIN DROP ACOUSTICS
2017 N. LAKE STREET #109 CHICAGO, IL 60606
ACOUSTIC CONSULTANT

ISSUANCE

MARK	DESCRIPTION	DATE
1	ISSUE FOR BID	12-18-12
2	ADDENDUM 2	01-22-13
3	-	-
4	-	-
5	-	-
6	-	-
7	-	-
8	-	-

SCALE: AS NOTED
PLOT DATE: 1/22/2013

PROJECT NAME: EDISON PARK ELEMENTARY SCHOOL ANNEX
PBC CONTRACT NO.: PS1799X
PROJECT NO.: 05650

WARNING: ASBESTOS-CONTAINING BUILDING MATERIALS ARE OR MAY BE PRESENT IN THIS BUILDING. AN ASBESTOS MANAGEMENT PLAN IS AVAILABLE IN THE SCHOOL. FOR REVIEW UPON REQUEST. NO PERSON MAY DISTURB ASBESTOS CONTAINING MATERIALS UNLESS THAT PERSON IS A LICENSED ASBESTOS WORKER OR CONDUCTS SUCH WORK IN ACCORDANCE WITH SPECIFICATIONS CONTAINED IN THE PROJECT DOCUMENTS AND IN COMPLIANCE WITH ILLINOIS DEPARTMENT OF HEALTH RULES AND REGULATIONS.

TITLE:
PLAYGROUND ENLARGEMENT PLANS

SHEET
L1.3