









Mark	Description	Date
1	BID SET	01.28.10
2	REVISED PER PBC REVIEW	02.02.10
3	ISSUE FOR BID	02.10.10
4	ADDENDUM 1	02.26.10

PBC Project Name: Marshall Campus Park  
PBC Contract No.: 1507  
PBC Project No.: 02030  
Terra Project No.: 09-180  
Title

GRADING PLAN

C-300

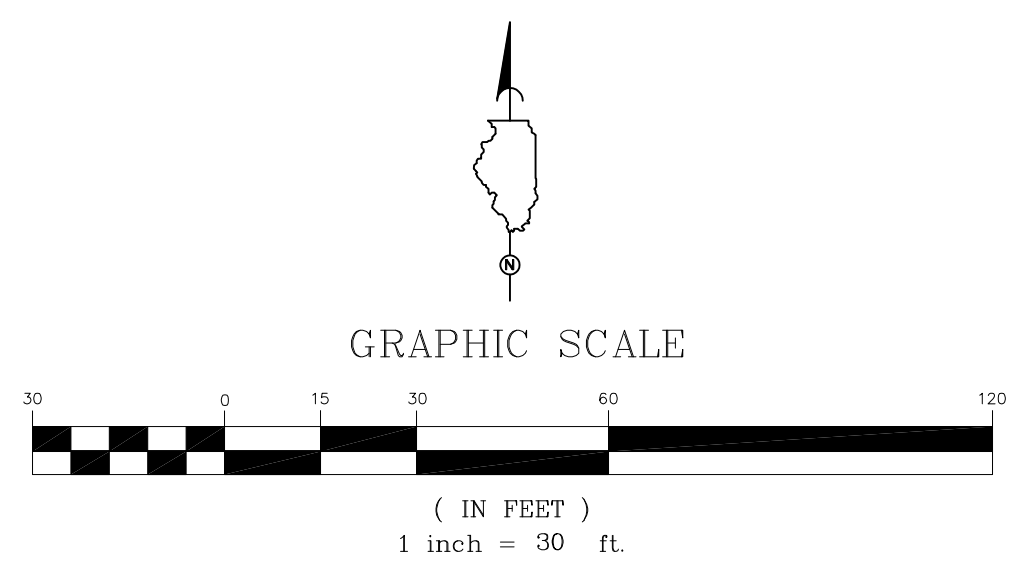

- EXISTING LEGEND AND ABBREVIATIONS (FROM SURVEY):**
- Storm MH
  - Storm CB
  - Storm Inlet
  - San MH
  - San Clean Out
  - Water Valve Vault
  - Water MH
  - Water Buffalo Box
  - Water Hand Hole
  - Water Meter
  - Water Fire Hydrant
  - Telephone MH
  - Telephone Vault
  - Telephone Pedestal
  - Public Telephone
  - Combination Pedestal
  - Utility Pole
  - Electric Manhole
  - Electric MH
  - Electric Vault
  - Electric Meter
  - Electric Pad
  - Electric Pedestal
  - Electric Light Pole
  - Electric Traffic Signal
  - Electric Light Pole with Traffic Signal
  - Electric Traffic Control Box
  - Electric Traffic Vault
  - Electric Ground Light
  - Gas Buffalo Box
  - Gas Hand Hole
  - Gas Meter
  - Gas Valve
  - Gas MH
  - Gas Vault
  - Cable TV Pedestal
  - Tree - Deciduous
  - Tree - Evergreen
  - Parking Meter
  - Sign Post
  - Mail Box
  - Bumper Post
  - Guy Anchor
  - Soil Boring
  - Unclassified Manhole
  - Auto Sprinkler
  - Hose Connection
  - Fire Alarm
  - Flag Pole

- LEGEND AND ABBREVIATIONS:**
- PL PROJECT PROPERTY LIMITS
  - ⊙ BOTTOMLESS CATCH BASIN (DW)
  - ⊙ CATCH BASIN (CB)
  - ⊙ MANHOLE (MH)
  - ⊙ AREA DRAIN (AD)
  - ⊙ WATER METER VAULT
  - CLEAN OUT (CO)
  - ⊙ RISER (R)
  - ME MATCH EXISTING ELEVATION
  - DC DEPRESSED CURB
  - 14.80 TOP OF CURB
  - 14.20 BOTTOM OF CURB
  - 14.20 SPOT ELEVATION
  - HWL HIGH WATER LEVEL
  - CCD CHICAGO CITY DATUM
  - FFE FINISHED FLOOR ELEVATION
  - 14.80 TW TOP OF RETAINING WALL
  - 14.20 BW BOTTOM OF RETAINING WALL
  - 2.0% SLOPE
  - STORMWATER RUN-OFF
  - PROVIDE INLET PROTECTION
  - OF OVERFLOW

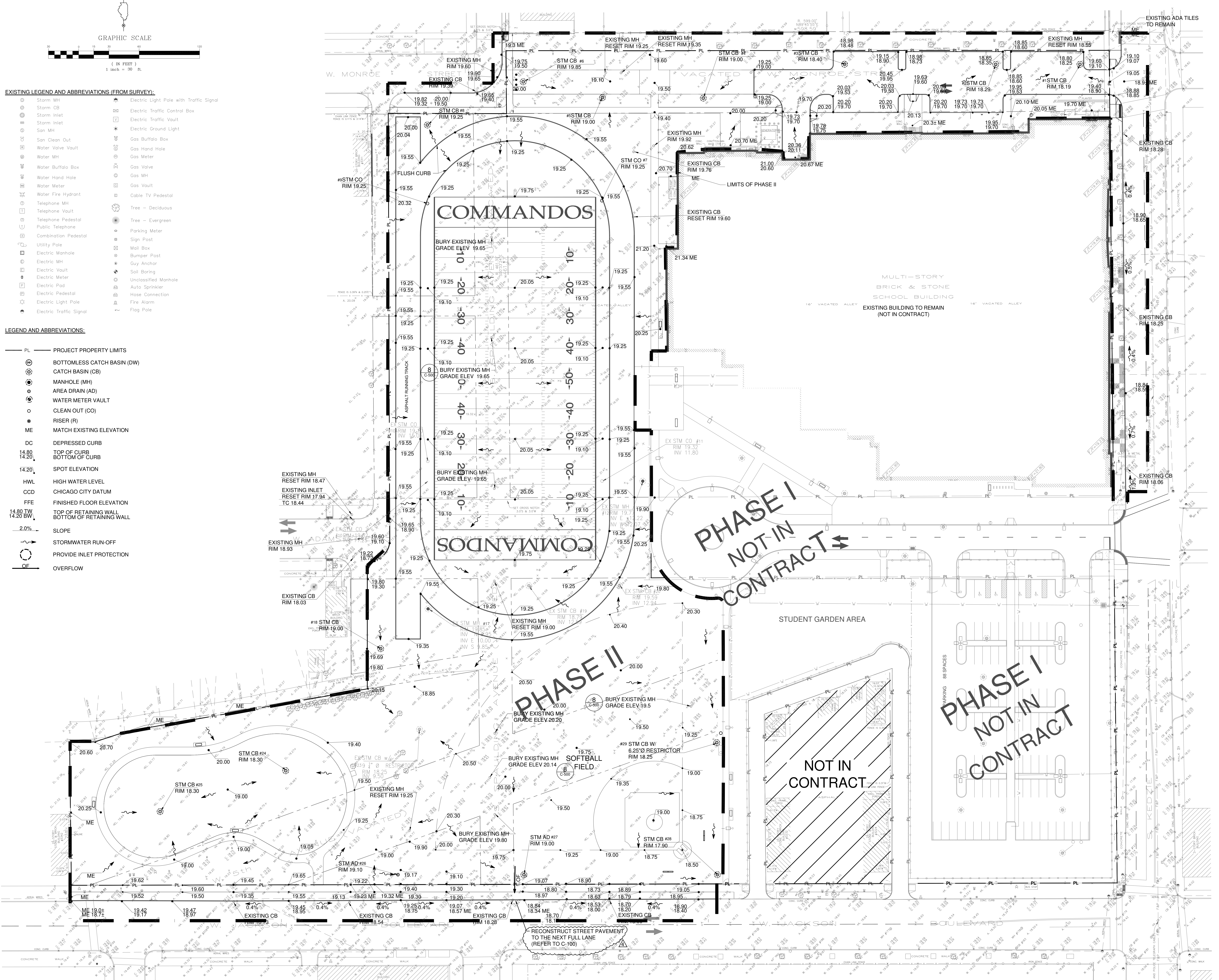

Sheet



TRANSVERSE JOINTS OF A TYPE SIMILAR TO THAT USED IN THE ADJACENT PAVEMENT SHALL BE INSTALLED THE DETAILS OF THE TRANSVERSE JOINTS IN THE CURB/GUTTER AND COMBINED CURB & GUTTER SHALL BE IN THE CURB/GUTTER AND COMBINED CURB & GUTTER IN PROPORTION WITH THE JOINTS IN THE PAVEMENT PAVEMENT. 1" THICK EXPANSION JOINTS COMPOSED OF BITUMINOUS PREFORMED JOINT FILLER SHALL BE INSTALLED IN THE CURB AND/OR GUTTER AT POINTS OF CURVATURE AND AT CONSTRUCTION JOINTS. CON-APPROVED CURB, GUTTER OR COMBINED CURB & GUTTER BE CONSTRUCTED ADJACENT TO A FLEXIBLE BASE TRACTION JOINTS SHALL ALSO BE PLACED BETWEEN THESE EXPANSION JOINTS AT DISTANCES NOT EXCEEDING 20 FEET. ALL TIE BARS SHALL BE CORRUGATED. ALL DOWEL BARS SHALL BE SMOOTH.

NOTES:  
 H = VARIABLE (SEE PLAN) WHERE H DOES NOT EXCEED 12"  
 Y = ONE HALF THE THICKNESS OF CONCRETE PAVEMENT OR CONCRETE BASE.  
 Z = 10" OR THICKNESS OF PAVEMENT - WHICHEVER IS GREATER

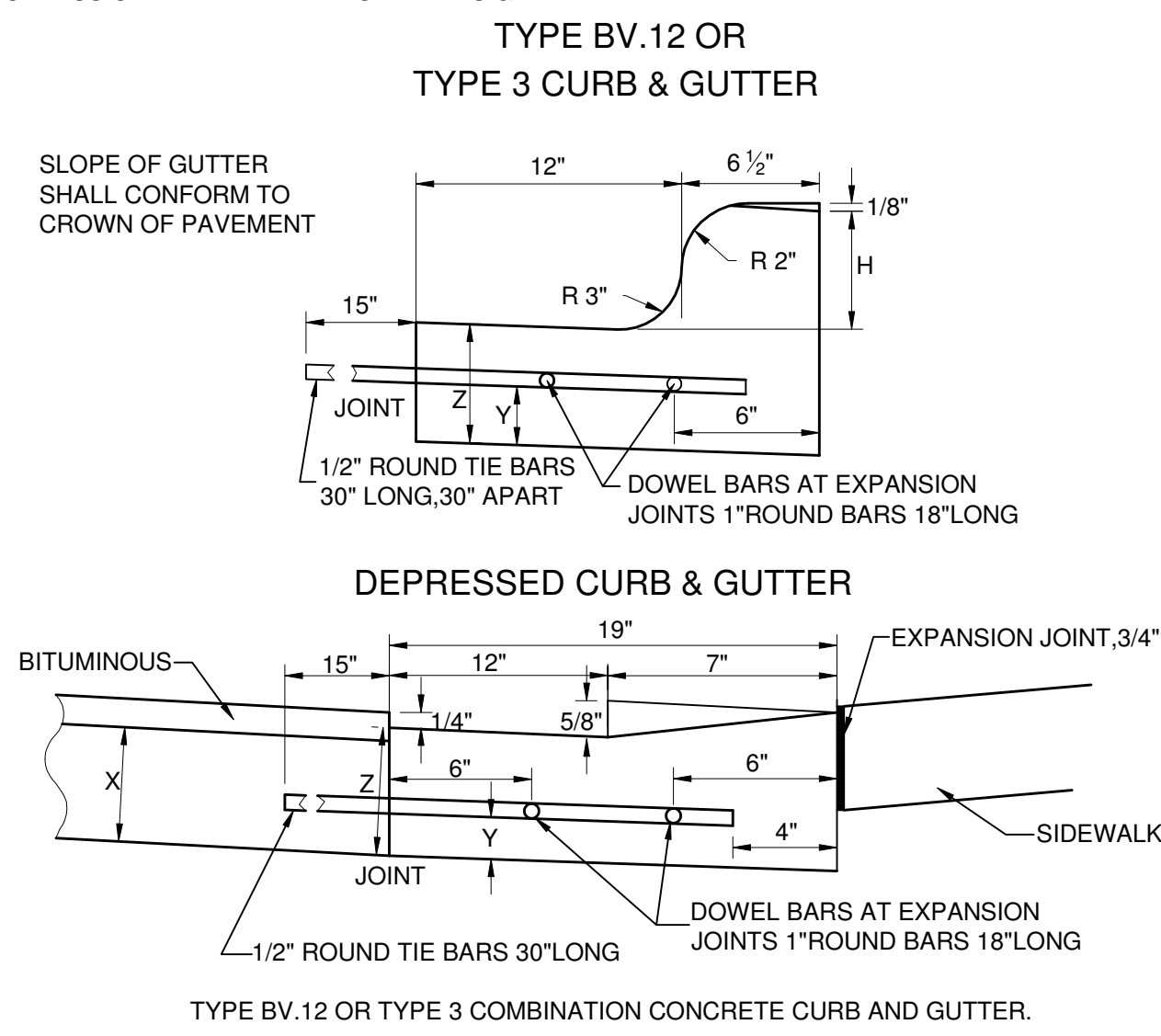

1 CURB & GUTTER DETAIL NTS

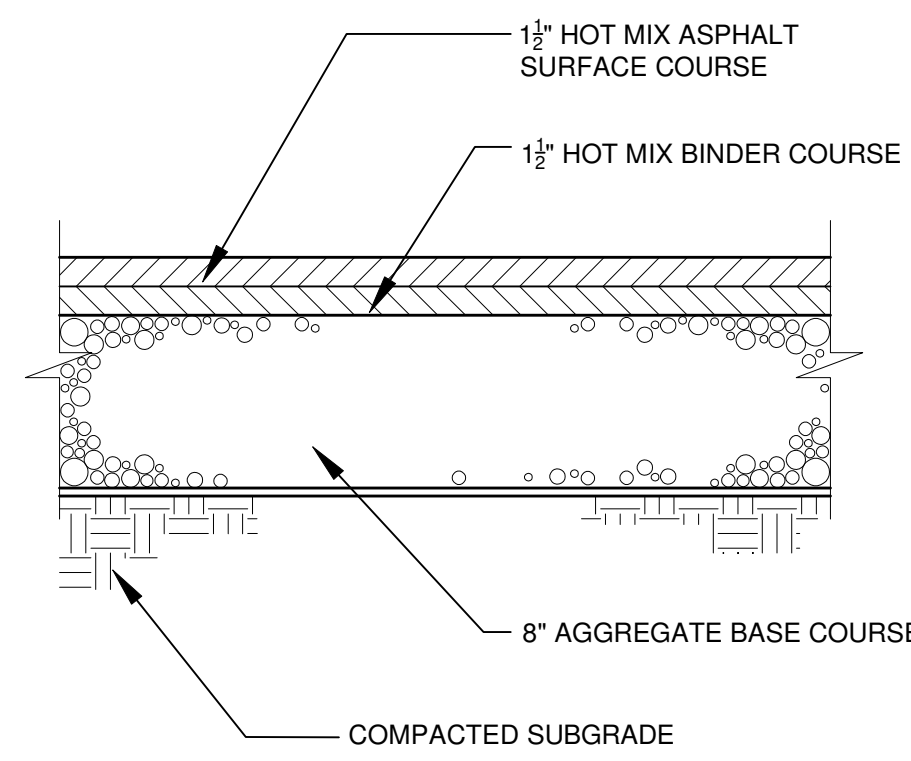

2 HOT MIX ASPHALT PAVEMENT SECTION FOR PARKING LOT NTS

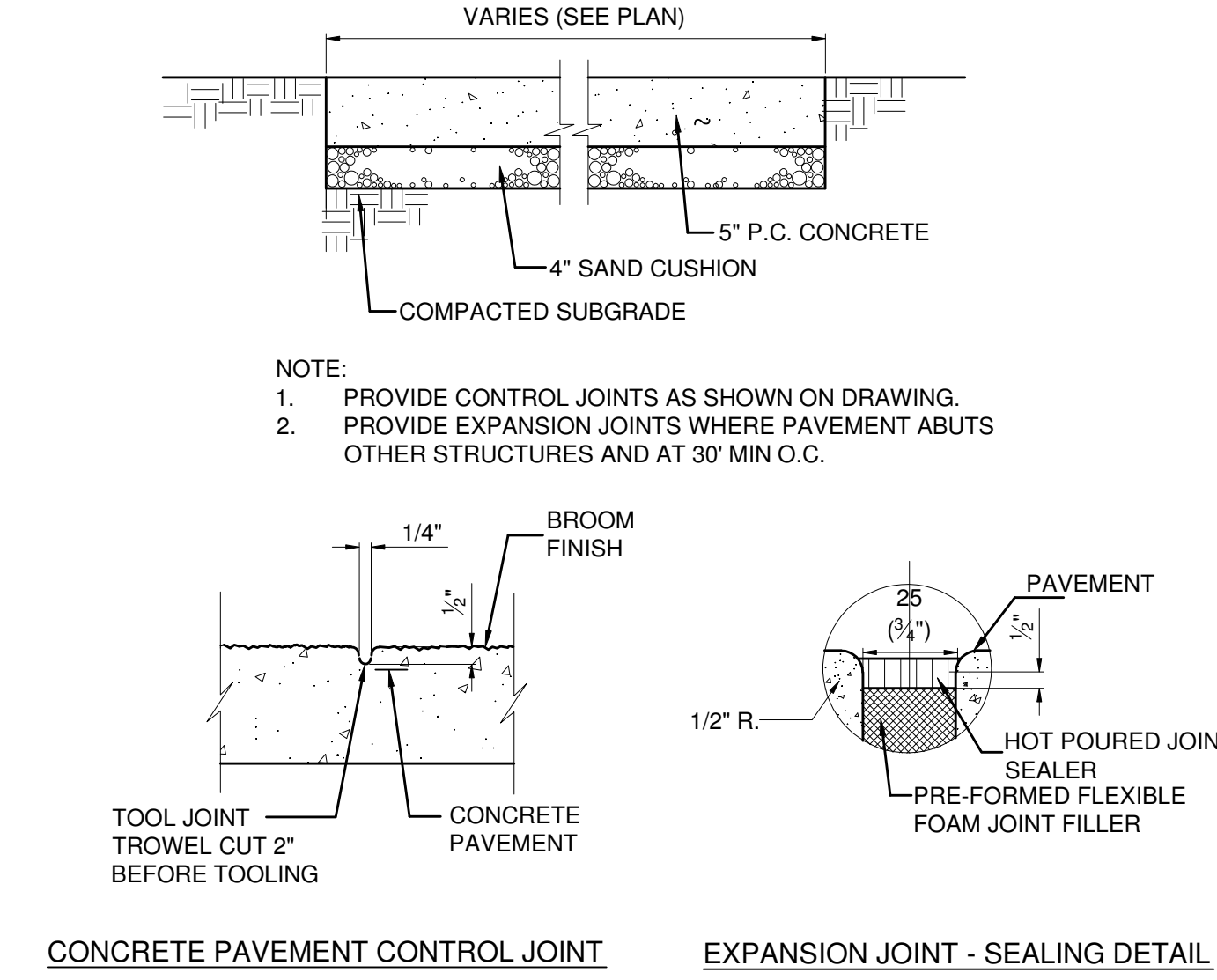

3 CONCRETE SIDEWALK DETAIL NTS

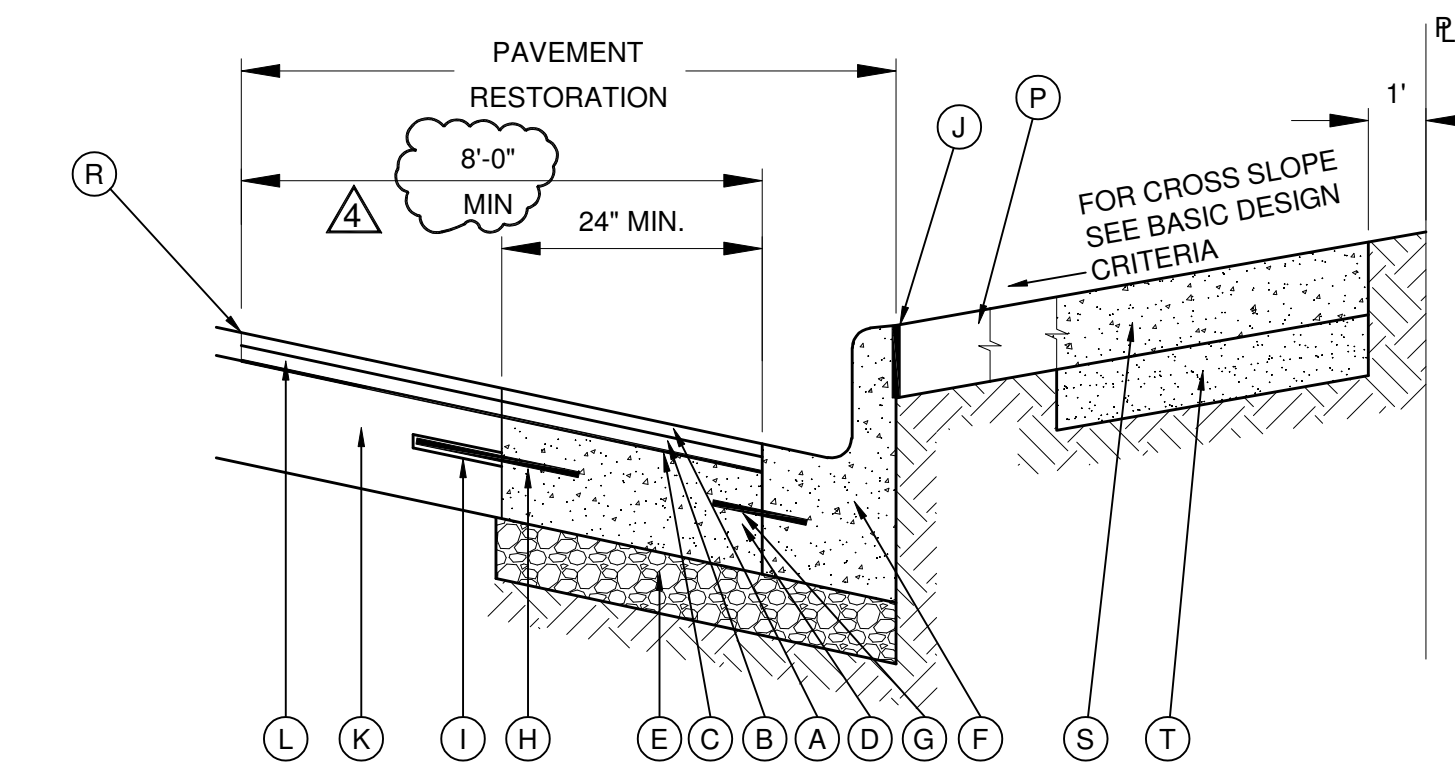

4 PAVEMENT RECONSTRUCTION ADJACENT TO NEW DEVELOPMENT NTS

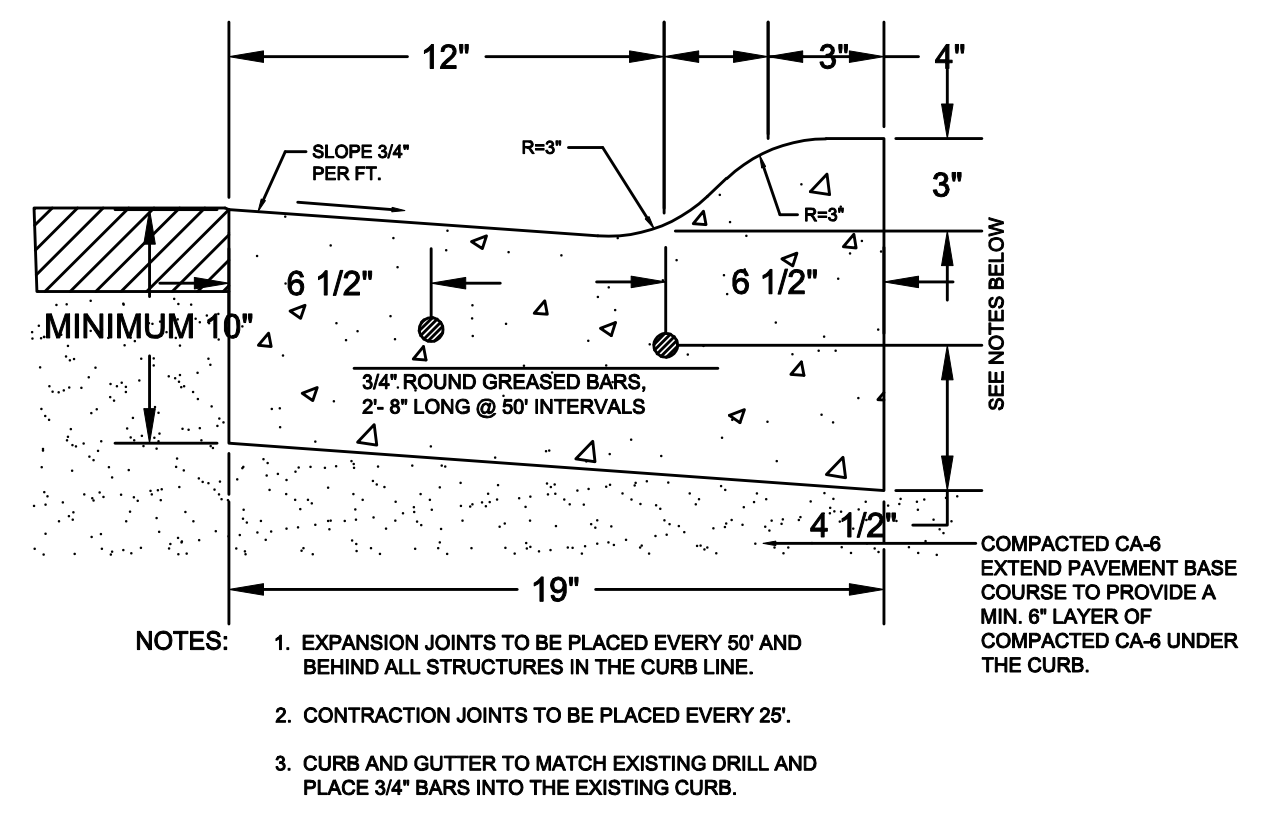

5 MOUNTABLE CURB DETAIL NTS

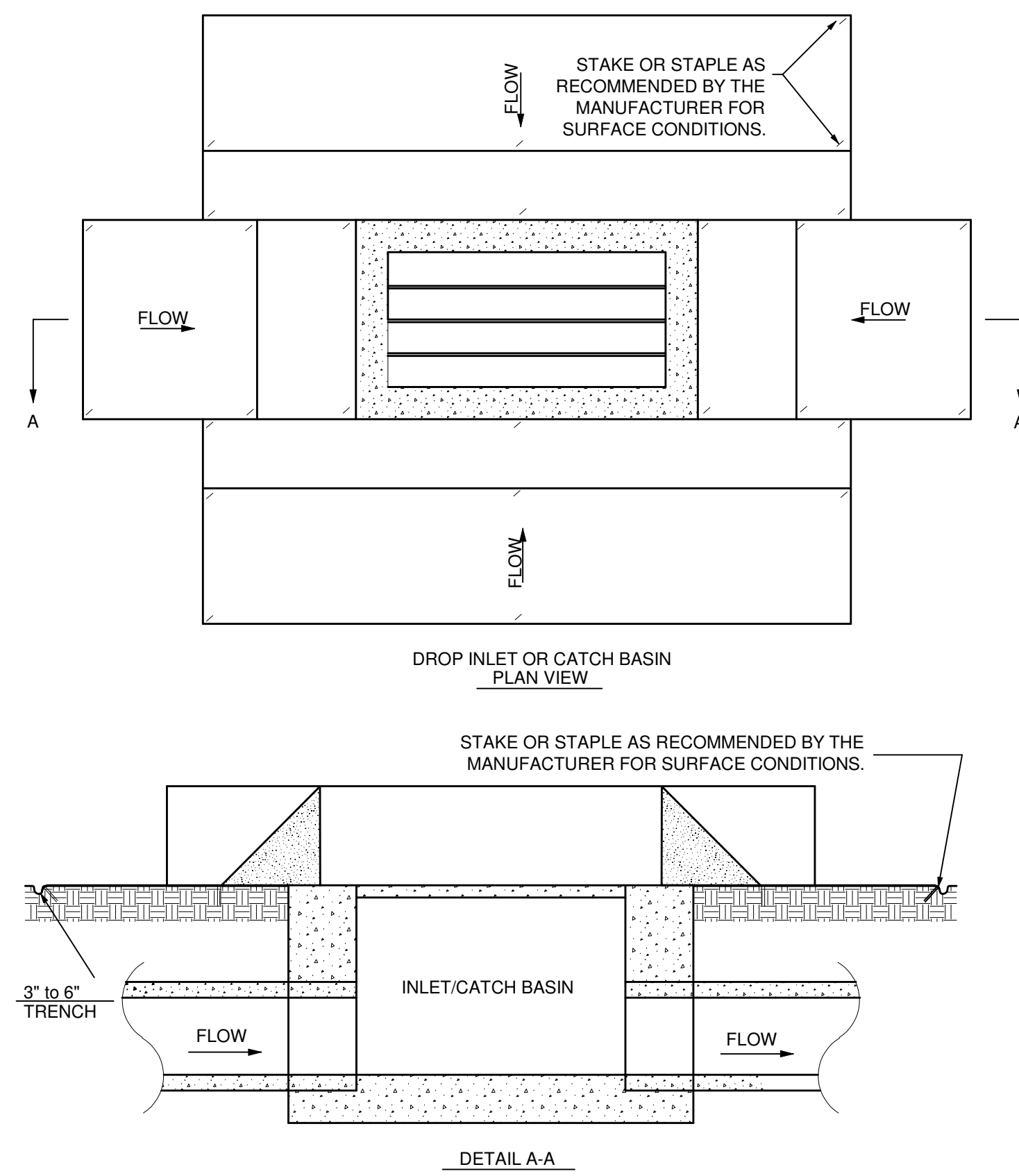

6 SILT DIKE DETAIL NTS

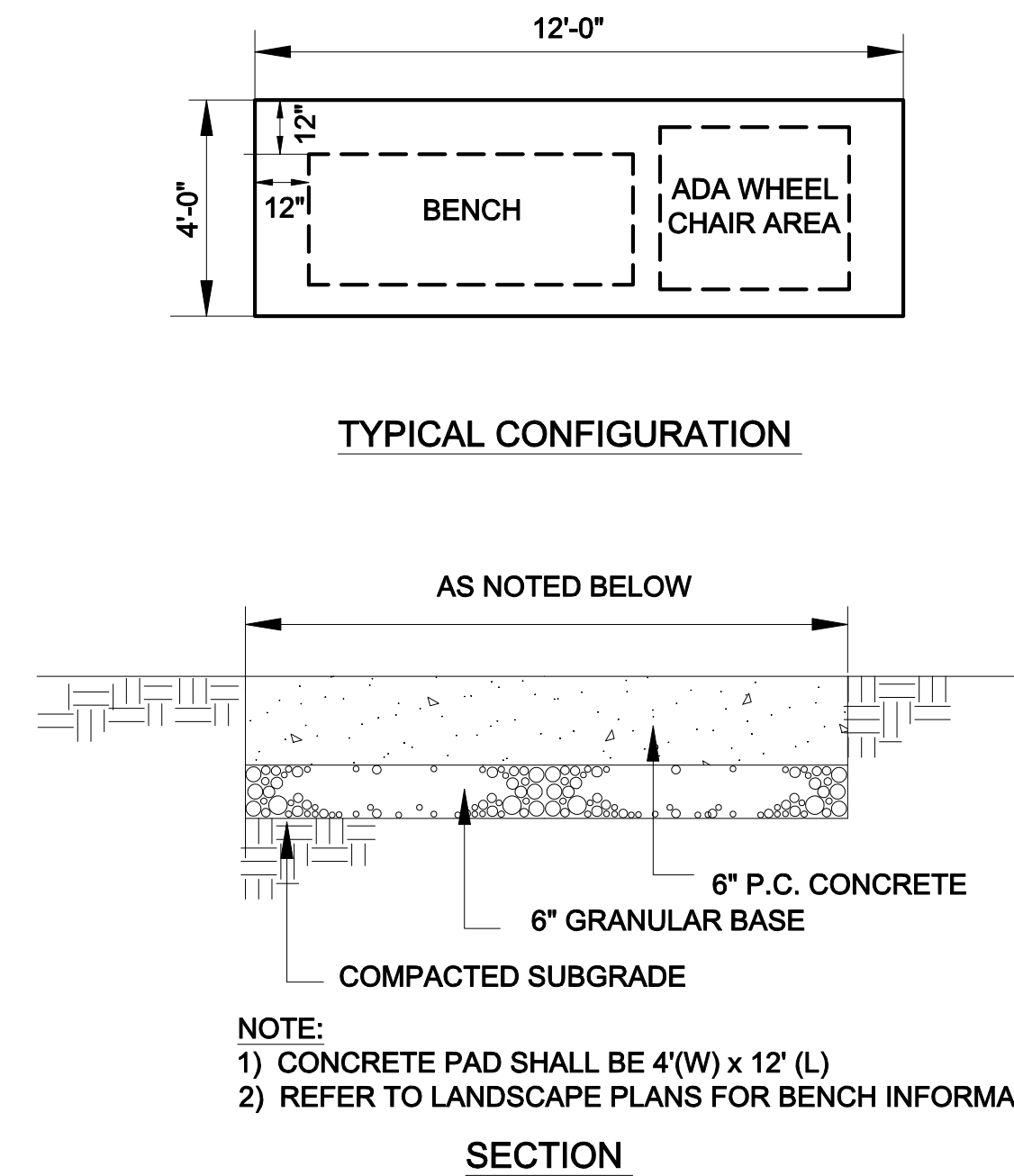

7 BENCH PAD DETAIL NTS

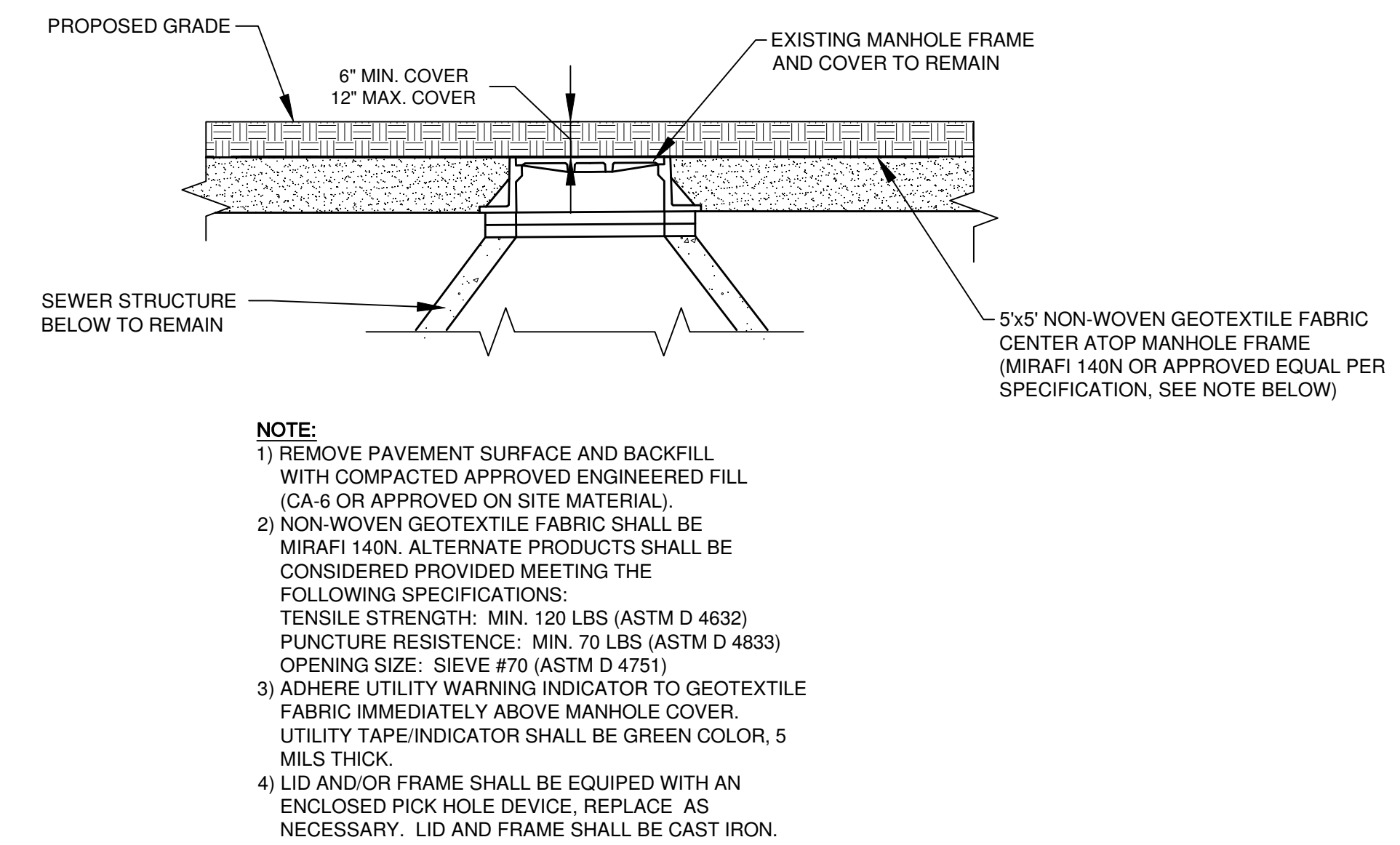

8 BURIED MANHOLE DETAIL NTS

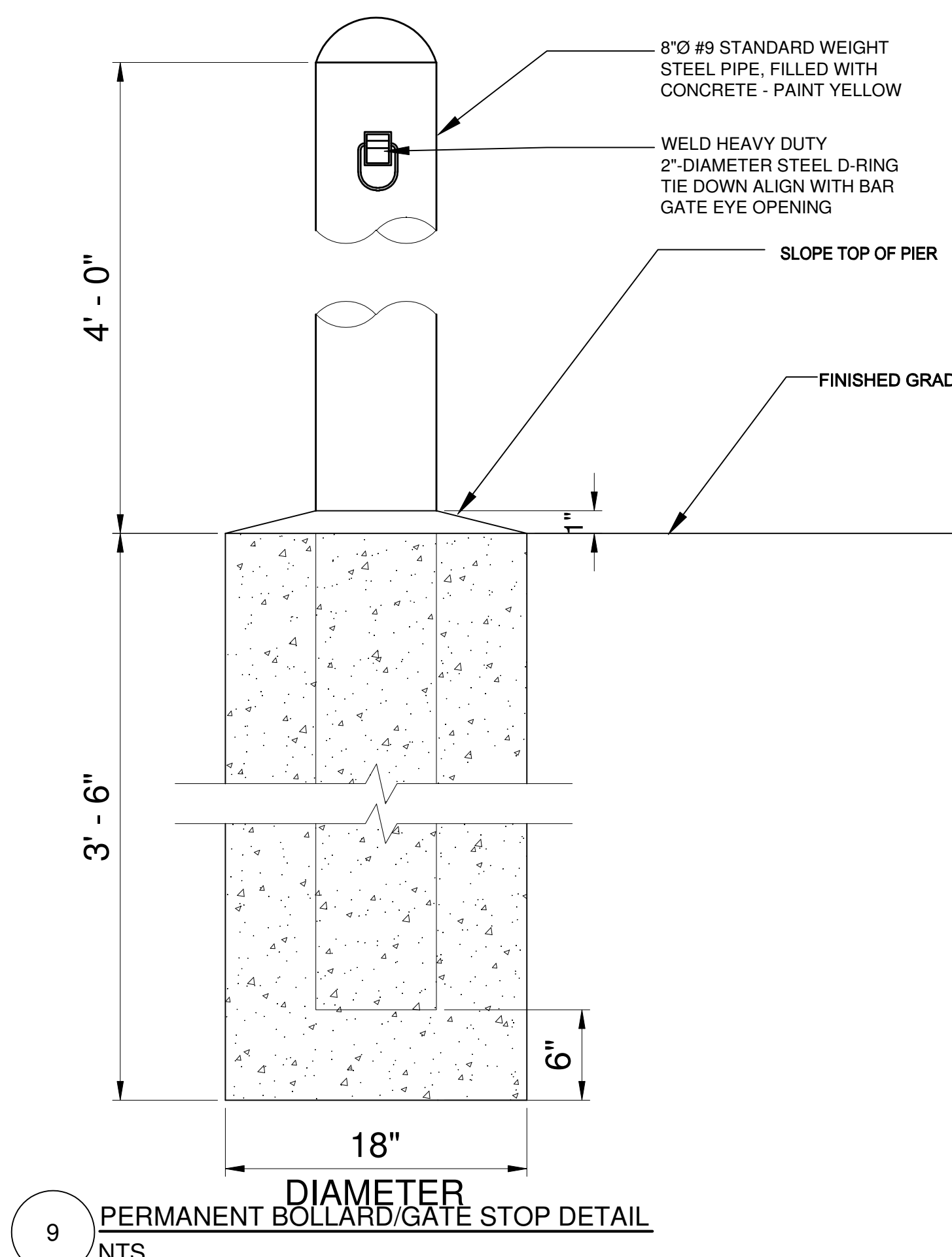

9 PERMANENT BOLLARD/GATE STOP DETAIL NTS

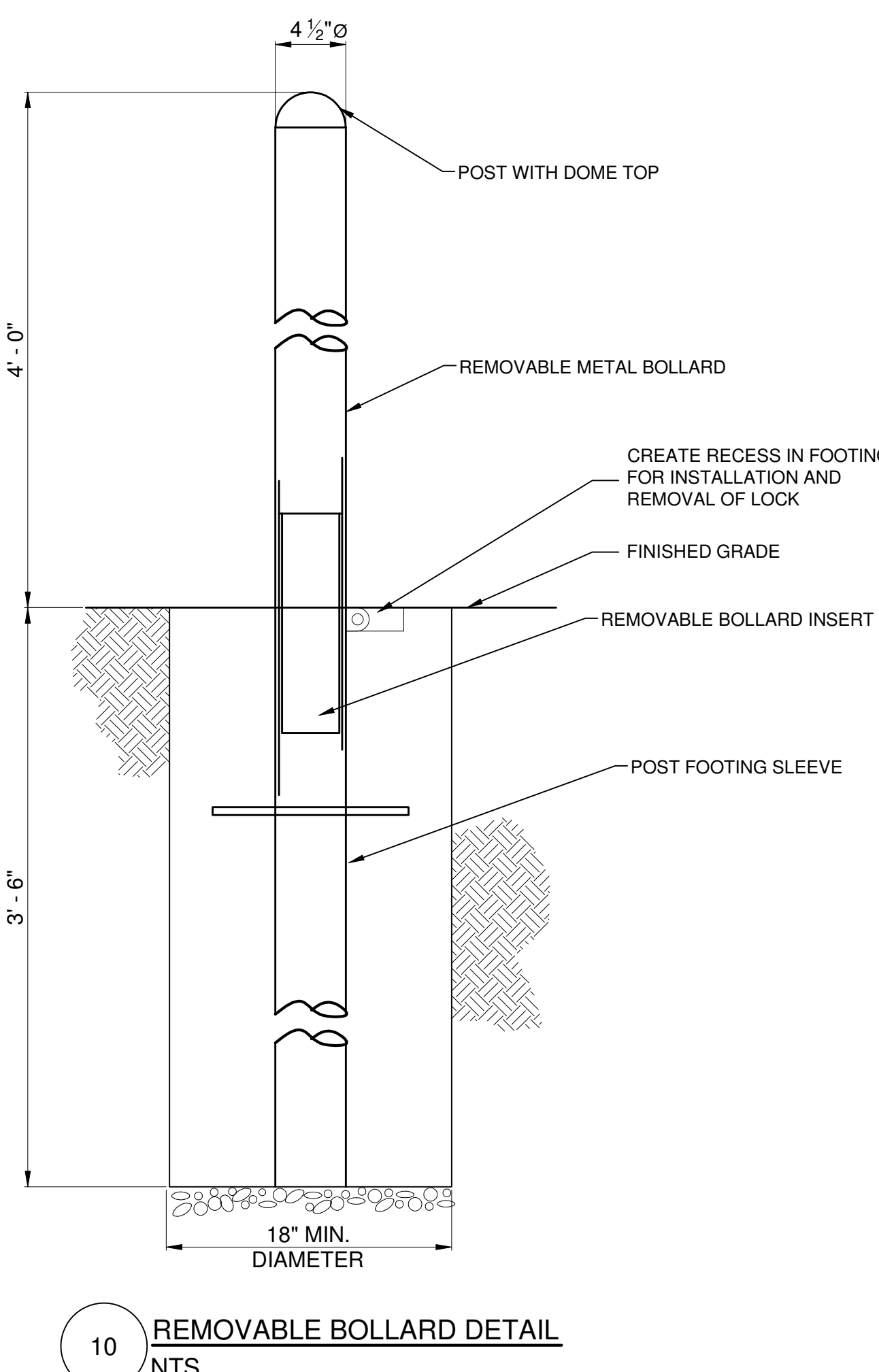

10 REMOVABLE BOLLARD DETAIL NTS

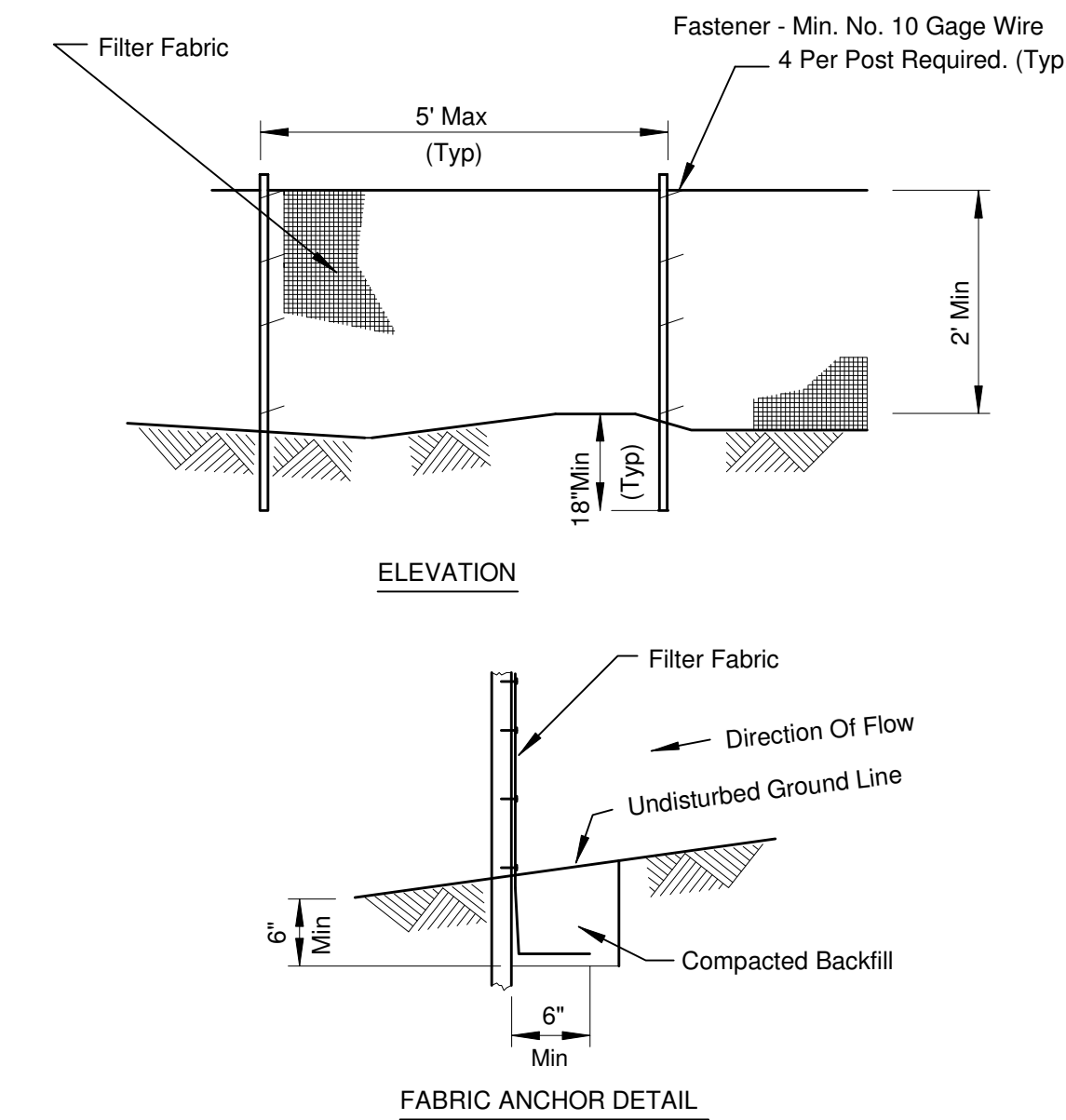

11 SILT FENCE DETAIL NTS

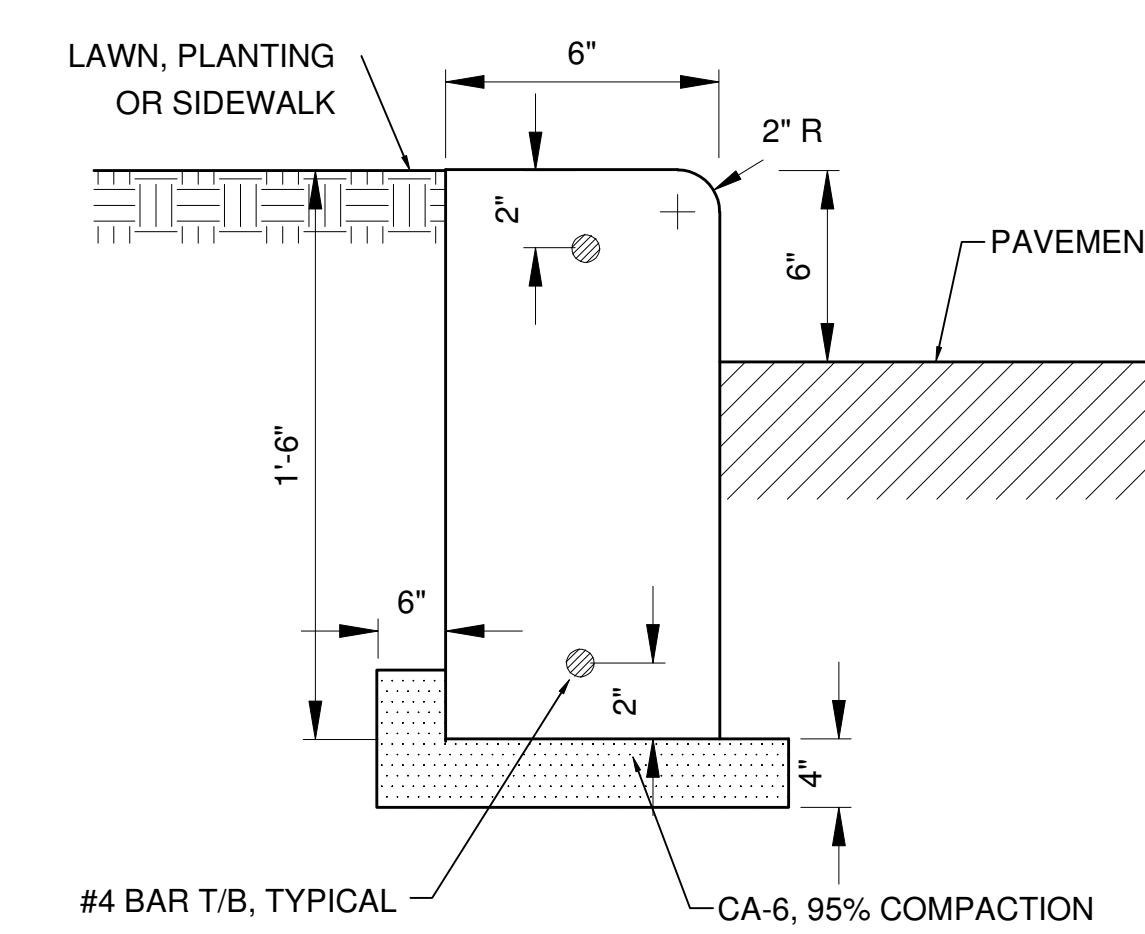

12 BARRIER CURB DETAIL NTS

Mark	Description	Date
1	BID SET	01.28.10
2	REVISED PER PBC REVIEW	02.02.10
3	ISSUE FOR BID	02.10.10
4	ADDENDUM 1	02.26.10

PBC Project Name: Marshall Campus Park  
 PBC Contract No.: 1507  
 PBC Project No.: 02030  
 Terra Project No.: 09-180  
 Title



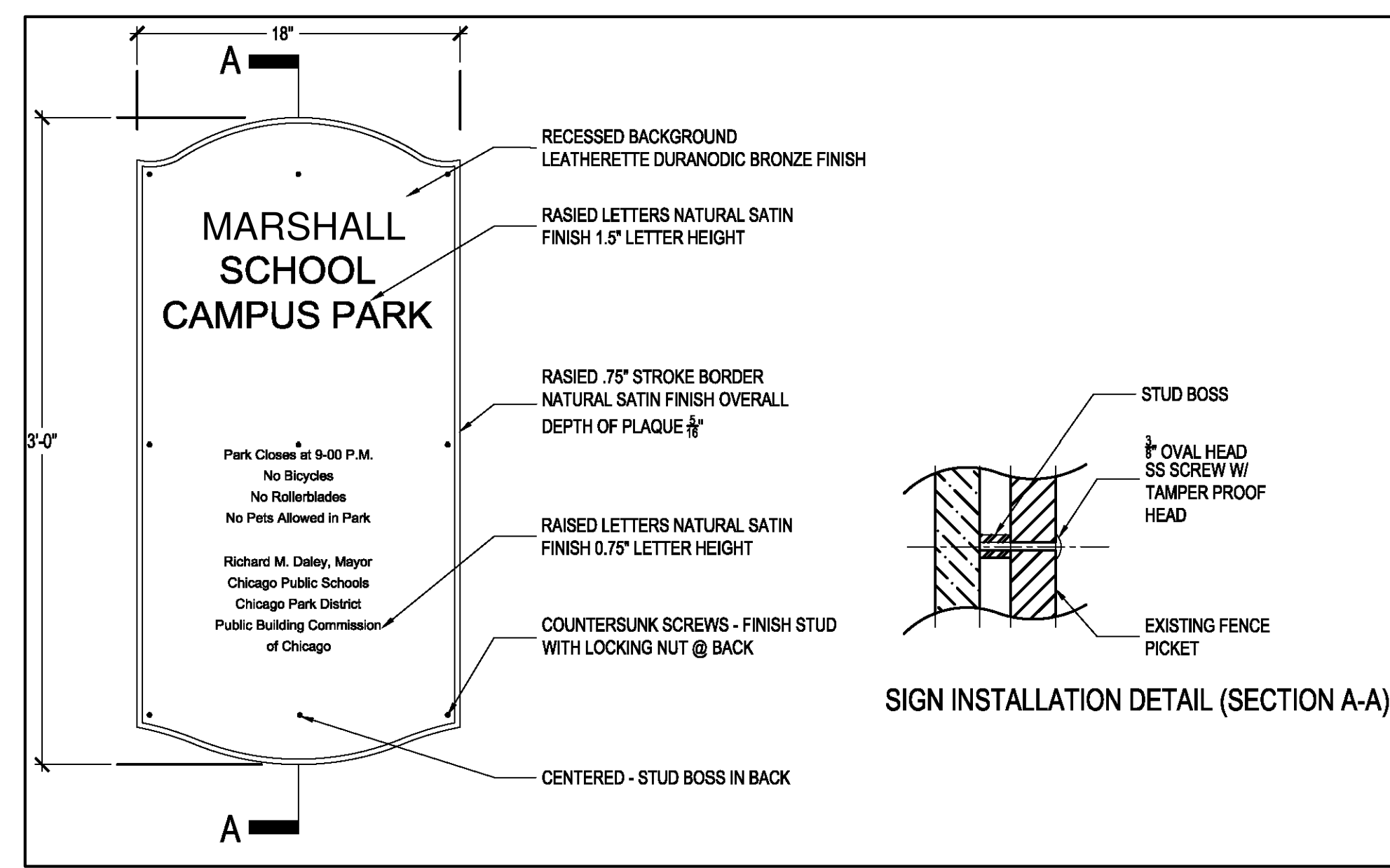

13 CAMPUS PARK SIGNAGE  
NTS

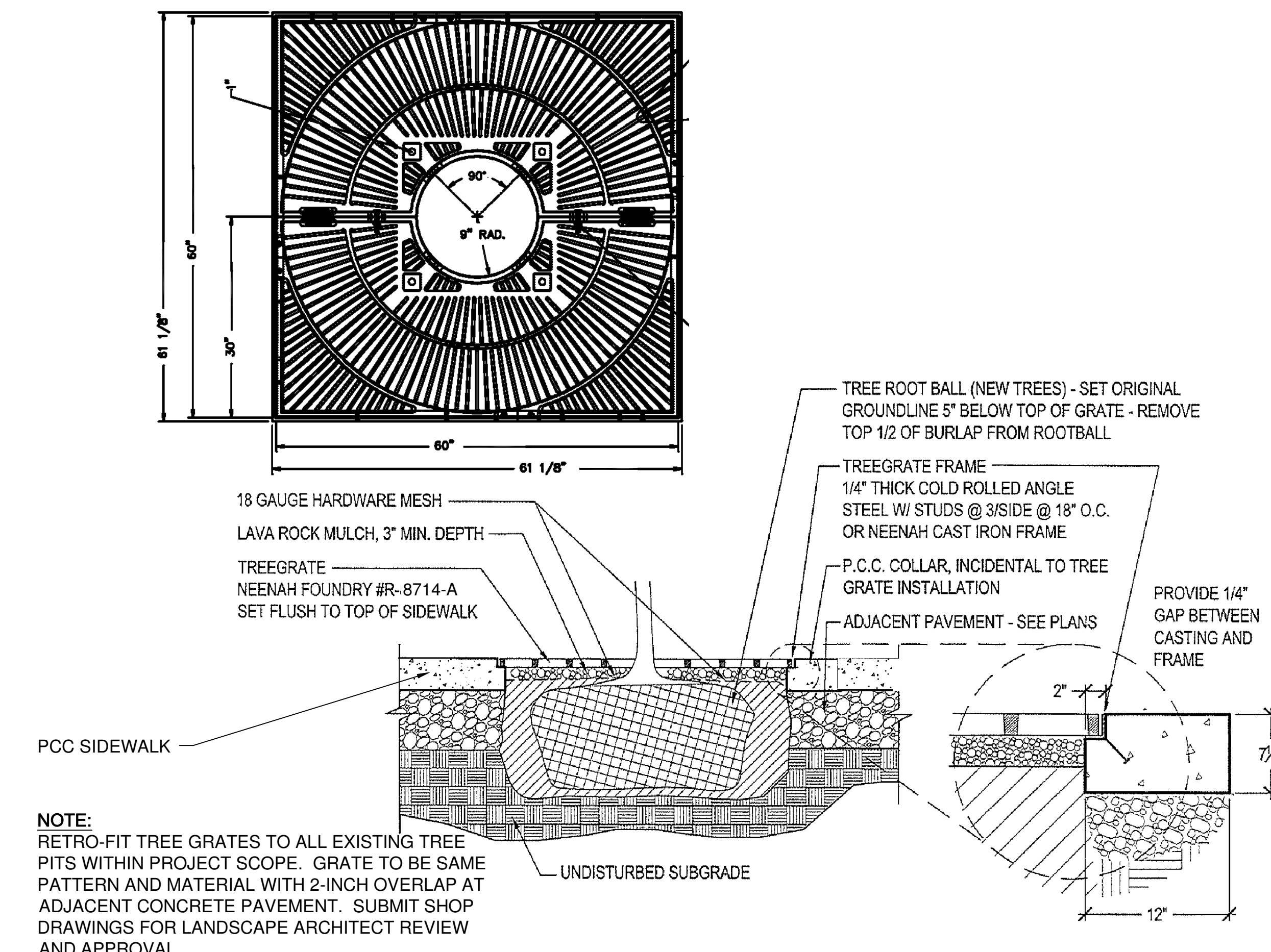

14 TREE GRATE DETAIL  
NTS

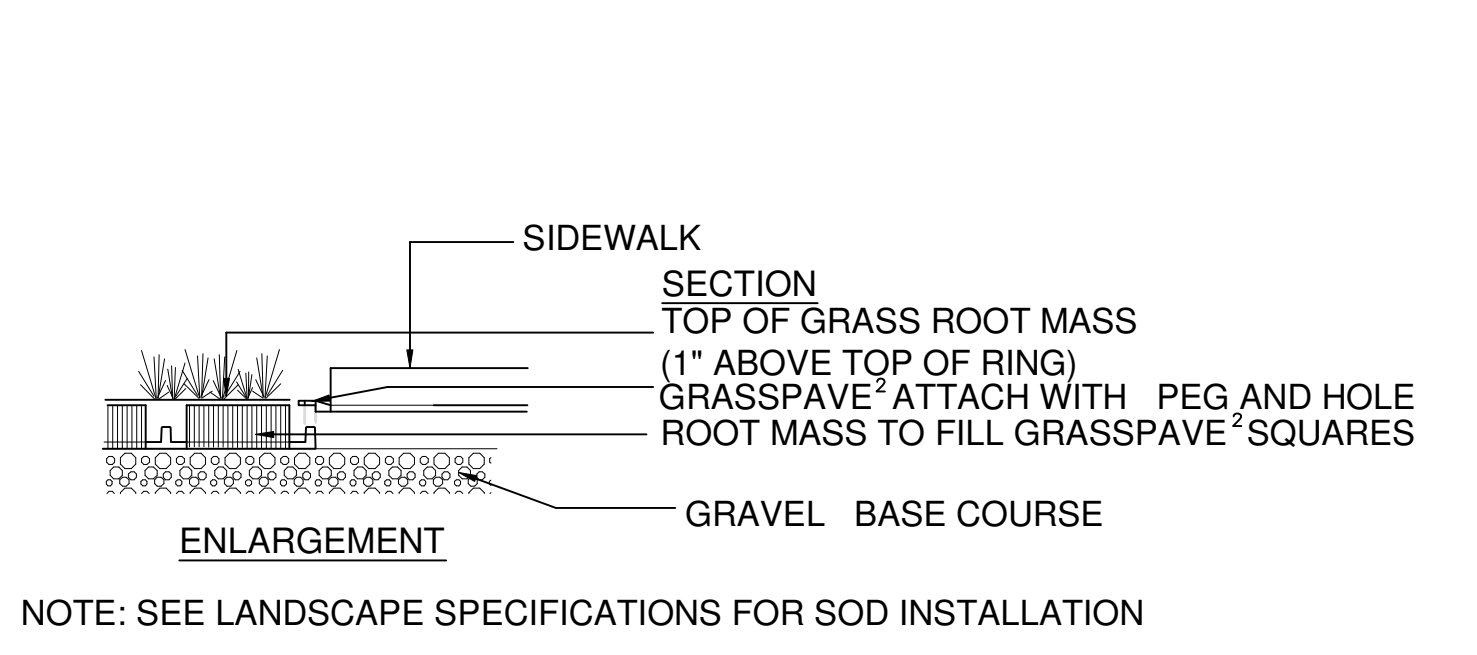

15 SOFTBALL AREA BENCH  
NTS

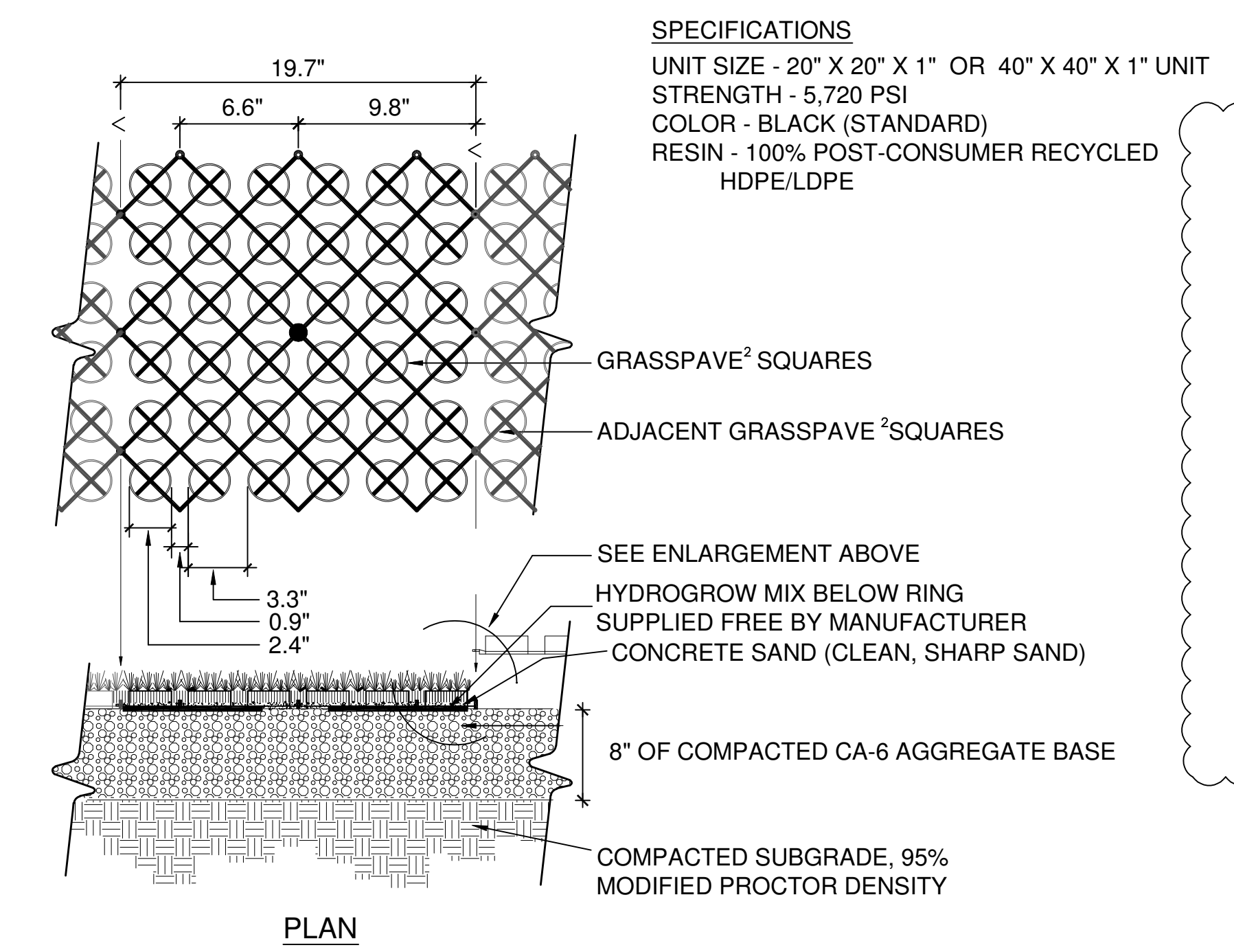

16 GRASS PAVE  
NTS

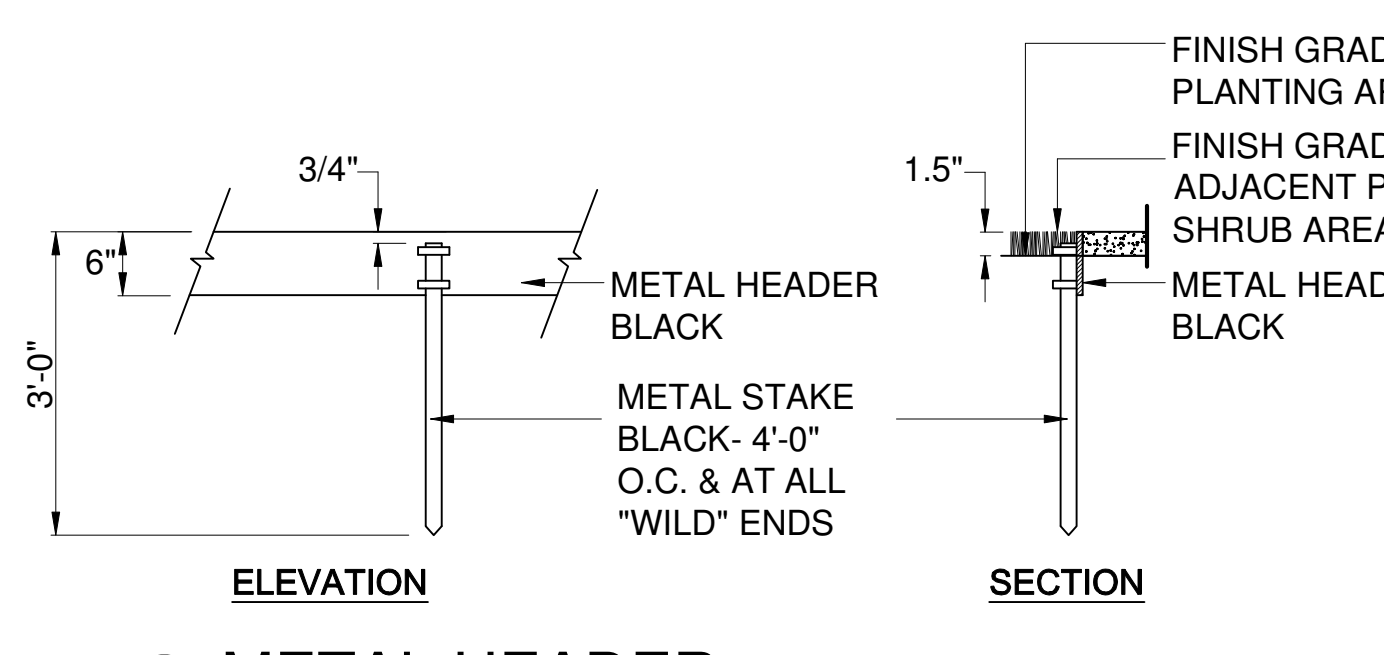

17 METAL HEADER  
NTS

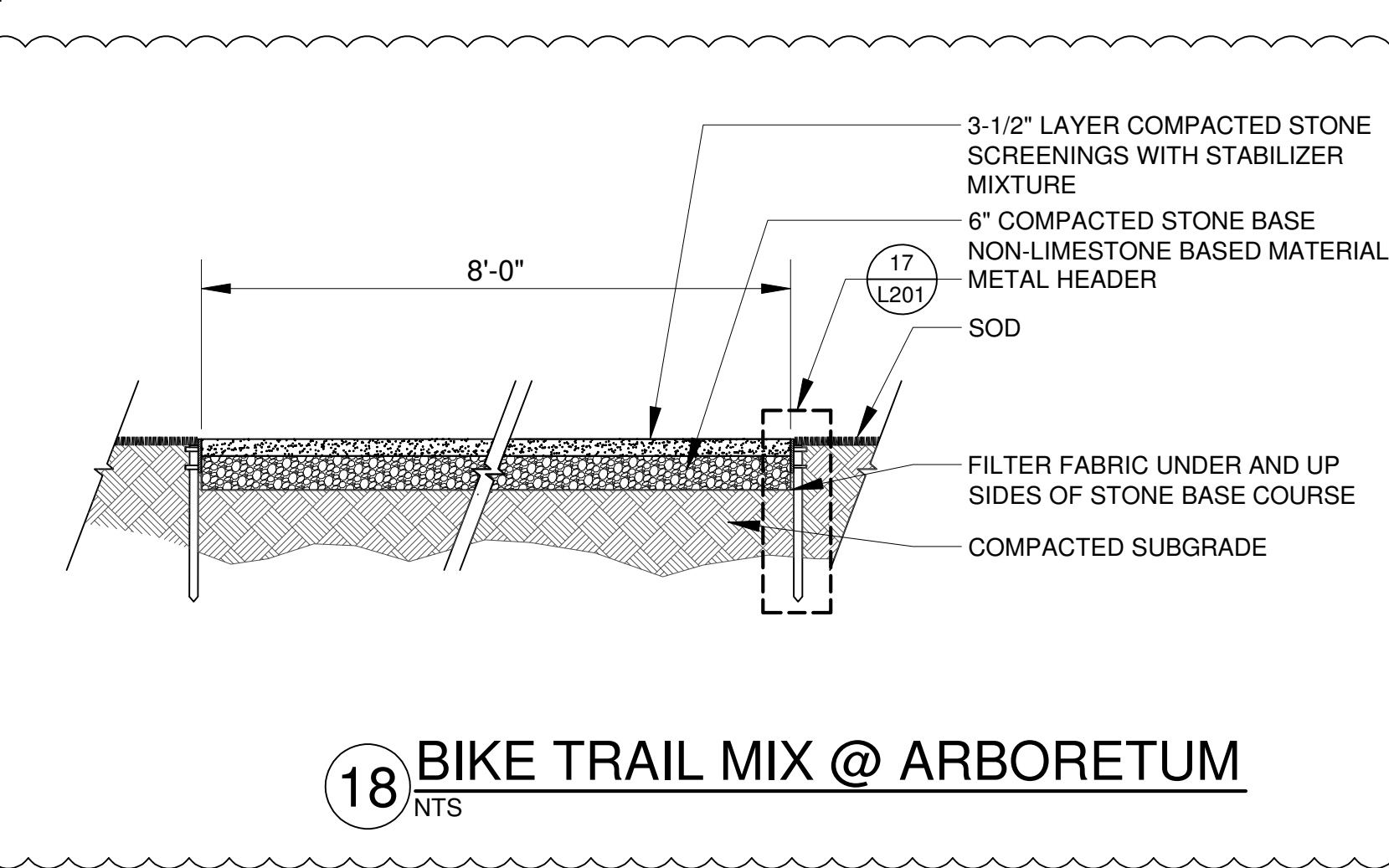

18 BIKE TRAIL MIX @ ARBORETUM  
NTS

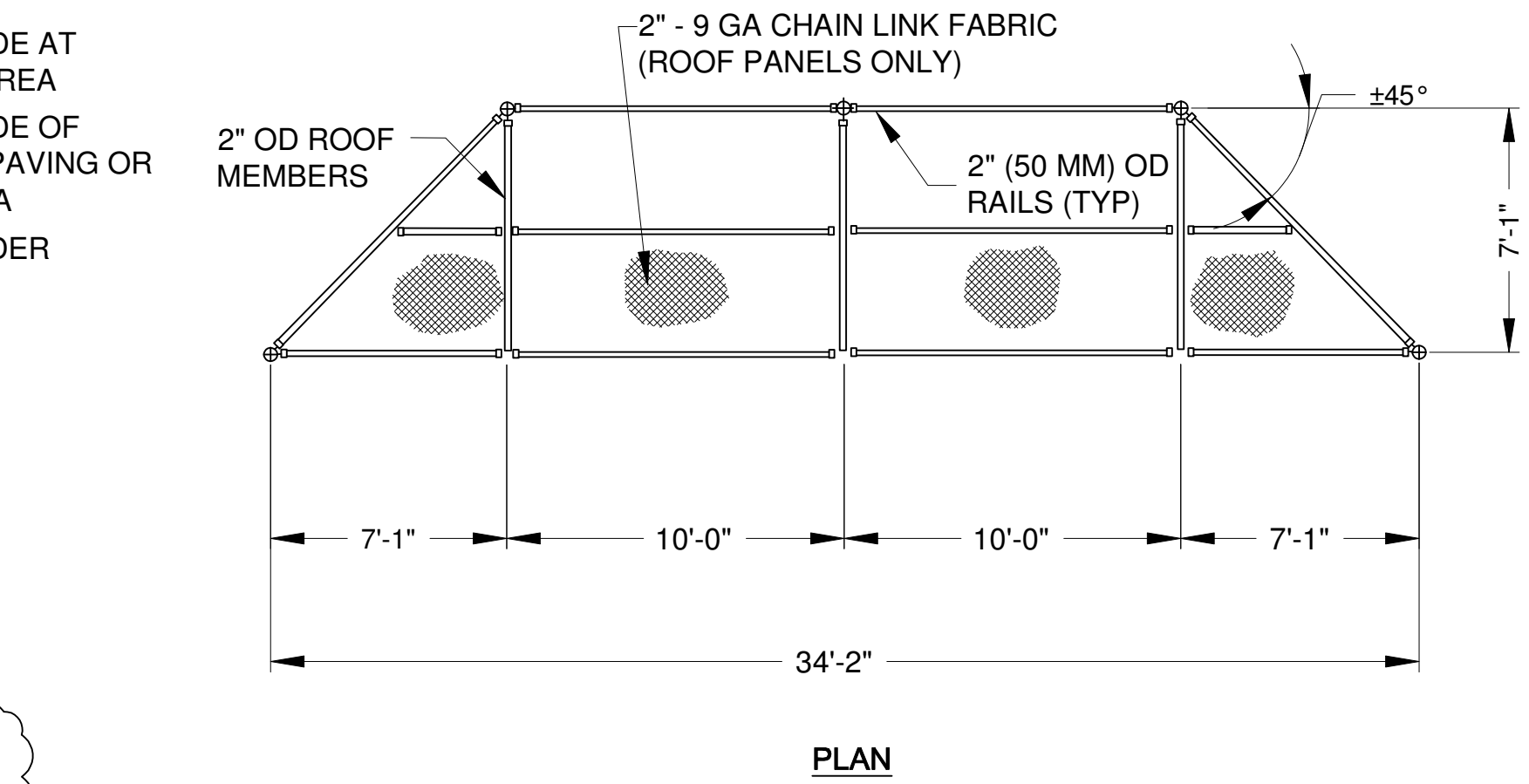

19 FOOTBALL GOAL POST DETAIL  
NTS

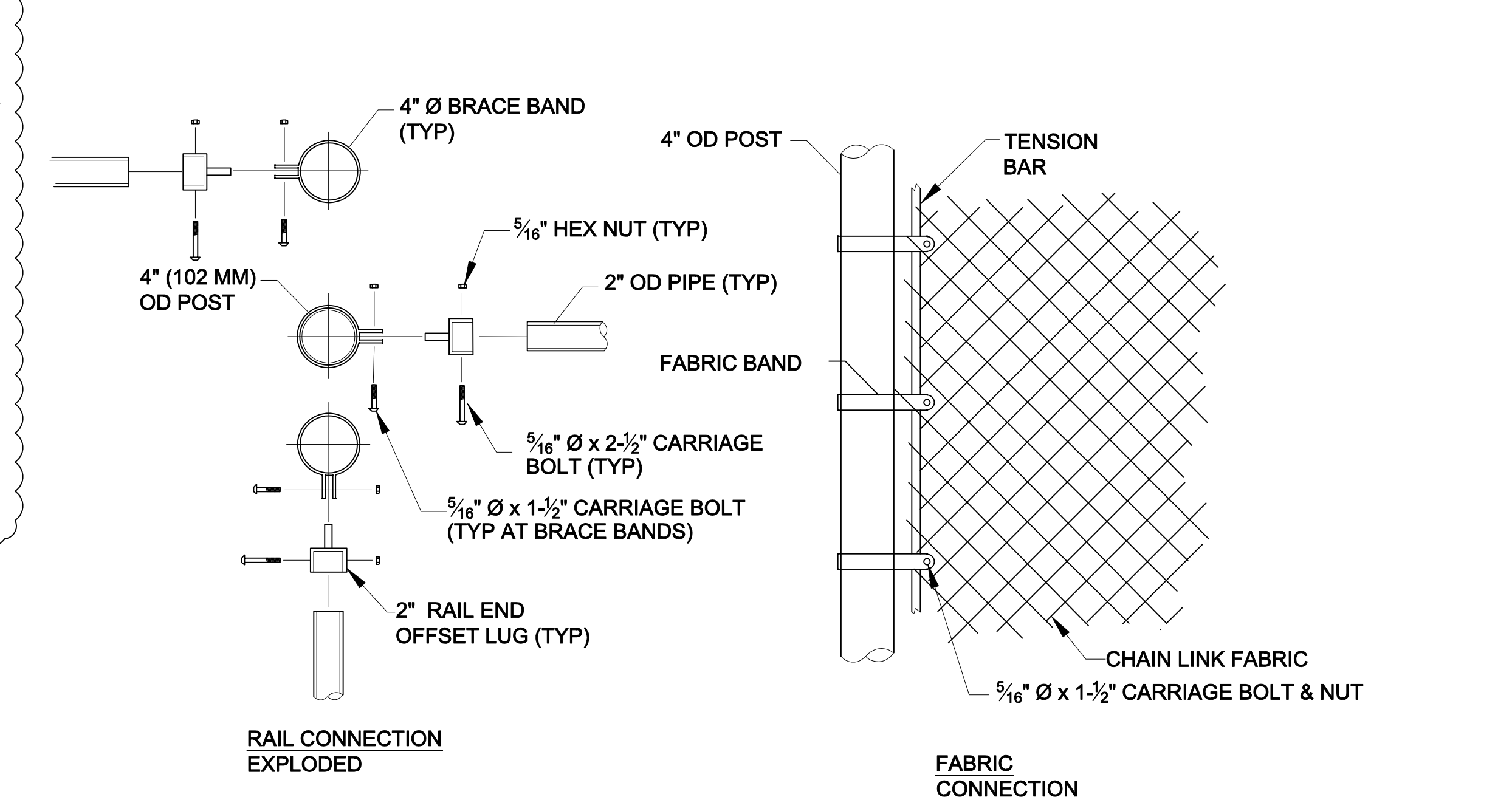

20 SOFTBALL BACKSTOP DETAIL  
NTS

PLANT SCHEDULE

QUANT.	KEY	BOTANICAL NAME	COMMON NAME	SIZE	REMARKS
<b>SHADE TREES</b>					
4	A*	AESCULUS FLAVA (A. OCTANDRA)	YELLOW BUCKEYE	4" CAL.	MATCHING 7' CLEAR TO FIRST BRANCHING FROM ROOT BALL
5	AM	ACER MARMO	MARMO MAPLE	4" CAL.	MATCHING 7' CLEAR TO FIRST BRANCHING FROM ROOT BALL
5	AS	ACER SACCHARUM "GREEN MOUNTAIN"	GREEN MOUNTAIN SUGAR MAPLE	4" CAL.	MATCHING 7' CLEAR TO FIRST BRANCHING FROM ROOT BALL
8	CO	CELTIS OCCIDENTALIS	COMMON HACKBERRY	4" CAL.	MATCHING 7' CLEAR TO FIRST BRANCHING FROM ROOT BALL
8	GB	GINKGO BILIBO "MAGYAR"	MAGYAR GINKGO	4" CAL.	MATCHING 7' CLEAR TO FIRST BRANCHING FROM ROOT BALL
9	GD	GYMNOCLADUS DIOICA	KENTUCKY COFFEE TREE	4" CAL.	MATCHING 7' CLEAR TO FIRST BRANCHING FROM ROOT BALL
11	GT	GLEDITSIA TRIANCANTOS VAR. INERMIS	SKYLINE HONEYLOCUST	4" CAL.	MATCHING 7' CLEAR TO FIRST BRANCHING FROM ROOT BALL
5	QM	QUERCUS MACROCARPA	BUR OAK	4" CAL.	MATCHING 7' CLEAR TO FIRST BRANCHING FROM ROOT BALL
7	QR	QUERCUS RUBA	NORTHERN RED OAK	4" CAL.	MATCHING 7' CLEAR TO FIRST BRANCHING FROM ROOT BALL
8	TC	TILIA CORDATA LITTLELEAF LINDEN	LITTLELEAF LINDEN	4" CAL.	MATCHING 7' CLEAR TO FIRST BRANCHING FROM ROOT BALL
<b>ORNAMENTAL TREES</b>					
3	AC	AMELANCHIER CANADENSIS PRINCE WILLIAM	SHADBLOW SERVICEBERRY "PRINCE WILLIAM"	4" HT	MULTISTEM 6 MIN
1	CC	CERCIS CANADENSIS	REDBUD	5" HT	MULTISTEM 6 MIN
16	CRC	CRATAEGUS CRUS-GALLI VAR. INERMIS	THORNTLESS COCKSPUR HAWTHORN	8" HT	MULTISTEM 4 MIN
9	MP	MALUS PRAIRIFIRE	PRAIRIFIRE CRABAPPLE	3" CAL 6' HT	SINGLE TRUNK
7	MR	MALUS RED JEWEL	RED JEWEL CRABAPPLE	3" CAL 8' HT	SINGLE TRUNK
4	MS	MALUS SARGENTII	SARGENT CRAB	5" HT	MULTISTEM 4 MIN
6	PC	PYRUS CALLERYANA CHANTICLEER	CHANTICLEER PEAR	3" CAL 10' HT	TREE FORM
18	SY	SYRINGA PEKINENSIS	PEKING LILAC "MORTON"	3" CAL 6' HT	SINGLE TRUNK
<b>CONIFEROUS TREES</b>					
2	PIA	PICEA ABIES	NORWAY SPRUCE	7" HT	TIGHT BRANCHES SYMMETRICAL
11	PN	PINUS NIGRA	AUSTRIAN PINE	7" HT	TIGHT BRANCHES SYMMETRICAL
12	PS	PINUS STROBUS	WHITE PINE	7" HT	TIGHT BRANCHES SYMMETRICAL
<b>SHRUBS</b>					
EA	EUNYMIUS ALATA COMPACTA	DWARF BURNING BUSH	3' HT 24" WIDE	FULLY BRANCHED (HEAVY) MULTI STEM AT BASE 30" O.C.	
JCP	JUNIPERUS CHINESIS PFITZERIANA KALLAY	COMPACT KALLAY JUNIPER	36" HT 30" WIDE	36" O.C. SYMMETRICAL HEAVY BRANCHED	
SJ	SPIRAEA JAPONICA NEON FLASH	NEON FLASH SPIREA	8" HT 2" WIDE	2" O.C.	
9	RIA	RIBES ALPIMUM	ALPINE CURRANT	30" HT 24" WIDE	SYMMETRICAL HEAVY BRANCHED 24" O.C.
TM	TAXUS X MEDIA "TAUNTON"	TAUNTON YEW	30" HT 24" WIDE	SYMMETRICAL HEAVY BRANCHED 30" O.C.	
44	VT	VIBURNUM TRILOBUM "HAHS"	HAHS AMERICAN CRANBERRY BUSH	36" HT 30" WIDE	SYMMETRICAL HEAVY BRANCHED 30" O.C.
SP	SYRINGA PATULA "MISS KIM"	MISS KIM LILAC	24" HT 24" WIDE	SYMMETRICAL HEAVY BRANCHED 30" O.C.	
16	TE	TAXUS X MEDIA EVERLOW	EVERLOW JAPANESE YEW	24" SPREAD	SYMMETRICAL HEAVY BRANCHED 30" O.C.
<b>PERENNIALS AND GROUNDCOVERS</b>					
72	EF	EUNYMIUS FORTUNEI COLORATUS	PURPLE LEAF WINTERCREEPER	24" FLAT	12" O.C.
LS	LIRIOPE SPICATA	CREEPING LILY-TURF	#1 POT 8" FLAT	10" O.C.	
PA	PENNISETUM ALOPECUROIDES HAMELIN	HAMELIN DWARF FOUNTAIN GRASS	2 GAL	18" O.C.	

IN THE EVENT OF DISCREPANCY IN PLANT QUANTITY BETWEEN PLAN AND PLANT SCHEDULE, LARGER QUANTITY TO BE PROVIDED AND INSTALLED. \*ALL PLANT MATERIAL SHALL BE SPECIMEN QUALITY \*ALL PLANT MATERIALS SHALL BE B & B \*LANDSCAPE ARCHITECT SHALL SELECT (TAG) ALL PLANT MATERIALS AT LOCAL NURSERIES \*SHRUBS ON A SINGLE STEM WILL NOT BE PERMITTED. ALL SHRUBS SHALL BE MULTI STEM, AND HEAVILY BRANCHED, SYMMETRICAL.

Mark	Description	Date
1	BID SET	01.28.10
2	REVISED PER PBC REVIEW	02.02.10
3	ISSUE FOR BID	02.10.10
4	ADDENDUM 1	02.26.10



Mark	Description	Date
1	BID SET	01.28.10
2	REVISED PER PBC REVIEW	02.02.10
3	ISSUED FOR BID	02.10.10
4	ADDENDUM 1	02.26.10

PBC Project Name: Marshall Campus Park  
PBC Contract No.: PS-866  
Terra Project No.: 08-180

**ELECTRICAL SITE LIGHTING PLAN**

Sheet

ES.1

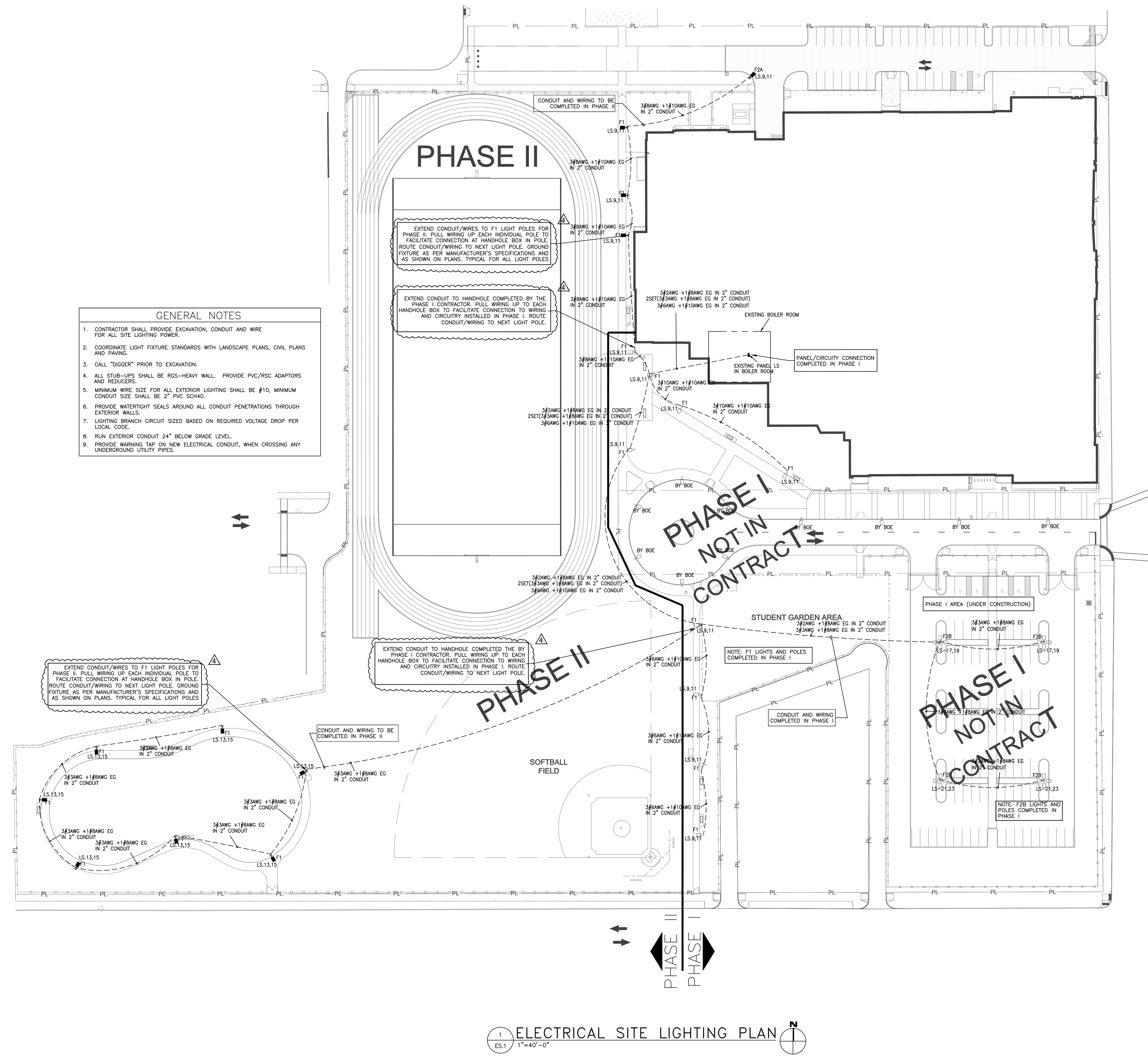

- GENERAL NOTES**
- CONTRACTOR SHALL PROVIDE EXCAVATION, CONDUIT AND WIRE FOR ALL SITE LIGHTING POINTS.
  - COORDINATE LIGHT FIXTURE STANDARDS WITH LANDSCAPE PLANS, CIVIL PLANS AND PAVING.
  - CALL "DIGGER" PRIOR TO EXCAVATION.
  - ALL STUB-UPS SHALL BE RGS-HEAVY WALL. PROVIDE PVC/RSC ADAPTORS AND REDUCERS.
  - MINIMUM WIRE SIZE FOR ALL EXTERIOR LIGHTING SHALL BE #10, MINIMUM CONDUIT SIZE SHALL BE 2" PVC SCH40.
  - PROVIDE WATER-TIGHT SEALS AROUND ALL CONDUIT PENETRATIONS THROUGH EXTERIOR WALLS.
  - LIGHTING BRANCH CIRCUIT SIZED BASED ON REQUIRED VOLTAGE DROP PER LOCAL CODE.
  - RUN EXTERIOR CONDUIT 24" BELOW GRADE LEVEL.
  - PROVIDE WARNING TAP ON NEW ELECTRICAL CONDUIT, WHEN CROSSING ANY UNDERGROUND UTILITY PIPES.

1 ELECTRICAL SITE LIGHTING PLAN  
ES.1 1"=40'-0"