

11. CONSTRUCTION FENCE SHALL TO BE MAINTAINED PER DETAIL #12/C4.1 AND THEN REMOVED IN FULL, INCLUSIVE OF POSTS AND FOUNDATIONS, UPON CONSTRUCTION COMPLETION.

13. AS-BUILT DRAWINGS MUST BE SUBMITTED TO THE CDWM FOLLOWING THE CONSTRUCTION OF THIS DEVELOPMENT, WITHIN 30 DAYS OF SUBSTANTIONAL COMPLETION. SIGNIFICANT PENALTIES (FINES) CAN BE ASSESSED FOR FAILURE TO COMPLY WITH THESE REQUIREMENTS. AS-BUILT DRAWINGS MUST INCLUDE INFORMATION ON THE FOLLOWING DRAWINGS AS A MINIMUM: DIMENSION PLAN, GRADING PLAN, UTILITY PLAN, SEWER DETAILS, AND STORMWATER BMP DETAILS. THE AS-BUILTS SHALL BE GENERATED BY A LICENSED SURVEYOR. THE AS-BUILT PLANS MUST BE SIGNED AND SEALED BY THE ENGINEER OF RECORD WHO PREPARED THE DESIGN PLANS PRIOR TO SUBMISSION TO CDWM. UPON A/E REVIEW AND APPROVAL OF THE AS-BUILT DRAWINGS, THE CONTRACTOR SHALL SUBMIT AS-BUILT DRAWINGS ON A COMPACT DISC (CD) IN ELECTRONIC \*.TIF FORMAT TO :

DEPARTMENT OF BUILDINGS  
 STORMWATER REVIEW  
 CITY HALL, ROOM 906  
 121 NORTH LASALLE STREET  
 CHICAGO, ILLINOIS 60602

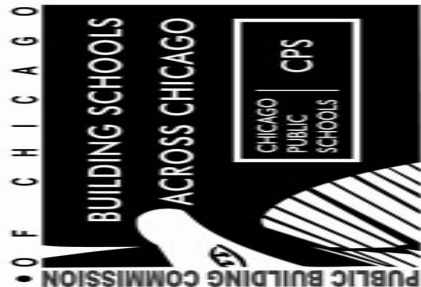

Brighton Park II,  
 Elementary School  
 CHICAGO PUBLIC SCHOOLS

CITY OF CHICAGO  
 MAYOR RICHARD M. DALEY

2611 West 48th Street  
 CHICAGO, IL 60632



Architrave, Ltd.  
 1128 W. Chicago Ave.  
 2nd Floor  
 Chicago, Illinois 60642  
 (312) 642-2600

CIVIL ENG. &  
 LANDSCAPE ARCH:  
 Terra Engineering Ltd.  
 225 W/ Ohio St. #400.  
 Chicago, Illinois

STRUCTURAL ENGINEER:  
 McDonough Assoc., Inc.  
 130 E Randolph St # 1000  
 Chicago, IL

M, E, P & FP ENG.:  
 Globetrotters  
 300 S Wacker Dr # 400  
 Chicago, IL

THEATRE CONSULTANT:  
 Schuler Shook  
 750 N Orleans St # 400  
 Chicago, IL

KITCHEN CONSULTANT:  
 Edge Consultants, Inc.  
 220 E Lake Street  
 Addison, IL

Date	October 8, 2010
Comm. No.	1335
Scale	N/A
Drawn	DP
Checked	DK
Proj. Arch.	

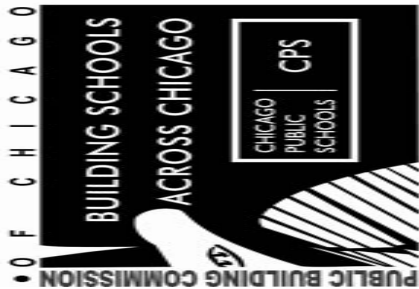
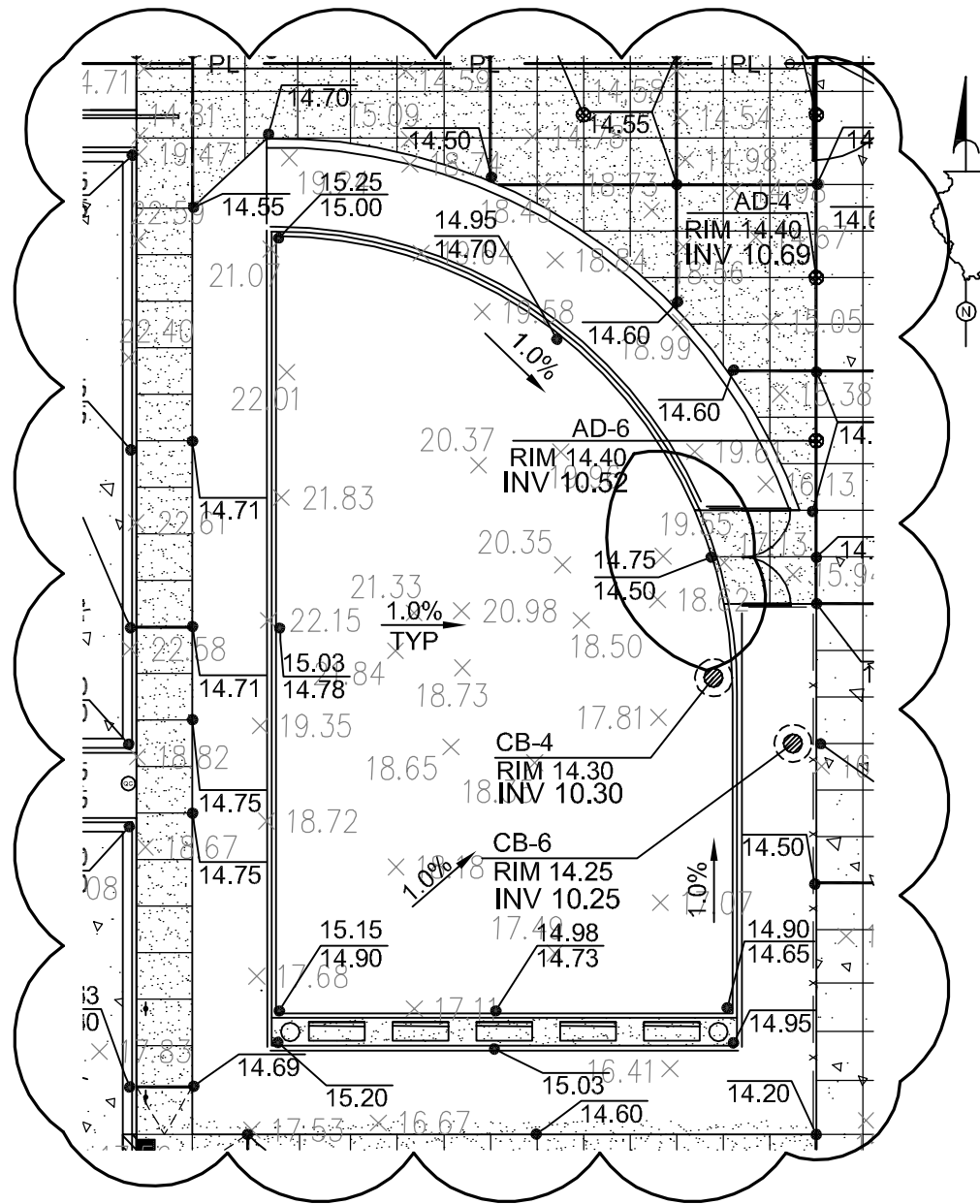

**Brighton Park II,  
Elementary School  
CHICAGO PUBLIC SCHOOLS**

CITY OF CHICAGO  
MAYOR RICHARD M. DALEY

2611 West 48th Street  
CHICAGO, IL 60632



Architrave, Ltd.  
1128 W. Chicago Ave.  
2nd Floor  
Chicago, Illinois 60642  
(312) 642-2600

CIVIL ENG. &  
LANDSCAPE ARCH:  
Terra Engineering Ltd.  
225 W/ Ohio St. #400.  
Chicago, Illinois

STRUCTURAL ENGINEER:  
McDonough Assoc., Inc.  
130 E Randolph St # 1000  
Chicago, IL

M, E, P & FP ENG.:  
Globetrotters  
300 S Wacker Dr # 400  
Chicago, IL

THEATRE CONSULTANT:  
Schuler Shook  
750 N Orleans St # 400  
Chicago, IL

KITCHEN CONSULTANT:  
Edge Consultants, Inc.  
220 E Lake Street  
Addison, IL

Date	October 8, 2010
Comm. No.	1335
Scale	1:20
Drawn	DP
Checked	DK
Proj. Arch.	

**CSK - 2**

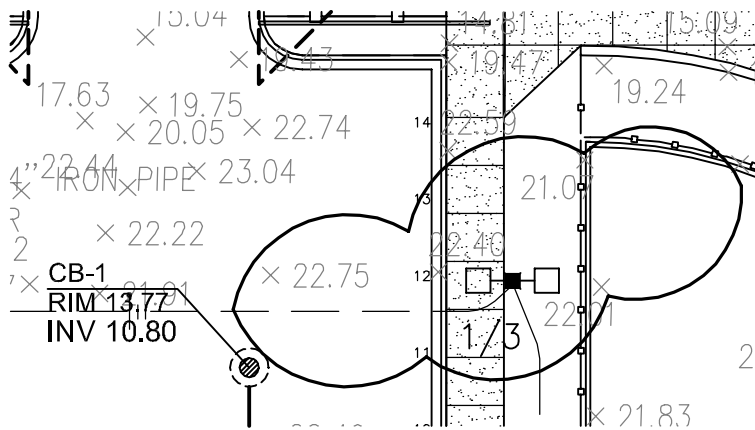

## 1. NW OF PLAY LOT

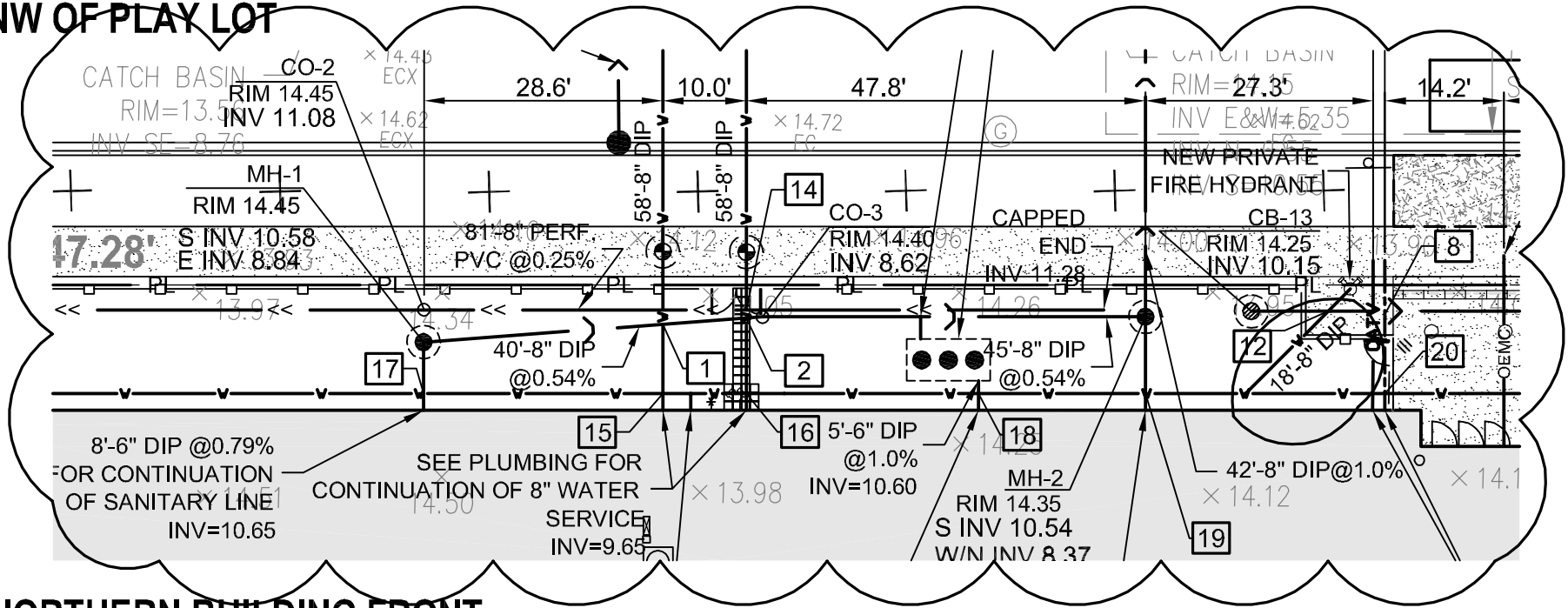

## 2. NORTHERN BUILDING FRONT

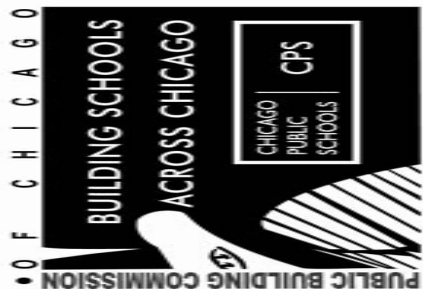

Brighton Park II,  
Elementary School  
CHICAGO PUBLIC SCHOOLS  
CITY OF CHICAGO  
MAYOR RICHARD M. DALEY  
  
2611 West 48th Street  
CHICAGO, IL 60632

**ARCHITRAVE**  
  
Architrave, Ltd.  
1128 W. Chicago Ave.  
2nd Floor  
Chicago, Illinois 60642  
(312) 642-2600

CIVIL ENG. &  
LANDSCAPE ARCH:  
Terra Engineering Ltd.  
225 W/ Ohio St. #400.  
Chicago, Illinois

STRUCTURAL ENGINEER:  
McDonough Assoc., Inc.  
130 E Randolph St # 1000  
Chicago, IL

M, E, P & FP ENG.:  
Globetrotters  
300 S Wacker Dr # 400  
Chicago, IL

THEATRE CONSULTANT:  
Schuler Shook  
750 N Orleans St # 400  
Chicago, IL

KITCHEN CONSULTANT:  
Edge Consultants, Inc.  
220 E Lake Street  
Addison, IL

Date	October 8, 2010
Comm. No.	1335
Scale	1:20
Drawn	DP
Checked	DK
Proj. Arch.	

**CSK - 3**

BRIGHTON PARK II						
ELEVATION TABLES FOR UTILITY CROSSINGS						
*P=Proposed X= Existing						
Tag #	Use of Pipe	Type of Pipe	Size	Top Elev.	Bottom Elev.	Separation (Feet)
1	P. WATER	DIP	8"	10.32	9.65	0.30
	P. SANITARY	DIP	8"	9.35	8.68	
2	P. WATER	DIP	8"	10.32	9.65	0.35
	P. SANITARY	DIP	8"	9.30	8.63	
3	P. WATER	K-COPPER	1"	10.40	10.32	0.57
	P. ELEC	DUCK BANK	21"	9.75	8.00	
4	P. STORM	ESVCP	10"	10.94	10.11	0.36
	P. ELEC	DUCK BANK	21"	9.75	8.00	
5	P. WATER	K-COPPER	1"	11.40	11.32	0.94
	P. STORM	ESVCP	10"	10.38	9.55	
6	P. WATER	K-COPPER	1"	11.70	11.62	1.65
	P. STORM	ESVCP	8"	9.97	9.30	
7	P. ELEC	DUCK BANK	11.5"	11.11	10.15	0.86
	P. STORM	ESVCP	10"	9.29	8.46	
8	P. STORM	ESVCP	6"	10.62	10.12	0.49
	P. ELEC	DUCK BANK	10.5"	9.63	8.75	
9	P. WATER	DIP	8"	10.32	9.65	3.43
	XSEWER	ESVCP	12"	6.22	5.22	
10	P. WATER	DIP	8"	10.32	9.65	3.40
	XSEWER	ESVCP	12"	6.25	5.25	
11	P. SEWER	PERF. PVC	8"	11.39	10.72	1.40
	P. WATER	DIP	8"	9.32	8.65	
12	P. SEWER	DIP	6"	10.58	10.08	0.76
	P. WATER	DIP	8"	9.32	8.65	
13	P. WATER	DIP	8"	10.32	9.65	0.59
	P. SEWER	DIP	8"	9.06	8.39	
14	P. SEWER	PERF. PVC	8"	11.84	11.17	0.86
	P. WATER	DIP	8"	10.32	9.65	
15	P. WATER	DIP	8"	10.32	9.65	0.33
	P. WATER	DIP	8"	9.32	8.65	
16	P. WATER	DIP	8"	10.32	9.65	0.33
	P. WATER	DIP	8"	9.32	8.65	
17	P. SEWER	DIP	6"	11.13	10.63	1.31
	P. WATER	DIP	8"	9.32	8.65	
18	P. SEWER	DIP	6"	11.13	10.63	1.31
	P. WATER	DIP	8"	9.32	8.65	
19	P. SEWER	DIP	6"	11.13	10.63	1.31
	P. WATER	DIP	8"	9.32	8.65	
20	P. WATER	DIP	8"	10.65	10.15	0.53
	P. ELEC	DUCK BANK	10.5"	9.63	8.75	

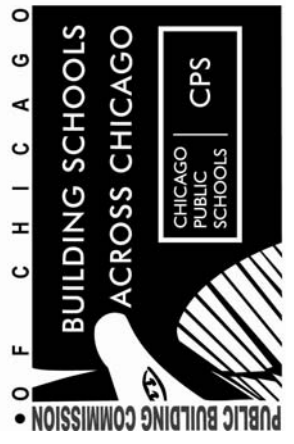

Brighton Park II,  
Elementary School  
CHICAGO PUBLIC SCHOOLS  
CITY OF CHICAGO  
MAYOR RICHARD M. DALEY

2611 West 48th Street  
CHICAGO, IL 60632



Architrave, Ltd.  
1128 W. Chicago Ave.  
2nd Floor  
Chicago, Illinois 60642  
(312) 642-2600

CIVIL ENG. & LANDSCAPE ARCH  
Terra Engineering Ltd.  
225 W/ Ohio St. #400.  
Chicago, Illinois

STRUCTURAL ENGINEER:  
McDonough Assoc., Inc.  
130 E Randolph St # 1000  
Chicago, IL

M, E, P & FP ENG.:  
Globetrotters  
300 S Wacker Dr # 400  
Chicago, IL

THEATRE CONSULTANT:  
Schuler Shook  
750 N Orleans St # 400  
Chicago, IL

KITCHEN CONSULTANT:  
Edge Consultants, Inc.  
220 E Lake Street  
Addison, IL

Date	October 8, 2010
Comm. No.	1335
Scale	N/A
Drawn	DP
Checked	DK
Proj. Arch.	

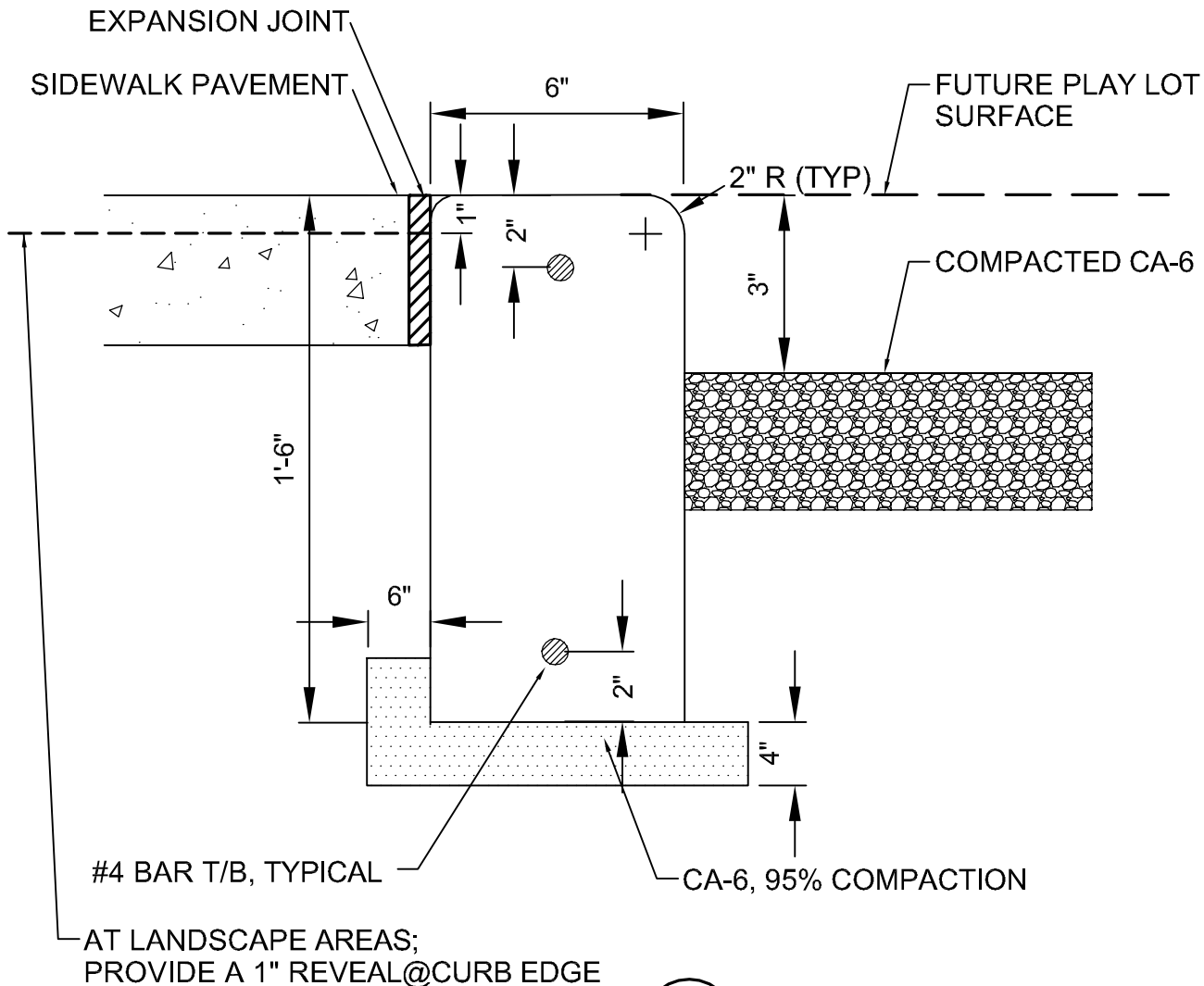

**7** CONCRETE BARRIER CURB  
NTS

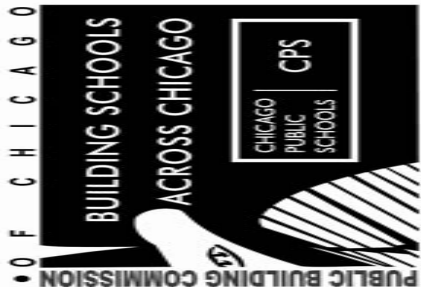

Brighton Park II,  
Elementary School  
CHICAGO PUBLIC SCHOOLS

CITY OF CHICAGO  
MAYOR RICHARD M. DALEY

2611 West 48th Street  
CHICAGO, IL 60632



Architrave, Ltd.  
1128 W. Chicago Ave.  
2nd Floor  
Chicago, Illinois 60642  
(312) 642-2600

CIVIL ENG. &  
LANDSCAPE ARCH:  
Terra Engineering Ltd.  
225 W/ Ohio St. #400.  
Chicago, Illinois

STRUCTURAL ENGINEER:  
McDonough Assoc., Inc.  
130 E Randolph St # 1000  
Chicago, IL

M, E, P & FP ENG.:  
Globetrotters  
300 S Wacker Dr # 400  
Chicago, IL

THEATRE CONSULTANT:  
Schuler Shook  
750 N Orleans St # 400  
Chicago, IL

KITCHEN CONSULTANT:  
Edge Consultants, Inc.  
220 E Lake Street  
Addison, IL

Date	October 8, 2010
Comm. No.	1335
Scale	NTS
Drawn	DP
Checked	DK
Proj. Arch.	

**CSK - 5**

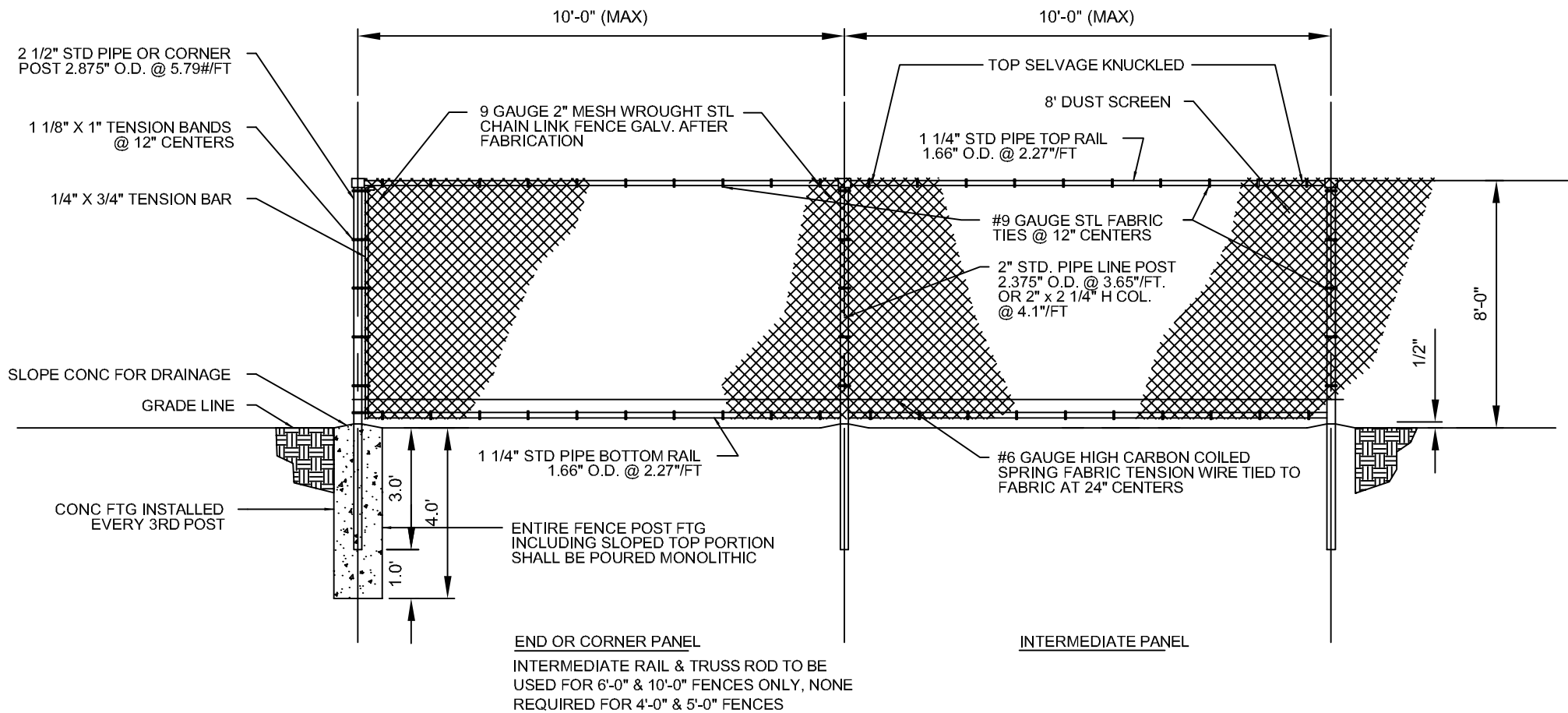

12 CONSTRUCTION FENCE  
NTS

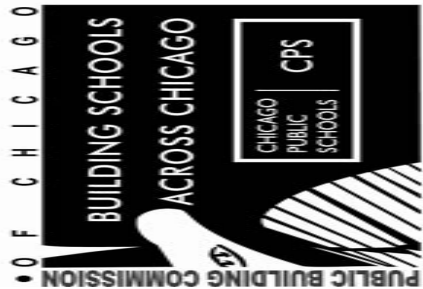

Brighton Park II,  
Elementary School  
CHICAGO PUBLIC SCHOOLS

CITY OF CHICAGO  
MAYOR RICHARD M. DALEY

2611 West 48th Street  
CHICAGO, IL 60632



Architrave, Ltd.  
1128 W. Chicago Ave.  
2nd Floor  
Chicago, Illinois 60642  
(312) 642-2600

CIVIL ENG. &  
LANDSCAPE ARCH:  
Terra Engineering Ltd.  
225 W/ Ohio St. #400.  
Chicago, Illinois

STRUCTURAL ENGINEER:  
McDonough Assoc., Inc.  
130 E Randolph St # 1000  
Chicago, IL

M, E, P & FP ENG.:  
Globetrotters  
300 S Wacker Dr # 400  
Chicago, IL

THEATRE CONSULTANT:  
Schuler Shook  
750 N Orleans St # 400  
Chicago, IL

KITCHEN CONSULTANT:  
Edge Consultants, Inc.  
220 E Lake Street  
Addison, IL

Date	October 8, 2010
Comm. No.	1335
Scale	NTS
Drawn	DP
Checked	DK
Proj. Arch.	

CSK - 6

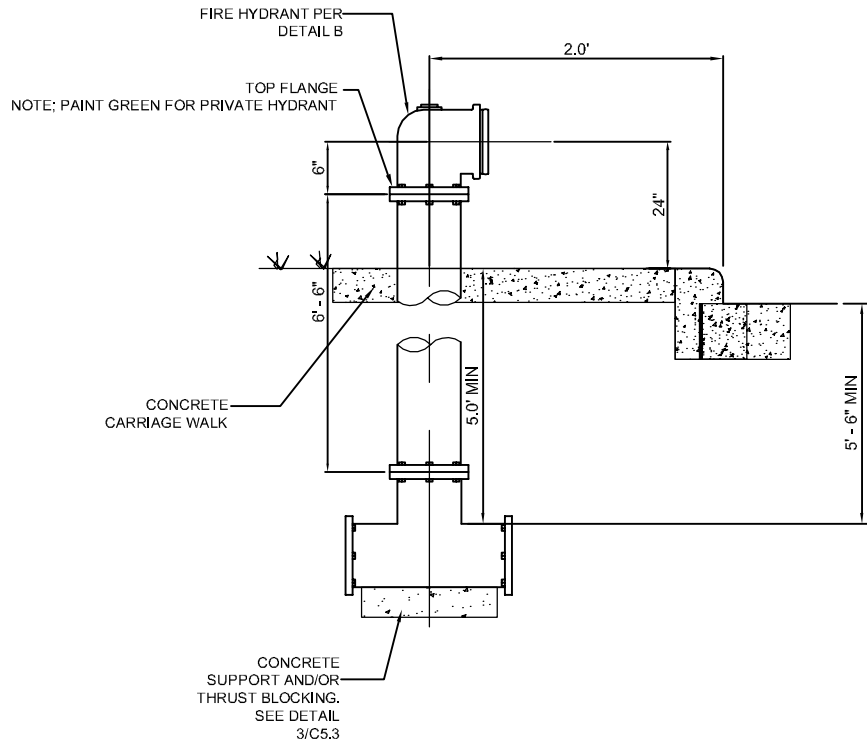

**A** FIRE HYDRANT SETTING DETAIL  
NTS

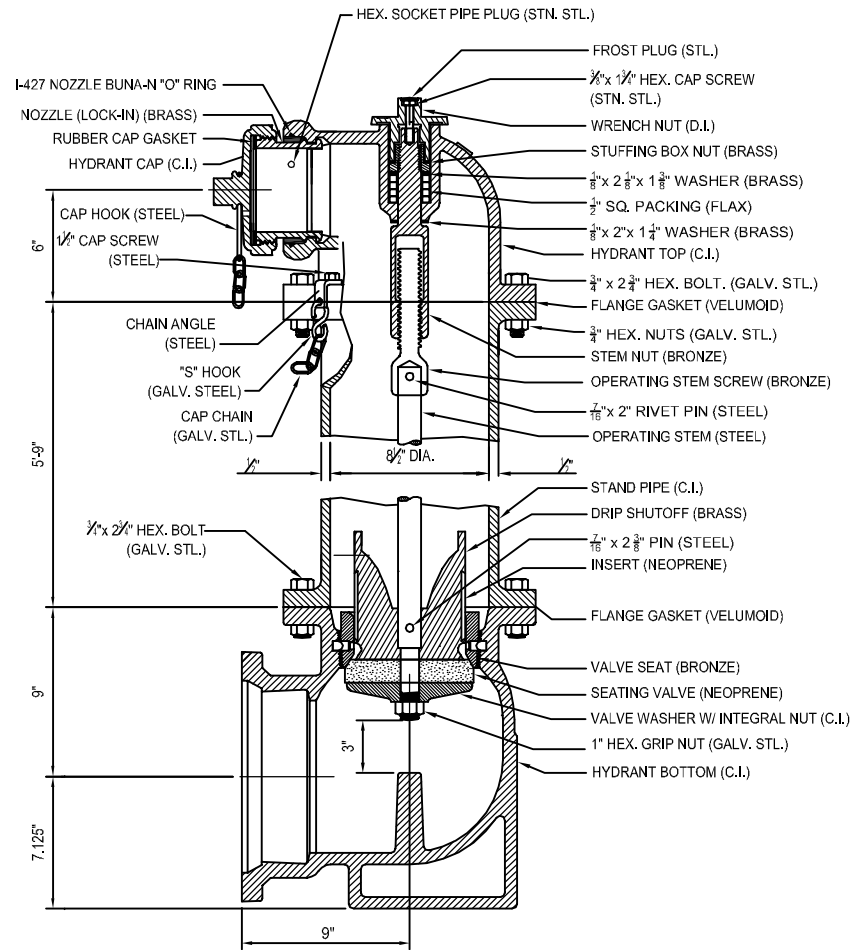

**B** FIRE HYDRANT CROSS-SECTION DETAIL  
NTS

NOTE:

1. TOP CASTING IS TURNED 45 FROM TRUE POSITION IN SECTIONAL VIEW.

**6** FIRE HYDRANT  
NTS

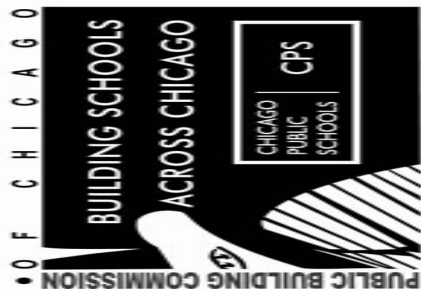

Brighton Park II,  
Elementary School  
CHICAGO PUBLIC SCHOOLS

CITY OF CHICAGO  
MAYOR RICHARD M. DALEY

2611 West 48th Street  
CHICAGO, IL 60632



Architrave, Ltd.  
1128 W. Chicago Ave.  
2nd Floor  
Chicago, Illinois 60642  
(312) 642-2600

CIVIL ENG. &  
LANDSCAPE ARCH:  
Terra Engineering Ltd.  
225 W/ Ohio St. #400.  
Chicago, Illinois

STRUCTURAL ENGINEER:  
McDonough Assoc., Inc.  
130 E Randolph St # 1000  
Chicago, IL

M, E, P & FP ENG.:  
Globetrotters  
300 S Wacker Dr # 400  
Chicago, IL

THEATRE CONSULTANT:  
Schuler Shook  
750 N Orleans St # 400  
Chicago, IL

KITCHEN CONSULTANT:  
Edge Consultants, Inc.  
220 E Lake Street  
Addison, IL

Date	October 8, 2010
Comm. No.	1335
Scale	NTS
Drawn	DP
Checked	DK
Proj. Arch.	

CSK - 7