

original

Contractor: Old Veteran Construction, Inc.
Address: 10942 S. Halsted St.
City/State/Zip: Chicago, IL 60628
Phone Number: 773/821-9900
Fax Number: 773/821-9911

TO BE EXECUTED IN DUPLICATE

**BOOK 2:
PROJECT INFORMATION, INSTRUCTIONS, AND EXECUTION DOCUMENTS**

CONTRACT NO. 1448

**7th District Police Station
1400 W. 63rd Street
Site Work and Underground Utilities
PD-007**

PUBLIC BUILDING COMMISSION OF CHICAGO



**Mayor Richard M. Daley
Chairman**

**Montel M. Gayles
Executive Director**

**Room 200
Richard J. Daley Center
50 West Washington Street
Chicago, Illinois 60602
312-744-3090
www.pbcchicago.com**

Any contract entered into as a result of this bid process is governed by the terms and conditions set forth in Book 1 "Standard Terms and Conditions for Construction Contracts (with Community Hiring requirement)" dated June 1, 2006 and incorporated as if fully set forth here by this reference; and by Book 2, Book 3, plans, drawings, exhibits, and attachments as appropriate.

PUBLIC BUILDING COMMISSION OF CHICAGO
Contract No. 1448

TABLE OF CONTENTS

EXHIBITS	3
I. PREVAILING WAGE RATE SHEET FOR COOK COUNTY DOCUMENT SUBMITTAL CHECKLIST	3
DOCUMENT SUBMITTAL CHECKLIST	4
I. PROJECT INFORMATION	5
A. GENERAL PROJECT INFORMATION	5
B. TIME OF COMPLETION	6
C. TIME OF COMPLETION OF PUNCH LIST WORK	6
D. COPIES OF DRAWINGS AND SPECIFICATIONS FURNISHED	7
E. LIQUIDATED DAMAGES	7
F. INSURANCE REQUIREMENTS	7
G. NOTICES	10
H. PREVAILING WAGE RATES	10
I. COMMUNITY HIRING REQUIREMENTS AND INCENTIVES	10
J. CONTRACTOR'S PROJECT MANAGER	11
K. LICENSING	11
IN ADDITION TO ALL OTHER APPLICABLE LICENSES AND CERTIFICATIONS, THE GENERAL CONTRACTOR IS REQUIRED TO SUBMIT COPY OF THE <u>CLASS A</u> , GENERAL CONTRACTOR LICENSE ISSUED BY THE DEPARTMENT OF BUILDINGS OF THE CITY OF CHICAGO.	11
II. PROPOSAL AND EXECUTION DOCUMENTS	12
A. CONTRACTOR'S BID	12
B. ACCEPTANCE OF THE BID	15
C. CORPORATE RESOLUTION (IF A CORPORATION)	16
III. PROPOSAL SUPPORT DOCUMENTS	17
A. BASIS OF AWARD (AWARD CRITERIA)	17
B. UNIT PRICES	22
IV. ADDITIONAL DOCUMENTS TO BE EXECUTED	25
AFFIDAVIT OF NONCOLLUSION	25
SCHEDULE B - JOINT VENTURE AFFIDAVIT	26
SCHEDULE C - LETTER OF INTENT FROM MBE/WBE	29
SCHEDULE D - AFFIDAVIT OF GENERAL CONTRACTOR REGARDING MBE/WBE PARTICIPATION	31
SCHEDULE E - REQUEST FOR WAIVER FROM MBE/WBE PARTICIPATION	33
AFFIDAVIT OF UNCOMPLETED WORK	34
AFFIDAVIT OF LOCAL BUSINESS	38
STATEMENT OF BIDDER'S QUALIFICATIONS	39
DISCLOSURE OF RETAINED PARTIES	41
PERFORMANCE AND PAYMENT BOND	43
V. INSTRUCTIONS TO BIDDERS	47
A. EXAMINATION OF DOCUMENTS BY BIDDER	47
B. INTERPRETATIONS OR ADDENDA	47
C. INSPECTION OF SITE	47
D. PRE-QUALIFICATION OF BIDDERS	47
E. COMPETENCY OF BIDDER	48
F. SUBSTITUTIONS PRIOR TO BID DATE	48
G. PREPARATION OF BID	48
H. BID GUARANTEE: DEPOSIT AND TIME PERIOD	49

PUBLIC BUILDING COMMISSION OF CHICAGO
Contract No. 1448

I. ADMINISTRATIVE FEE	50
J. BIDDER'S EXECUTION OF BID	50
K. BASIS OF AWARD (AWARD CRITERIA)	50
L. ALTERNATES	50
M. UNIT PRICES	50
N. AFFIDAVIT OF NON-COLLUSION	51
O. MBE AND WBE COMMITMENTS	51
P. AFFIDAVIT OF UNCOMPLETED WORK	51
Q. BIDDER'S FINANCIAL STATEMENT	51
R. DISCLOSURE AFFIDAVIT	51
S. AFFIDAVIT OF LOCAL BUSINESS	51
T. STATEMENT OF BIDDER'S QUALIFICATIONS	51
U. DISCLOSURE OF RETAINED PARTIES	51
V. SUBMISSION OF BID	52
W. WITHDRAWAL OF BIDS BEFORE BID OPENING	52
X. OPENING OF BIDS	52
Y. EVALUATION OF BIDS	52
Z. AWARD OF CONTRACT; REJECTION OF BIDS	52
AA. PERFORMANCE AND PAYMENT BOND AND INSURANCE	53
BB. ORDER OF PRECEDENCE OF COMPONENTS OF THE CONTRACT DOCUMENTS	53
CC. PROTESTS	53

EXHIBITS

1. Prevailing Wage Rate Sheet for Cook County

PUBLIC BUILDING COMMISSION OF CHICAGO

Contract No. 1448

DOCUMENT SUBMITTAL CHECKLIST

Two originals of the following documents are required at the time of bid opening. Please ensure that you have completed the forms and indicate such by placing an "X" next to each completed item:

1. X Contractor's Bid
2. X Bid Guarantee
3. X Administrative Fee
4. X Acceptance of the Bid
5. X Basis of Award (Award Criteria)
6. X Unit Prices
7. X Affidavit of Non-Collusion
8. X Schedule B – Affidavit of Joint Venture (if applicable)
9. X Schedule C – Letter of Intent from MBE/WBE, including current certification letter
10. X Schedule D – Affidavit of General Contractor Regarding MBE/WBE Participation
11. X Schedule E – Request for Waiver from MBE/WBE Participation
12. X Affidavit of Uncompleted Work
13. X Written authorizations from the three (3) disposal facilities

Current versions of the following documents must be on file with the Commission at the time of bid opening:

1. _____ Financial Statement
2. _____ Disclosure Affidavit
3. _____ Affidavit of Local Business, including business license
4. _____ Statement of Bidder's Qualifications

The Contractor is required to submit the following within five (5) days after bid opening.

1. _____ **Disclosure of Retained Parties** (The apparent low and the apparent 2nd low bidder must submit a fully executed Disclosure of Retained Parties within 5 days after bid opening)

PUBLIC BUILDING COMMISSION OF CHICAGO

Contract No. 1448

I. PROJECT INFORMATION

A. General Project Information

The following specifications supplement Part IV. "Additional Documents to be Executed" and Part V. "Instructions to Bidders."

1. Bids will be received by the Public Building Commission of Chicago for the following in accordance with the Contract Documents set forth below:

**7th District Police Station
1400 W. 63rd Street
Site Work and Underground Utilities
PD-007**

2. **General Description of Scope of Work:**

- a) As described in the specifications, the work under this contract consists of furnishing all supervision, labor, materials, tools, equipment, transportation and services to excavate soil, transport impacted soils off-site for disposal, remove and dispose of materials at the new 7th District Police Station site as shown on the Drawings and as described in the Technical Specifications, including all appurtenant Work and accessories to the complete satisfaction, approval and acceptance by the Public Building Commission of Chicago. The Work is to be performed on a unit price and lump sum contract basis. Work includes, but is not limited to, excavation, soil remediation, backfill, erosion control and materials removal.
- b) This description of Work is intended to be general in nature and is neither a complete description nor a limitation of the Work to be performed. The Contractor must perform all Work described in the Contract Documents or reasonably inferable as necessary to produce the results specified therein, except to the extent specifically indicated in the Contract Documents to be the responsibility of others.

3. **User Agency: Department of General Services**

4. **Commission's Representative's Name, Address, and Phone Number: Mike Duet, Carnow Conibear & Associates, Ltd., 300 West Adams Street, Suite 1200, Chicago, IL 60606, tel 312-762-2912**

5. **Architect's Name, Address, and Phone Number: Kevin Curran, VOA Associates, Inc, 224 S. Michigan Avenue, Suite 1400, Chicago, IL 60604, tel 312-453-7606**

6. **Commission's Portfolio Manager: Ray Giderof**

7. **Ward: 16th**

8. **City Funded?: Yes**

PUBLIC BUILDING COMMISSION OF CHICAGO

Contract No. 1448

9. **Do Bidders need to be Pre-Qualified? No** (see Part V.D. "Pre-Qualification of Bidders" for details):

10. **Request for Information: send to Public Building Commission of Chicago, Attn: Janice Meeks, Contract Administrator via (fax) 312-744-3572 or (email) janicemeeks@cityofchicago.org**

11. **Inspection of Site**

In accordance with Section 3.03 "Site Conditions and Inspection," the Bidder is expected to inspect the Site of the Work. No allowance will be made for any difficulties that may be encountered in executing the Work due to any condition or situation that could have been discovered by inspection of the Site. Site inspection must be arranged through the Public Building Commission of Chicago.

12. **Documents Available from: Cushing and Company, 420 West Huron Street, Chicago, IL 60610, tel 312-266-8228.**

13.

14. **Pre-Bid Meeting Date, Time, and Location: Monday, August 14, 2006 at 10:00 AM in the 2nd Floor Board Room, Richard J. Daley Center, 50 West Washington Street, Chicago, IL 60602**

15. **Bid Opening Date and Time: Tuesday, August 22, 2006 at 2:00 PM**

16. **Amount of Bid Deposit: 5% of bid amount**

17. **Administrative Fee: \$5,000.00**

18. **Document Deposit: \$0**

19. **Cost for Additional Documents (per set): \$ at the contractor's expense**

20. **Award of Contract**

Attention is called to Part V.Z. "Award of Contract; Rejection of Bids" for procedures regarding the award of the Contract.

20. **MBE/WBE Contract Goals: 24% MBE and 4% WBE**

B. Time of Completion

The Work must be completed within (98) calendar days upon issuance of the Notice to Proceed. The work must be performed in two phases.

C. Time of Completion of Punch List Work

All final Punch List work must be prosecuted expeditiously and completed, in total, within thirty (30) Days of the date of transmittal to the Contractor.

PUBLIC BUILDING COMMISSION OF CHICAGO

Contract No. 1448

return and perform any additional work, the minimum insurance coverages and requirements specified below, insuring all operations related to the Contract.

1. Insurance To Be Provided By the Contractor

a) Workers Compensation and Employers Liability

Workers' Compensation Insurance, as prescribed by applicable law covering all employees who are to provide a service under this Contract and Employers Liability coverage with limits of not less than \$500,000 each accident or illness.

b) Commercial General Liability (Primary and Umbrella)

Commercial General Liability Insurance, with limits of not less than \$5,000,000 per occurrence for bodily injury, personal injury, and property damage liability. Coverage must include the following: All premises and operations, products/completed operations, (for minimum of two (2) years following project completion), explosion, collapse, underground, separation of insureds, defense, and contractual liability (with no limitation endorsement). The Public Building Commission and the City of Chicago are to be named as additional insureds on a primary, non-contributory basis for any liability arising directly or indirectly from the work.

Subcontractors performing work for Contractor must maintain limits of not less than \$1,000,000 per occurrence with the same terms herein.

c) Automobile Liability (Primary and Umbrella)

When any motor vehicles (owned, non-owned and hired) are used in connection with work to be performed, the Contractor must provide Automobile Liability Insurance, with limits of not less than \$5,000,000 per occurrence for bodily injury and property damage. The Public Building Commission and the City of Chicago are to be named as additional insureds on a primary, non-contributory basis.

Any contractor handling hazardous materials, substances or waste must conform to 49 CFR, part 387, Minimum Levels of Financial Responsibility for Motor Carriers.

Subcontractors performing work for Contractor must maintain limits of not less than \$1,000,000 per occurrence with the same terms herein.

d) Professional Liability

When any architects, engineers, construction managers or other professional consultants perform work in connection with this Contract, Professional Liability Insurance covering acts, errors, or omissions must be maintained with limits of not less than \$1,000,000. Coverage must include contractual liability. When policies are renewed or replaced, the policy retroactive date must coincide with, or precede, start of work on the Contract. A claims-made policy, which is not renewed or replaced, must have an extended reporting period of two (2) years.

PUBLIC BUILDING COMMISSION OF CHICAGO

Contract No. 1448

e) Contractors Pollution Liability

When any work is performed which may cause a pollution exposure, Contractors Pollution Liability must be provided covering bodily injury, property damage and other losses caused by pollution conditions that arise from the Contract scope of services with limits of not less than \$5,000,000 per occurrence. Coverage must include completed operations, contractual liability, defense, environmental cleanup, remediation and disposal. When policies are renewed or replaced, the policy retroactive date must coincide with or precede, start of work on the Contract. A claims-made policy, which is not renewed or replaced, must have an extended reporting period of two (2) years. The Commission and City of Chicago are to be named as additional insureds.

f) Property

The Contractor is responsible for all loss or damage to Commission and/or City property at full replacement cost.

The Contractor is responsible for all loss or damage to personal property (including but not limited to materials, equipment, tools, and supplies) owned, rented, or used by Contractor.

2. Additional Requirements

Contractor must furnish the Public Building Commission Procurement Department, Richard J. Daley Center, Room 200, Chicago, IL 60602, original Certificates of Insurance, or such similar evidence, to be in force on the date of this Contract, and Renewal Certificates of Insurance, or such similar evidence, if the coverages have an expiration or renewal date occurring during the term of this Contract. The Contractor must submit evidence of insurance to the Public Building Commission prior to Contract award. The receipt of any certificate does not constitute agreement by the Commission that the insurance requirements in the Contract have been fully met or that the insurance policies indicated on the certificate are in compliance with all Contract requirements. The failure of the Commission to obtain certificates or other insurance evidence from Contractor is not a waiver by the Commission of any requirements for the Contractor to obtain and maintain the specified coverages. The Contractor shall advise all insurers of the Contract provisions regarding insurance. Non-conforming insurance does not relieve Contractor of the obligation to provide insurance as specified herein. Nonfulfillment of the insurance conditions may constitute a violation of the Contract, and the Commission retains the right to stop work until proper evidence of insurance is provided, or the Contract may be terminated.

The Commission and/or City of Chicago reserve the right to obtain copies of insurance policies and records from the Contractor and/or its subcontractors at any time upon written request.

The insurance must provide for 60 days prior written notice to be given to the Commission in the event coverage is substantially changed, canceled, or non-renewed.

Any deductibles or self-insured retentions on referenced insurance coverages must be borne by Contractor.

The Contractor agrees that insurers waive their rights of subrogation against the Public Building Commission, its employees, elected officials, agents, or representatives and the City of Chicago

PUBLIC BUILDING COMMISSION OF CHICAGO
Contract No. 1448

The coverage and limits furnished by Contractor in no way limit the Contractor's liabilities and responsibilities specified within the Contract or by law.

Any insurance or self-insurance programs maintained by the Commission and City of Chicago do not contribute with insurance provided by the Contractor under the Contract.

The required insurance to be carried is not limited by any limitations expressed in the indemnification language in this Contract or any limitation placed on the indemnity in this Contract given as a matter of law.

If contractor is a joint venture, the insurance policies must name the joint venture as a named insured.

The Contractor must require all subcontractors to provide the insurance required herein, or Contractor may provide the coverage for subcontractors. All subcontractors are subject to the same insurance requirements of Contractor unless otherwise specified in this Contract.

If Contractor or subcontractor desires additional coverage, the party desiring the additional coverage is responsible for the acquisition and cost.

The Public Building Commission maintains the rights to modify, delete, alter or change these requirements.

G. Notices

In accordance with Section 22.05 "Notices," Notices must be addressed as follows:

1. If to the Commission, notices must be addressed to the attention of the Ray Giderof with copies to: **Mike Duet, Carnow Conibear & Associates, Ltd., 300 West Adams Street, Suite 1200, Chicago, IL 60606**
2. If to the Contractor, notices must be sent to the address identified on the title page of this Book 2 with copies to: **Mike Duet, Carnow Conibear & Associates, Ltd., 300 West Adams Street, Suite 1200, Chicago, IL 60606** the Contractor's Bonding Company

H. Prevailing Wage Rates

Prevailing wage rates in effect at the time of issuance of these Contract Documents are attached. One resource for determining the current prevailing wage rate is the Internet site www.state.il.us/agency/idol/CM/countym.htm maintained by the State of Illinois Department of Labor.

I. Community Hiring Requirements and Incentives

This Contract is subject to community hiring requirements and incentives. See Part III "Basis of Award (Award Criteria)" and in Book 1, Section 21.03 "Chicago Residents as Employees" for details.

PUBLIC BUILDING COMMISSION OF CHICAGO
Contract No. 1448

J. Contractor's Project Manager

Contractor's full-time Project Manager is required at the Site.

K. Licensing

In addition to all other applicable licenses and certifications, the general contractor is required to submit copy of the Class A General Contractor License issued by the Department of Buildings of the City of Chicago.

PUBLIC BUILDING COMMISSION OF CHICAGO

Contract No. 1448

II. PROPOSAL AND EXECUTION DOCUMENTS

A. Contractor's Bid

The Contractor hereby acknowledges receipt of the Contract Documents for Contract No. 1448 containing a full set of Contract Documents, including, but not limited to, a) Standard Terms and Conditions (Book 1), b) Addenda Nos. (none unless indicated here) 1- 8/17/06

c) Project Information, Instructions, and Execution Documents (Book 2), d) Technical Specifications (Book 3), and e) Plans and Drawings.

Further, the Contractor, having inspected the Site and become familiar with the conditions affecting the cost of the Work and with the requirements of the Contract, hereby proposes to furnish all labor, necessary tools, materials and other work necessary to perform and complete in a workmanlike manner the TYPE OF WORK for PROJECT located at the Site designated as required by and in strict accordance with the Contract Documents for the Base Contract Price listed on the next page.

The agreement between the parties includes not only this instrument, but also the remaining Contract Documents as described in the Standard Terms and Conditions, and all of which shall be binding on the parties hereto.

Time is of the essence of this Contract. The Contractor agrees that it will commence the performance of the Work on the date set forth in the Notice to Proceed issued by the Commission and that it will complete the Work within the time set forth in Part I "Project Information."

The Base Contract Price listed below, as adjusted from time to time pursuant to the Contract Documents, shall be full compensation to the Contractor for having well and faithfully completed the Work, free and clear of all claims, liens, and charges whatsoever, of any kind or nature, and in full compliance with the Contract.

Payment for the Work will be made in the manner set forth in the Standard Terms and Conditions.

The Contractor warrants that it has not employed any person to solicit or secure this Contract upon any agreement for a commission, percentage, brokerage, or contingent fee. Breach of this warranty shall give the Commission the right to terminate the Contract, or, at its discretion, to deduct from the Contract Price or consideration the amount of such commission, percentage, brokerage, or contingent fees. This warranty shall not apply to any commission payable by the Contractor upon contracts or sales secured or made through bona fide established commercial or selling agencies maintained by the Contractor for the purpose of securing business.

The Contractor, being duly sworn, deposes and says on oath that no disclosures of ownership interests have been withheld; the information provided therein to the best of its knowledge is current; and the undersigned proposes to furnish the insurance and the Performance and Payment Bond required by the Contract Documents.

PUBLIC BUILDING COMMISSION OF CHICAGO
Contract No. 1448

Phase I - Site Package Unit Price Breakdown

UNIT PRICES SUB-TOTAL (A) page 24	\$ 1,874,949.75
GENERAL CONDITIONS (B)	\$ 97,350.63
TOTAL BASE BID (Total Base bid should equal the sum of subtotals A & B)	\$ 1,972,300.38

NOTE:

1. "Unbalanced Bids" - Bidders pricing for each line item should carry its share of the cost of the work, plus its share of overhead and profit. Bidders should avoid nominal pricing for some line items and enhanced pricing for other lines. Bids that the Director of Procurement considers in her sole opinion to be materially unbalanced will be rejected.
2. "Disposal Sites" - Contractor must obtain and provide copies of written authorizations from licensed/permitted construction and demolition debris disposal sites and land fills for the disposal of excavated materials from the site. The authorizations must be signed/executed by the disposal facilities representatives, and state that the site complies with all local zoning codes, State, Federal, and local laws, rules, and regulations. Contractor shall submit the name and address of minimum of three (3) disposal facilities that will be utilized for this project. **The written authorizations from the three (3) disposal facilities must be submitted with Contractors' bid.**
3. The approximate quantities listed in the unit prices should be utilized for pricing purposes.

AWARD CRITERIA FIGURE (See Line 15 of Award Criteria Formula):

(\$ 1,921,021.00)

SURETY: Please specify full legal name and address of Surety:

The Cincinnati Insurance Company

6200 S. Gilmore Road

Fairfield, OH 45014-5141

PUBLIC BUILDING COMMISSION OF CHICAGO
Contract No. 1448

ALTERNATES (if any):

<u>Accepted by</u> <u>the</u> <u>Commission</u>		<u>Alternate Description</u>	<u>Proposed Alternate</u> <u>Price</u>
<u>Yes</u>	<u>No</u>		
<input type="checkbox"/>	<input type="checkbox"/>	Alternate #1 - NOT APPLICABLE	\$ _____
<input type="checkbox"/>	<input type="checkbox"/>	Alternate #2 - NOT APPLICABLE	\$ _____
<input type="checkbox"/>	<input type="checkbox"/>	Alternate #3 - NOT APPLICABLE	\$ _____
<input type="checkbox"/>	<input type="checkbox"/>	Alternate #4 - NOT APPLICABLE	\$ _____

BASE CONTRACT PRICE (to be completed by the Commission): ONE

MILLION NINE HUNDRED SEVENTY TWO THOUSAND

THREE HUNDRED AND 38/100 dollars
(\$ 1,972,300.38)

PUBLIC BUILDING COMMISSION OF CHICAGO
Contract No. 1448

B. Acceptance of the Bid

IN WITNESS WHEREOF, the parties hereto have caused this instrument to be executed in two (2) original counterparts the day and year first above written.

PUBLIC BUILDING COMMISSION OF CHICAGO

Edmund Johnson
Secretary

Richard M Daley
Chairman

CONTRACTING PARTY
(Print or type names underneath all signatures)

Contractor Name _____ Address _____

If a Corporation:

By Jose Maldonado
Jose Maldonado

President _____
Title of Signatory

ATTEST:
By Jose Maldonado
Jose Maldonado
CORPORATE SEAL

Secretary _____
Title

If a Partnership:

Partner _____ Address _____

Partner _____ Address _____

Partner _____ Address _____

If a Sole Proprietorship:

Signature _____

NOTARY PUBLIC
County of Cook State of IL
Subscribed and sworn to before me on this 22 day of August, 2006.

Joann M Zajac
Notary Public Signature
Commission Expires: 11/15/02

(SEAL)

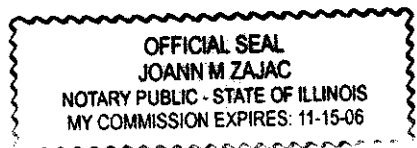

PUBLIC BUILDING COMMISSION OF CHICAGO
Contract No. 1448

C. Corporate Resolution (if a Corporation)

I, the undersigned, DO HEREBY CERTIFY that the following is a complete, true and correct copy of certain preambles and resolutions of the board of directors of Old Veteran Construction, Inc., a corporation duly organized and existing under the laws of the State of Illinois and authorized to do business in the State of Illinois, which resolutions were duly adopted at a duly called meeting of said board held on January 5, 20 04, a quorum being present, and are set forth in the minutes of said meeting; that I am the keeper of the corporate seal and of the minutes and records of said corporation; and that the said resolutions have not been rescinded or modified:

WHEREAS, this corporation submitted a bid, dated August 22, 2006 to the Public Building Commission of Chicago, for Contract No. 1448 of said Commission;

NOW, THEREFORE, BE IT RESOLVED: That the president or vice president and the secretary or assistant secretary of this corporation be, and they are hereby, authorized and directed to execute contracts for and on behalf of and under the name and seal of this corporation; and

BE IT FURTHER RESOLVED: That the aforesaid officers of this corporation be, and they are hereby, authorized and directed to execute and deliver to the Commission, for and on behalf of this corporation, such other and all documents as may be necessary or pertinent to a contract, and to do and perform any and all other acts relative thereto.

I FURTHER CERTIFY that the following-named persons are the officers of this corporation duly qualified and now acting as such:

President:	<u>Jose Maldonado</u>
Vice President:	<u>Jose Maldonado</u>
Secretary:	<u>Jose Maldonado</u>
Treasurer:	<u>Jose Maldonado</u>
Assistant Secretary:	<u>N/A</u>

IN WITNESS WHEREOF, I have hereunto subscribed my name and affixed the seal of said corporation, this 22 day of August, 2006.

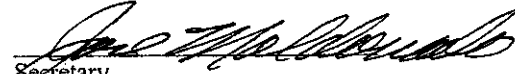
Secretary

PUBLIC BUILDING COMMISSION OF CHICAGO

Contract No. 1448

III. PROPOSAL SUPPORT DOCUMENTS

A. Basis of Award (Award Criteria)

To promote the intended goal of economic opportunity and maximize the use of minority personnel on this project, the Public Building Commission of Chicago has established the Award Criteria formula for the purpose of evaluating proposals and awarding the contract. A contract in the amount of the total Base Bid or Base Contract Price will be awarded to the responsible bidder with the lowest Award Criteria Figure. The Public Building Commission of Chicago reserves the right to check all calculations for accuracy. The fulfillment of the Award Criteria does not abrogate the responsibilities of the Contractor to comply with federal and state requirements under the *Equal Employment Act* and the *Illinois Human Rights Act*.

1. Instructions

The Bidder shall complete the Award Criteria Formula and transfer the final Award Criteria Figure - Line 15 to the space provided on the itemized proposal sheet. Failure to complete the formula may be cause for rejection of the Bidder's proposal. The successful bidder will be held responsible for adhering to the figures submitted in Lines 1, 2, 4, 6, 8, 10 and 12 during construction of the project.

Lines 2, 4 and 6 in the formula shall not be greater than fifty percent (50%) in each category for the sole purpose of determining award of the contract. Similarly, lines 8, 10 and 12 shall not be greater than ten (10%) percent in each category for the purpose of award criteria only. The fifty percent (50%) and ten percent (10%) goals are not intended to restrict the total number of minority and female employees to be used on the project, but only to establish limiting figures for use in the formula. Journeyworker includes journeyworkers from the major trades listed herein, and the teamsters. Watchmen and custodial workers are not creditable in the formula.

2. Award Criteria Formula

Line 1.	Base Bid, in figures	<u>1,972,300.00</u>
Line 2.	Percentage of the Journeyworkers hours that the Contractor proposes to be worked by minority Journeyworkers during construction of the project. (Maximum figure 0.50)	<u>25%</u>
Line 3.	Multiply Line 2 by Line 1 by 0.04	<u>\$19,723.00</u>
Line 4.	Percentage of total Apprentice hours that the Contractor proposes to be worked by minority Apprentices during construction of the project. (Maximum figure 0.50)	<u>40%</u>
Line 5.	Multiply Line 4 by Line 1 by 0.03	<u>\$23,668.00</u>
Line 6.	Percentage of the total Laborer hours that the Contractor proposes to be worked by minority Laborers during construction of the project. (Maximum figure 0.50)	<u>40%</u>
Line 7.	Multiply Line 6 by Line 1 by 0.01	<u>\$7,889.00</u>
Line 8.	Percentage of total Journeyworker hours that the Contractor proposes to be worked by female Journeyworkers during the construction of the project. (Maximum figure 0.10)	<u>0%</u>
Line 9.	Multiply Line 8 by Line 1 by 0.04	<u>\$0.00</u>
Line 10.	Percentage of total Apprentice hours that the Contractor	<u>0%</u>

PUBLIC BUILDING COMMISSION OF CHICAGO

Contract No. 1448

proposes to be worked by female Apprentices during construction of the project. (Maximum figure 0.10)

Line 11.	Multiply Line 10 by Line 1 by 0.03	<u>\$0.00</u>
Line 12.	Percentage of the total Laborer hours that the Contractor proposes to be worked by female Laborers during construction of the project. (Maximum figure 0.10)	<u>0%</u>
Line 13.	Multiply Line 12 by Line 1 by 0.01	<u>\$0.00</u>
Line 14.	Summation of Lines 3, 5, 7, 9, 11, and 13	<u>\$51,280.00</u>
Line 15.	Subtract Line 14 from Line 1 (= "Award Criteria Figure")	<u>\$1,921.021</u>

Award Criteria Figure (Insert Line 15 of Award Criteria Formula): \$ 1,921.021.00

3. Community Hiring Bonuses

In order to encourage maximum employment of interested and available residents of the project community on this project, the following bonus calculations shall apply:

- a) In calculating the hours worked by minority and women journeyworkers, apprentices, and laborers under the Award Criteria set out in Part III.A. "Basis of Award (Award Criteria)," all hours worked by minority and women journeyworkers, existing apprentices, and laborers who are residents of the project community shall be multiplied by 1.5.
- b) In calculating the hours worked by minority and women apprentices under the Award Criteria set out in Part III "Proposal Support Documents," all hours worked in new apprenticeships by minority and women apprentices who are residents of the project community shall be multiplied by 2.0.

Definitions

"Actual residents of the City of Chicago" shall mean persons domiciled within the City of Chicago. The domicile is an individual's one and only true, fixed, and permanent home and principal establishment.

"Residents of the project community" shall mean persons domiciled within the Ward in which the Site is located.

"New Apprenticeship" shall mean an apprenticeship begun for a person who has not held an apprenticeship card within ninety (90) days prior to beginning the project.

4. Liquidated Damages

The Contractor hereby consents and agrees that, in the event that it fails to comply with each of the minimum commitments submitted with this Proposal on Lines 2, 4, 6, 8, 10, and 12 of the Award Criteria Formula, covering minority and female Journeyworkers, apprentices, and laborers respectively, the following shall apply.

If the total hours in any category for which a percentage is assigned in Lines 2, 4, 6, 8, 10, or 12 of the Award Criteria equals zero at the completion of the work, then a net deficiency of the entire percentage assigned will be deemed to exist. For any net deficiency in each category, the following amounts shall be

PUBLIC BUILDING COMMISSION OF CHICAGO

Contract No. 1448

deducted as liquidated damages from monies due the Contractor and the Contract Sum modified accordingly:

- a) For each full one (1%) percent deficiency of minority Journeyworkers not utilized – seventeen and ninety three hundredths cents per each hundred dollars of the base bid calculated as follows:

$$\frac{\text{Line 1} \times 0.1793}{100}$$

Each one (1%) percent deficiency toward the goal for female Journeyworkers (Line 8) shall be calculated in the same way.

- b) For each full one (1%) percent deficiency of minority apprentices not utilized – sixteen and ninety three hundredths cents per hundred dollars of the base bid calculated as follows:

$$\frac{\text{Line 1} \times 0.1693}{100}$$

Each one (1%) percent deficiency toward the goal for female apprentices (Line 10) shall be calculated in the same way.

- c) For each one (1%) percent deficiency of minority laborers not utilized – fourteen and ninety three hundredths cents per each hundred dollars of the base bid calculated as follows:

$$\frac{\text{Line 1} \times 0.1493}{100}$$

Each one (1%) percent deficiency toward the goal for female laborers (Line 12) shall be calculated in the same way.

- d) Liquidated damages, if any, will be calculated for the first pay requests reflecting fifty percent (50%) completion, seventy-five percent (75%) completion, and ninety percent (90%) completion, respectively, based upon the Contractor's pay request together with all attendant certified payrolls and other required documentation of minority and women employment. The accrued liquidated damages and interest will be added to the retention provided elsewhere in this contract. The amount of liquidated damages due to the Commission under this provision will bear compound interest at the rate of 5% per annum, compounded monthly from the date of the Notice to Proceed to the date of approval of a deductive change order for liquidated damages. Should the total amount of liquidated damages due under all provisions of this contract exceed the amount of the Commission's retainage, compound interest on the amount over and above the retainage will continue to accrue until the entire amount of liquidated damages and compound interest is paid to the Commission.
- e) The Commission is aware that certain subcontract agreements under this contract may require subcontractors to contribute to payment of liquidated damages assessed under this provision. Should enforcement of subcontract liquidated damages provisions result in an aggregate total of subcontractor liquidated damages greater than the liquidated damages assessed hereunder against Contractor, then Contractor must pay the excess pro rata as a bonus to each subcontractor exceeding its subcontract commitments for minority or women employment, or both.

5. Reporting

In accordance with this commitment, the Contractor must submit both the Contractor's Payroll Record Form and the Contractor's Recapitulation of Minority and Female Worker Hours and Percentages Form on

PUBLIC BUILDING COMMISSION OF CHICAGO

Contract No. 1448

a monthly basis. All Subcontractors shall be listed on the Contractor's Recapitulation Form whether active or not. For the purpose of this report, the following group categories will be used:

- a) The classification "White" includes person of Indo-European descent.
- b) The classification "Black" or "African-American" includes persons having origins in any of the black racial groups of Africa.
- c) The classification "Hispanic" includes persons whose origins are from Mexico, Puerto Rico, Cuba, Central or South America, the Caribbean Islands or other Spanish culture or origin, regardless of race.
- d) The classification "Native American" includes persons who are Native Americans by virtue of tribal association.
- e) The classification "Asian-Pacific" includes persons whose origins are from East Asia, Southeast Asia, the Pacific Islands or the Indian sub-continent.
- f) The classification "Other" includes qualified individuals with disabilities who meet legitimate skill, experience, education or other requirements of employment positions held or sought and who perform the essential function with or without reasonable accommodation and other groups or other individuals found by the Public Building Commission of Chicago to be socially and economically disadvantaged and to have suffered actual racial or ethnic discrimination and decreased opportunities to compete in Chicago area markets.

6. Major Trades

Asbestos Workers	Operating Engineers
Boiler Makers	Painters
Bricklayers	Pile Driver Mechanics
Carpenters	Pipe Fitters/Steam Fitters
Cement Masons	Plasterers
Electricians	Plumbers
Elevator Construction	Roofers
Glaziers	Sheet Metal Workers
Mechanists	Sprinkler Fitters
Machinery Movers	Technical Engineers
Ornamental Iron Workers	Tuck Pointers
Lathers	

For approval of other trades for consideration in the Award Criteria Formula, written approval should be requested from the Commission.

7. Trade Participation - For Information Only

The following information must be supplied by the Contractor for the purposes of evaluating figures supplied in the Award Criteria Formula. It is understood that these figures are estimates only and are not to be considered as limiting in any manner actual participation on the project.

Anticipated levels of minority participation, to be expressed as percentages, must be supplied for each trade, whether attributable to the Contractor's work force or any Subcontractor which will be active on this project.

PUBLIC BUILDING COMMISSION OF CHICAGO
Contract No. 1448

TRADE PARTICIPATION	PERCENT OF MINORITY
Cement Masons	50%
Electricians	50%
Ornamental Iron Workers	25%
Operating Engineers	25%
Plumbers	50%

PUBLIC BUILDING COMMISSION OF CHICAGO

Contract No. 1448

B. Unit Prices

Unit prices provided below in accordance with the provisions of the detailed Specifications may be used as the basis for adjustments to the Contract Price in the event that the quantities of Work required by the Contract Documents are increased or decreased. However, the Commission reserves the right to negotiate lower unit prices with the lowest responsive and responsible bidder. Attention is called to Part V.M "Unit Prices" for provisions regarding unit prices.

NOTE:

1. "Unbalanced Bids" - Bidders pricing for each line item should carry its share of the cost of the work, plus its share of overhead and profit. Bidders should avoid nominal pricing for some line items and enhanced pricing for other lines. Bids that the Director of Procurement considers in her sole opinion to be materially unbalanced will be rejected.

2. "Disposal Sites" - Contractors must obtain and provide copies of written authorizations from licensed/permitted construction and demolition debris disposal sites and land fills for the disposal of excavated materials from the site. The authorizations must be signed/executed by the disposal facilities representatives, and state that the site complies with all local zoning codes, State, Federal, and local laws, rules, and regulations. Contractor shall submit the name and address of minimum of three (3) disposal facilities that will be utilized for this project. The written authorizations from the three (3) disposal facilities must be submitted with Contractors' bid.

3. The approximate quantities listed below should be utilized for pricing purposes.

	TYPE OF WORK	UNIT(S)	Approx Qty	Unit Price	Extended Price (qty x unit price)
1.	Excavation, transport and disposal of in-place impacted soil	Tons	14200	42.78	607,407.84
2.	Excavation, transport and disposal of in-place non-impacted soil	Tons	250	31.20	7,800.00
3.	Excavation, transport and disposal of concrete	Tons	925	41.60	38,480.00
4.	Excavation, transport and disposal of clean construction and demolition debris	Tons	100	52.00	5,200.00
5.	UST removal (tank of less than 2,000 gallon capacity)	Each	1	5,200.00	5,200.00
6.	UST removal (tank of 2,001-5,000 gallon capacity)	Each	1	5,200.00	5,200.00
7.	UST removal (tank of 5,001-10,000 gallon capacity)	Each	1	7,280.00	7,280.00
8.	UST removal (tank of 10,001-20,000 gallon capacity)	Each	1	12,480.00	12,480.00
9.	UST removal (tank > 20,000 gallon capacity)	Each	1	15,600.00	15,600.00
10.	Tank sludge removal/disposal	Drums	10	364.00	3,640.00
11.	Bulk UST pump-out (liquids)	Gallons	5000	1.30	6,500.00
12.	Waste characterization sample analysis and obtain disposal authorization	Sample	10	2,600.00	26,000.00
13.	Impacted water - drummed	Drums	10	364.00	3,640.00
14.	Impacted water - bulk	Gallons	10,000	1.30	13,000.00
15.	Non-impacted water - bulk	Gallons	10,000	0.42	4,160.00
16.	Demo - Alley pavement removal and disposal	Square Foot	1500	3.95	5,928.00
17.	Demo - Concrete Curb and Gutter removal and disposal	Linear Foot	200	24.96	4,992.00
18.	Demo - City Sidewalk and base removal and disposal	Square Foot	1000	2.60	2,600.00

PUBLIC BUILDING COMMISSION OF CHICAGO

Contract No. 1448

	TYPE OF WORK	UNIT(S)	Approx Qty	Unit Price	Extended Price (qty x unit price)
19	Demo - Street Drainage Structure removal and disposal	Each	2	832.00	1,664.00
20	Demo - Concrete Driveway removal and disposal	Square Foot	1000	3.64	3,640.00
21	Demo - Site Fencing removal and disposal	Linear Foot	1100	4.68	5,148.00
22	Demo - Commercial Sign removal and disposal (1)	Lump Sum	1	5,200.00	5,200.00
23	Demo - Commercial Sign removal and disposal (2)	Lump Sum	1	6,240.00	6,240.00
24	Site Layout - Survey Crew for Excavation/Backfill	Each	1	1,872.00	1,872.00
25	Site Survey - Survey Crew for Verification of Excavation/Backfill Quantities	Each	3	1,872.00	5,616.00
26	Site Layout - Survey Crew for Rough Grading	Each	1	1,872.00	1,872.00
27	Site Layout - Survey Crew for Curb & Gutter Layout	Each	1	1,872.00	1,872.00
28	City Street removal & concrete restoration	Square Foot	12000	15.60	187,200.00
29	Street Asphalt Resurfacing per CDOT Standards	Square Yard	1600	38.48	61,568.00
30	Alley Asphalt Resurfacing per CDOT Standards	Square Yard	200	38.48	7,696.00
31	Water Tap in Right-of-Way	Lump Sum	3	11,024.00	33,072.00
32	1" Type "K" Copper Pipe	Linear Foot	120	131.30	15,756.00
33	Water Meter Vault	Each	3	6,188.00	18,564.00
34	RPZ Valve and Cover	Each	3	3,120.00	9,360.00
35	1" PVC Irrigation Pipe	Linear Foot	650	14.56	9,464.00
36	Hose Bib	Each	9	364.00	3,276.00
37	Storm Sewer Tap in Right-of-Way	Each	3	5,252.00	15,756.00
38	6" ESVCP	Linear Foot	500	77.56	38,781.60
39	8" ESVCP	Linear Foot	340	87.97	29,911.02
40	8" Perforated PVC Storm Pipe	Linear Foot	560	41.60	23,296.00
41	8" Cleanout for Perforated PVC Storm Pipe	Each	4	312.00	1,248.00
42	3" Vortex Restrictor Plate	Each	2	884.00	1,768.00
43	4" Vortex Restrictor Plate	Each	2	884.00	1,768.00
44	Catch Basin, 4' Dia.	Each	10	2,277.60	22,776.00
45	Electrical - 3/4" RGS Conduit	Linear Foot	1000	7.96	7,956.00
46	Electrical - 1" RGS Conduit	Linear Foot	750	14.25	10,686.00
47	Electrical - 1-1/4" RGS Conduit	Linear Foot	1000	17.06	17,056.00
48	Electrical - Site Lighting Pole Base	Each	6	1,196.00	7,176.00
49	Brick Pier Foundation	Each	17	399.46	6,790.89
50	Relocation of Existing Construction Site Fencing	Linear Foot	2350	6.76	15,886.00
51	New Construction Site Fencing with Mesh	Linear Foot	2350	18.20	42,770.00

PUBLIC BUILDING COMMISSION OF CHICAGO

Contract No. 1448

	TYPE OF WORK	UNIT(S)	Approx Qty	Unit Price	Extended Price (qty x unit price)
52.	New 24' Construction Site Gate and Temporary Drive	Pair	4	832.00	3,328.00
53.	Geotextile Filter Fabric	Square Foot	25000	0.26	6,500.00
54.	Permeable Paver Sub-Base Material (CA-1)	Cubic Yard	770	37.44	28,828.80
55.	Permeable Paver Base Material (CA-7)	Cubic Yard	580	39.52	22,921.60
56.	Asphalt Aggregate Base Course (CA-6)	Cubic Yard	1200	52.00	62,400.00
57.	Curb and Gutter	Linear Foot	4200	17.68	74,256.00
58.	5" Thick Concrete Sidewalk Replacement	Square Foot	1000	4.68	4,680.00
59.	Concrete Retaining Wall	Linear Foot	100	75.14	7,514.00
60.	Winterize RPZ Valve / Irrigation System	Lump Sum	1	3,120.00	3,120.00
61.	Landscape Planting Soil	Cubic Yard	6000	36.40	218,400.00
62.	Soils Erosion Control -Temporary Hydroseeding	Square Foot	45000	0.52	23,400.00
63.	Soils Erosion Control -at Storm Structure	Each	9	260.00	2,340.00
64.	DELETED-LEAVE BLANK				
65.	Temporary Street Closure Barricade	Each	7	520.00	3,640.00
66.	Manhole	Each	1	1,976.00	1,976.00
67.	Fire Hydrant Relocation	Each	1	7,592.00	7,592.00
68.	2" PVC Sleeve	Linear Foot	100	20.80	2,080.00
69.	1-1/4" PVC Irrigation Pipe	Linear Foot	250	16.64	4,160.00

UNIT PRICES SUB-TOTAL (A) (insert unit prices sub total (A) on page 13)					\$ 1,874,949.75
---	--	--	--	--	------------------------

Notes:

1. "Unbalanced Bids" - Bidders pricing for each line item should carry its share of the cost of the work, plus its share of overhead and profit. Bidders should avoid nominal pricing for some line items and enhanced pricing for other lines. Bids that the Commission considers to be materially unbalanced will be rejected.
2. "Disposal Sites" - As stipulated in Specification Section #02064, obtain and provide copies of all written authorizations from licensed/permitted construction and demolition debris disposal sites and land fills for the disposal of excavated materials from the site. The authorizations must be signed/executed by the disposal facilities representatives, and state that the site complies with all local zoning codes, State, Federal, and local laws, rules, and regulations. Contractor shall submit the name and address of minimum of three (3) disposal facilities that will be utilized for this project. The written authorizations from the three (3) disposal facilities must be submitted with Contractors' bid.

PUBLIC BUILDING COMMISSION OF CHICAGO
Contract No. 1448

SCHEDULE B - Joint Venture Affidavit
(1 of 3)

N/A

This form need not be filled in if all joint venturers are MBE/WBE firms. In such case, however, a written joint venture agreement among the MBE/WBE firms should be submitted. Each MBE/WBE joint venturer must also attach a copy of their current certification letter.

1. Name of joint venture _____
2. Address of joint venture _____

3. Phone number of joint venture _____
4. Identify the firms that comprise the joint venture

- A. Describe the role(s) of the MBE/WBE firm(s) in the joint venture. (Note that a "clearly defined portion of work" must here be shown as under the responsibility of the MBE/WBE firm.)

- B. Describe very briefly the experience and business qualifications of each non-MBE/WBE joint venturer.

5. Nature of joint venture's business

6. Provide a copy of the joint venture agreement.
7. Ownership: What percentage of the joint venture is claimed to be owned by MBE/WBE? _____ %
8. Specify as to:
 - A. Profit and loss sharing _____ %
 - B. Capital contributions, including equipment _____ %
 - C. Other applicable ownership interests, including ownership options or other agreements which restrict ownership or control.

 - D. Describe any loan agreements between joint venturers, and identify the terms thereof.

PUBLIC BUILDING COMMISSION OF CHICAGO

Contract No. 1448

SCHEDULE B - Joint Venture Affidavit (2 of 3)

N/A

9. Control of and participation in this Contract: Identify by name, race, sex, and "firm" those individuals (and their titles) who are responsible for day-to-day management and policy decision making, including, but not limited to, those with prime responsibility for:

A. Financial decisions

B. Management decisions such as:

1) Estimating

2) Marketing and Sales

3) Hiring and firing of management personnel

4) Other

C. Purchasing of major items or supplies

D. Supervision of field operations

E. Supervision of office personnel

F. Describe the financial controls of the joint venture, e.g., will a separate cost center be established; which venturer will be responsible for keeping the books; how will the expense therefor be reimbursed; the authority of each joint venturer to commit or obligate the other. Describe the estimated contract cash flow for each joint venturer.

G. State approximate number of operational personnel, their craft and positions, and whether they will be employees of the majority firm or the joint venture.

10. Please state any material facts of additional information pertinent to the control and structure of this joint venture.

PUBLIC BUILDING COMMISSION OF CHICAGO

Contract No. 1448

SCHEDULE B - Joint Venture Affidavit (3 of 3)

N/A

THE UNDERSIGNED SWEAR THAT THE FOREGOING STATEMENTS ARE CORRECT AND INCLUDE ALL MATERIAL INFORMATION NECESSARY TO IDENTIFY AND EXPLAIN THE TERMS AND OPERATIONS OF OUR JOINT VENTURE AND THE INTENDED PARTICIPATION BY EACH JOINT VENTURER IN THE UNDERTAKING. FURTHER, THE UNDERSIGNED COVENANT AND AGREE TO PROVIDE TO THE PUBLIC BUILDING COMMISSION OF CHICAGO CURRENT, COMPLETE AND ACCURATE INFORMATION REGARDING ACTUAL JOINT VENTURE WORK AND THE PAYMENT THEREFOR AND ANY PROPOSED CHANGES IN ANY OF THE JOINT VENTURE AGREEMENTS AND TO PERMIT THE AUDIT AND EXAMINATION OF THE BOOKS, RECORDS, AND FILES OF THE JOINT VENTURE, OR THOSE OF EACH JOINT VENTURER RELEVANT TO THE JOINT VENTURE, BY AUTHORIZED REPRESENTATIVES OF THE COMMISSION. ANY MATERIAL MISREPRESENTATION WILL BE GROUNDS FOR TERMINATING ANY CONTRACT WHICH MAY BE AWARDED AND FOR INITIATING ACTION UNDER FEDERAL OR STATE LAWS CONCERNING FALSE STATEMENTS.

Note: If, after filing this Schedule B and before the completion of the joint venture's work on this Contract, there is any significant change in the information submitted, the joint venture must inform the Public Building Commission of Chicago, either directly or through the General contractor if the joint venture is a subcontractor.

Name of Joint Venturer

Name of Joint Venturer

Signature

Signature

Name

Name

Title

Title

Date

Date

State of _____ County of _____

State of _____ County of _____

On this _____ day of _____, 20____, before me appeared (Name)

On this _____ day of _____, 20____, before me appeared (Name)

to me personally known, who, being duly sworn, did execute the foregoing affidavit, and did state that he or she was properly authorized by (Name of Joint Venture)

to me personally known, who, being duly sworn, did execute the foregoing affidavit, and did state that he or she was properly authorized by (Name of Joint Venture)

to execute the affidavit and did so as his or her free act and deed.

to execute the affidavit and did so as his or her free act and deed.

Notary Public

Notary Public

Commission expires: (SEAL)

Commission expires: (SEAL)

PUBLIC BUILDING COMMISSION OF CHICAGO
Contract No. 1448

SCHEDULE C - Letter of Intent from MBE/WBE
To Perform As
Subcontractor, Subconsultant, and/or Material Supplier (1 of 2)

SCHEDULE C AND SUPPORTING DOCUMENTS MUST BE
SUBMITTED WITH BID

Name of Project: 7th District Police Station, Site Work and Underground Utilities

Project Number: 1448

FROM:

Old Veteran Construction, Inc. MBE WBE
(Name of MBE or WBE)

TO:

Old Veteran Construction, Inc. and Public Building Commission of Chicago
(Name of General Bidder)

The undersigned intends to perform work in connection with the above-referenced project as (check one):

a Sole Proprietor a Corporation
 a Partnership a Joint Venture

The MBE/WBE status of the undersigned is confirmed by the attached Letter of Certification, dated 9/12/05. In addition, in the case where the undersigned is a Joint Venture with a non-MBE/WBE firm, a Schedule B, Joint Venture Affidavit, is provided.

The undersigned is prepared to provide the following described services or supply the following described goods in connection with the above-named project.

General Contracting

The above-described services or goods are offered for the following price, with terms of payment as stipulated in the Contract Documents.

173,208.34

PUBLIC BUILDING COMMISSION OF CHICAGO
Contract No. 1448

SCHEDULE C - Letter of Intent from MBE/WBE
To Perform As
Subcontractor, Subconsultant, and/or Material Supplier (2 of 2)

PARTIAL PAY ITEMS

For any of the above items that are partial pay items, specifically describe the work and subcontract dollar amount:

N/A

If more space is needed to fully describe the MBE/WBE firm's proposed scope of work and/or payment schedule, attach additional sheet(s).

SUB-SUBCONTRACTING LEVELS

0 % of the dollar value of the MBE/WBE subcontract will be sublet to non-MBE/WBE contractors.

0 % of the dollar value of the MBE/WBE subcontract will be sublet to MBE/WBE contractors.

If MBE/WBE subcontractor will not be sub-subcontracting any of the work described in this Schedule, a zero (0) must be filled in each blank above. If more than 10% percent of the value of the MBE/WBE subcontractor's scope of work will be sublet, a brief explanation and description of the work to be sublet must be provided.

The undersigned will enter into a formal agreement for the above work with the General Bidder, conditioned upon its execution of a contract with the Public Building Commission of Chicago, and will do so within five (5) working days of receipt of a notice of Contract award from the Commission.

By:

Old Veteran Construction, Inc.

Name of MBE/WBE Firm (Print)
8/22/06

Date
773/821-9900

Phone

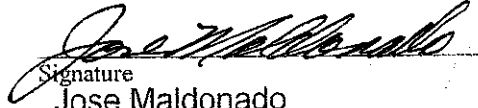
Signature
Jose Maldonado
Name (Print)

IF APPLICABLE: N/A
By:

Joint Venture Partner (Print)

Date

Phone

Signature

Name (Print)

MBE ___ WBE ___ Non-MBE/WBE ___



City of Chicago
Richard M. Daley, Mayor

Department of
Procurement Services

Mary A. Dempsey
Interim Chief Procurement Officer

City Hall, Room 403
121 North LaSalle Street
Chicago, Illinois 60602
(312) 744-4900
(312) 744-2949 (TTY)
<http://www.cityofchicago.org>

September 12, 2005

Jose Maldonado, President
Old Veteran Construction, Inc.
10942 So. Halsted Street
Chicago, Illinois 60628

Annual Certificate Expires:
Vendor Number:

October 1, 2006
1036761

Dear Mr. Maldonado:

We are pleased to inform you that Old Veteran Construction, Inc. has been certified as a MBE/WBE by the City of Chicago. This MBE certification is valid until October 2010; however your firm must be re-validated annually. Your firm's next annual validation is required by October 1, 2006.

As a condition of continued certification during this five year period, you must file a No-Change Affidavit within 60 days prior to the date of expiration. Failure to file this Affidavit will result in the termination of your certification. Please note that you must include a copy of your most current Federal Corporate Tax Return. You must also notify the City of Chicago of any changes in ownership or control of your firm or any other matters or facts affecting your firm's eligibility for certification.

The City may commence action to remove your firm's eligibility if you fail to notify us of any changes of facts affecting your firm's certification or if your firm otherwise fails to cooperate with the City in any inquiry or investigation. Removal of eligibility procedures may also be commenced if your firm is found to be involved in bidding or contractual irregularities.

Your firm's name will be listed in the City's Directory of Minority Business Enterprises and Women Business Enterprises in the specialty area(s) of:

Miscellaneous Concrete (Exclusive of Public Walkways); Tuckpointing; Brick Steam-Cleaning and Caulking; General Contractor

Your firm's participation on City contracts will be credited only toward MBE goals in your area(s) of specialty. While your participation on City contracts is not limited to your specialty, credit toward MBE goals will be given only for work done in the specialty category.

Thank you for your continued interest in the City's Minority and Women Business Enterprise Programs.

Sincerely,

David Grossman
Managing Deputy, Certification and Compliance

DG/emc



PUBLIC BUILDING COMMISSION OF CHICAGO
Contract No. 1448

**SCHEDULE C - Letter of Intent from MBE/WBE
To Perform As
Subcontractor, Subconsultant, and/or Material Supplier (1 of 2)**

**SCHEDULE C AND SUPPORTING DOCUMENTS MUST BE
SUBMITTED WITH BID**

Name of Project: 7TH DISTRICT POLICE STATION SITE WORK

Project Number: 1448

FROM:

T & D EXCAVATION AND GRADING, INC. MBE WBE
(Name of MBE or WBE)

TO:

_____ and Public Building Commission of Chicago
(Name of General Bidder)

The undersigned intends to perform work in connection with the above-referenced project as (check one):

_____ a Sole Proprietor a Corporation
_____ a Partnership _____ a Joint Venture

The MBE/WBE status of the undersigned is confirmed by the attached Letter of Certification, dated NOVEMBER 15, 2005. In addition, in the case where the undersigned is a Joint Venture with a non-MBE/WBE firm, a Schedule B, Joint Venture Affidavit, is provided.

The undersigned is prepared to provide the following described services or supply the following described goods in connection with the above-named project.

EXCAVATION

The above-described services or goods are offered for the following price, with terms of payment as stipulated in the Contract Documents.

\$245,900⁰⁰

PUBLIC BUILDING COMMISSION OF CHICAGO

Contract No. 1448

SCHEDULE C - Letter of Intent from MBE/WBE
To Perform As
Subcontractor, Subconsultant, and/or Material Supplier (2 of 2)

PARTIAL PAY ITEMS

For any of the above items that are partial pay items, specifically describe the work and subcontract dollar amount:

N/A

If more space is needed to fully describe the MBE/WBE firm's proposed scope of work and/or payment schedule, attach additional sheet(s).

SUB-SUBCONTRACTING LEVELS

% of the dollar value of the MBE/WBE subcontract will be sublet to non-MBE/WBE contractors.

% of the dollar value of the MBE/WBE subcontract will be sublet to MBE/WBE contractors.

If MBE/WBE subcontractor will not be sub-subcontracting any of the work described in this Schedule, a zero (0) must be filled in each blank above. If more than 10% percent of the value of the MBE/WBE subcontractor's scope of work will be sublet, a brief explanation and description of the work to be sublet must be provided.

The undersigned will enter into a formal agreement for the above work with the General Bidder, conditioned upon its execution of a contract with the Public Building Commission of Chicago, and will do so within five (5) working days of receipt of a notice of Contract award from the Commission.

By:

T & D EXCAVATION AND GRADING, INC.

Name of MBE/WBE Firm (Print)

8-25-2006

Date

630-543-4400

Phone

Signature

MOHAMMED YASEEN, V.P.

Name (Print)

IF APPLICABLE:

By:

Joint Venture Partner (Print)

Signature

Date

Name (Print)

MBE ___ WBE ___ Non-MBE/WBE ___

Phone



City of Chicago
Richard M. Daley, Mayor

Department of
Procurement Services

Barbara A. Lumpkin
Chief Procurement Officer

City Hall, Room 403
121 North LaSalle Street
Chicago, Illinois 60602
(312) 744-4900
(312) 744-2949 (TTY)
<http://www.cityofchicago.org>

November 15, 2005

Willie Ross, President
T & D Excavation and Grading, Inc.
20 W 327 Belmont Place
Addison, Illinois 60101

Dear Mr. Ross:

The City of Chicago Department of Procurement Services ("Department") has undertaken an evaluation of procurement policies and procedures including those utilized within the M/WBE and DBE certification unit. In light of this evaluation and in anticipation of streamlining our procedures, the Department extends your **MBE certification until September 1, 2006**.

The Department may request additional information from you prior to the expiration of the courtesy period. This information will assist us in making a determination on the recertification of your company. You will receive additional information from the Department in the coming days.

As you know, your firm's participation on contracts will be credited only toward **MBE** in the following specialty area(s):

Demolition and Excavation Services

If you have any questions, please contact our office at 312-742-0766.

Sincerely,

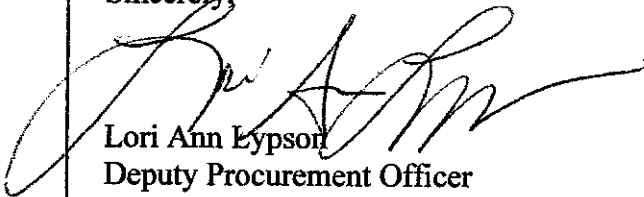

Lori Ann Eypson
Deputy Procurement Officer

gk



CMS

ILLINOIS

Rod R. Blagojevich, Governor

DEPARTMENT OF CENTRAL MANAGEMENT SERVICES

Michael M. Rumman, Director

March 24, 2005

Vendor Number: 364210647

Mohammed Yaseen on
T&D Excavation and Grading
20 W. 327 Belmont Pl.
Addison, IL 60101 00

Re: MBE Recertification

Dear Vendor:

After reviewing the information supplied by you, we are pleased to advise you that your company has been granted recertification as a minority business enterprise (MBE) under the Business Enterprise Program for Minorities, Females, and Persons with Disabilities (BEP) Act. This certification is valid for two years from the date of this letter.

Should any changes occur in ownership and/or control of the business or other changes affecting the firm's operation, you are required to notify this office within two weeks of such changes. Failure to notify the office of the changes will result in decertification.

Please keep in mind this recertification does not guarantee any contracts, however, it does assure your firm the opportunity to participate in the State's procurement process.

If you have any questions, please contact our office at (312) 814-4190 (Voice/TDD); (800) 356-9206 (in Illinois only); (800) 526-0844 (Illinois Relay Line for the Hearing Impaired); or by Fax (312) 814-5539.

Sincerely,

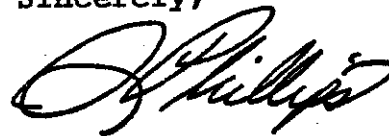

Sondra N. Phillips
Director
Business Enterprise Program
for Minorities, Females, and
Persons with Disabilities

SNP:pm (L29MBE)

100 W Randolph St Ste 3-350, Chicago IL 60601-3274

Printed on Recycled Paper

PUBLIC BUILDING COMMISSION OF CHICAGO
Contract No. 1449

SCHEDULE C - Letter of Intent from MBE/WBE
To Perform As
Subcontractor, Subconsultant, and/or Material Supplier (1 of 2)

**SCHEDULE C AND SUPPORTING DOCUMENTS MUST BE
SUBMITTED WITH BID**

Name of Project: WINNEMAC PARK

Project Number: _____

FROM:

SANCHEZ PAVING
(Name of MBE or WBE)

MBE WBE _____

TO:

_____ and Public Building Commission of Chicago
(Name of General Bidder)

The undersigned intends to perform work in connection with the above-referenced project as (check one):

_____ a Sole Proprietor
_____ a Partnership

_____ a Corporation
_____ a Joint Venture

The MBE/WBE status of the undersigned is confirmed by the attached Letter of Certification, dated NOV. 1, 2006. In addition, in the case where the undersigned is a Joint Venture with a non-MBE/WBE firm, a Schedule B, Joint Venture Affidavit, is provided.

The undersigned is prepared to provide the following described services or supply the following described goods in connection with the above-named project.

ASPHALT PAVING

The above-described services or goods are offered for the following price, with terms of payment as stipulated in the Contract Documents.

PUBLIC BUILDING COMMISSION OF CHICAGO

Contract No. 1449

**SCHEDULE D - Affidavit of General Contractor Regarding MBE/WBE Participation
(2 of 2)**

SUB-SUBCONTRACTING LEVELS

0 % of the dollar value of the MBE/WBE subcontract will be sublet to non-MBE/WBE contractors.

0 % of the dollar value of the MBE/WBE subcontract will be sublet to MBE/WBE contractors.

If MBE/WBE subcontractor will not be sub-subcontracting any of the work described in this Schedule, a zero (0) must be filled in each blank above.

If more than 10% of the value of the MBE/WBE subcontractor's scope of work will be sublet, a brief explanation and description of the work to be sublet must be provided.

The undersigned will enter into a formal agreement for the above work with the above-referenced MBE/WBE firms, conditioned upon performance as Contractor of a Contract with the Commission, and will do so within five (5) business days of receipt of a notice of Contract award from the Commission.

By:

Sanchez PAVING

Name of Contractor (Print)

8-23-06

Date

7083331300

Phone

O. Sanchez

Signature

OTONIEL SANCHEZ

Name (Print)

IF APPLICABLE:

By:

Joint Venture Partner (Print)

Date

Phone/FAX

Signature

Name (Print)

MBE ___ WBE ___ Non-MBE/WBE ___



City of Chicago
Richard M. Daley, Mayor

Department of
Procurement Services

Barbara A. Lumpkin
Chief Procurement Officer

City Hall, Room 403
121 North LaSalle Street
Chicago, Illinois 60602
(312) 744-4900
(312) 744-2949 (TTY)
<http://www.cityofchicago.org>

January 19, 2006

Otoniel Sanchez
Sanchez Paving Company, Inc.
16309 S. Crawford
Markham, Illinois 60426

Dear Mr. Sanchez:

The City of Chicago Department of Procurement Services ("Department") has undertaken an evaluation of procurement policies and procedures including those utilized within the M/WBE and DBE certification unit. In light of this evaluation and in anticipation of streamlining our procedures, the Department extends your MBE certification until November 1, 2006.

The Department may request additional information from you prior to the expiration of the courtesy period. This information will assist us in making a determination on the recertification of your company. You will receive additional information from the Department in the coming days.

As you know, your firm's participation on contracts will be credited only toward MBE in the following specialty area(s):

Asphalt Paving, Snow Removal and Excavating

If you have any questions, please contact our office at 312-742-0766.

Sincerely,

Lori Ann Lyson
Deputy Procurement Officer

mck

NEIGHBORHOODS

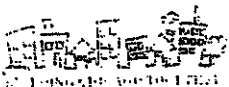

PUBLIC BUILDING COMMISSION OF CHICAGO
CONTRACT NO 1448

SCHEDULE C-Letter of Intent from MBE/WBE
To Perform As
Subcontractor, Subconsultant, and/or Material Supplier (1of 2)

SCHEDULE C AND SUPPORTING DOCUMENTS MUST BE
SUBMITTED WITH BID

Name of Project: 7TH DISTRICT POLICE STATION
Project Number: 1448

FROM:
ARC UNDERGROUND, INC. MBE _____ WBE X
(Name of MBE or WBE)

TO:
OLD VETERAN CONSTRUCTION INC. and Public Building Commission of Chicago
(Name of General Bidder)

the undersigned intends to perform work in connection with the above-referenced project as (check one):

_____ a Sole Proprietor X _____ a Corporation
_____ a Partnership _____ A Joint Venture

The MBE/WBE status of the undersigned is confirmed by the attached Letter of Certification, dated 9/1/2006. In addition, in the case where the undersigned is a Joint Venture with a non-MBE/WBE firm, a Schedule B, Joint Venture Affidavit, is provided.

The undersigned is prepared to provide the following described services or supply the following described goods in connection with the above-named project.

_____ **SITE CONCRETE** _____

The above-described services or goods are offered for the following price, with terms of payment as stipulated in the Contract Documents.

_____ **\$89,655.00** _____

PUBLIC BUILDING COMMISSION OF CHICAGO
CONTRACT NO 1448

SCHEDULE C-Letter of Intent from MBE/WBE
To Perform As
Subcontractor, Subconsultant, and/or Material Supplier (1 of 2)

SCHEDULE C AND SUPPORTING DOCUMENTS MUST BE
SUBMITTED WITH BID

PARTIAL PAY ITEMS

For any of the above items that are partial pay items, specifically describe the work and subcontract dollar amount:

If more space is needed to fully describe the MBE/WBE firm's proposed scope of work and/or payment schedule, attached additional sheet(s).

SUB-SUBCONTRACTING LEVELS

0 % of the dollar value of the MBE/WBE subcontract will be sublet to non-MBE/WBE contractors.

0 % of the dollar value of the MBE/WBE subcontract will be sublet to MBE/WBE contractors.

If MBE/WBE subcontractor will not be sub-subcontracting any of the work described in this Schedule, a zero (0) must be filled in each blank above. If more than 10% percent of the value of the MBE/WBE subcontractor's scope of work will be sublet, a brief explanation and description of the work to be sublet must provided.

The undersigned will enter into a formal agreement for the above work with the General Bidder, conditioned upon its execution of a contract with the Public Building Commission of Chicago, and will do so within five (5) working days of receipt of a notice of Contract award from the Commission.

ARC UNDERGROUND, INC.

Name of MBE/WBE Firm (Print)

August 22, 2006

Date

773-235-4648

Phone

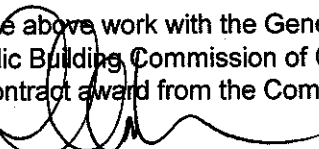

Signature

CHRISTINE M. SAVOIA

Name (Print)

IF APPLICABLE:

By:

Joint Venture Partner (Print)

Signature

Date

Name (Print)

MBE _____ WBE _____ None-MBE/WBE _____

Phone



City of Chicago
Richard M. Daley, Mayor

Department of
Procurement Services

Barbara A. Lumpkin
Chief Procurement Officer

City Hall, Room 403
121 North LaSalle Street
Chicago, Illinois 60602
(312) 744-4900
(312) 744-2949 (TTY)
<http://www.cityofchicago.org>

November 29, 2005

Christine Savoia, President
ARC Underground, Inc.
2114 West Thomas Street
Chicago, Illinois 60622

Dear Ms. Savoia:

The City of Chicago Department of Procurement Services ("Department") has undertaken an evaluation of procurement policies and procedures including those utilized within the M/WBE and DBE certification unit. In light of this evaluation and in anticipation of streamlining our procedures, the Department extends your DBE/WBE certification until **September 1, 2006.**

The Department may request additional information from you prior to the expiration of the courtesy period. This information will assist us in making a determination on the recertification of your company. You will receive additional information from the Department in the coming days.

As you know, your firm's participation on contracts will be credited only toward DBE/WBE goals in the following specialty area(s):

**Sewer and Drain Contractor; Miscellaneous Concrete
(Exclusive of Public Walkways)**

If you have any questions, please contact our office at 312-742-0766.

Sincerely,

Lori Ann Lypson
Deputy Procurement Officer

mck



PUBLIC BUILDING COMMISSION OF CHICAGO
Contract No. 1448

SCHEDULE D - Affidavit of General Contractor Regarding MBE/WBE Participation
(1 of 2)

Name of Project: 7th District Police Station Site Work and Underground Utilities

STATE OF ILLINOIS }
 } SS
COUNTY OF COOK }

In connection with the above-captioned contract, I HEREBY DECLARE AND AFFIRM that I am the

President

Title
and duly authorized representative of

Old Veteran Construction, Inc.

Name of General Contractor
whose address is

10942 S. Halsted St.

in the City of Chicago, State of Illinois 60628

and that I have personally reviewed the material and facts submitted with the attached Schedules of MBE/WBE participation in the above-referenced Contract, including Schedule C and Schedule B (if applicable), and the following is a statement of the extent to which MBE/WBE firms will participate in this Contract if awarded to this firm as the Contractor for the Project.

Name of MBE/WBE Contractor	Type of Work to be Done in Accordance with Schedule C	Dollar Credit Toward MBE/WBE Goals	
		MBE	WBE
Old Veteran Construction, Inc.	General Contracting	\$173,208.34	\$
Sanchez Paving	Paving	\$126,600.00	\$
T & D Excavating	Excavating	\$ 245,960.00	\$
ARC Underground	Concrete	\$	\$ 89,655.00
		\$	\$
		\$	\$
		\$	\$
Total Net MBE/WBE Credit		\$ 545,768.34	\$ 89,655.00
Percent of Total Base Bid		27.67 %	4.55 %

The General Contractor may count toward its MBE/WBE goal a portion of the total dollar value of a contract with a joint venture equal to the percentage of the ownership and control of the MBE/WBE partner.

PUBLIC BUILDING COMMISSION OF CHICAGO
Contract No. 1448

SCHEDULE D - Affidavit of General Contractor Regarding MBE/WBE Participation
(2 of 2)

SUB-SUBCONTRACTING LEVELS

0 % of the dollar value of the MBE/WBE subcontract will be sublet to non-MBE/WBE contractors.

0 % of the dollar value of the MBE/WBE subcontract will be sublet to MBE/WBE contractors.

If MBE/WBE subcontractor will not be sub-subcontracting any of the work described in this Schedule, a zero (0) must be filled in each blank above.

If more than 10% of the value of the MBE/WBE subcontractor's scope of work will be sublet, a brief explanation and description of the work to be sublet must be provided.

The undersigned will enter into a formal agreement for the above work with the above-referenced MBE/WBE firms, conditioned upon performance as Contractor of a Contract with the Commission, and will do so within five (5) business days of receipt of a notice of Contract award from the Commission.

By:

Old Veteran Construction, Inc.

Name of Contractor (Print)

August 22, 2006

Date

773/821-9900

Phone

IF APPLICABLE: N/A

By:

Joint Venture Partner (Print)

Date

Phone/FAX



Signature

Jose Maldonado

Name (Print)

Signature

Name (Print)

MBE ___ WBE ___ Non-MBE/WBE ___

PUBLIC BUILDING COMMISSION OF CHICAGO
Contract No. 1448

SCHEDULE E - Request for Waiver from MBE/WBE Participation

Date: _____ N/A

Montel M. Gayles, Executive Director
Public Building Commission of Chicago
Richard J. Daley Center
50 W. Washington Street, Room 200
Chicago, IL 60602

Dear Mr. Gayles:

RE: Contract No. _____

Project Title: _____

In accordance with Section 23.01.10, the undersigned hereby requests a waiver/partial waiver from the MBE/WBE provisions of Section 23.01.10. The undersigned certifies that it/we has/have been diligent in our attempt to identify potential subcontractors certified as MBE/WBE to perform work in this project, that such efforts have not been successful, and that it/we cannot meet the Minority/Women Business Enterprise contract goal. These efforts are described below and are consistent with the "Request for Waiver" provisions of the MBE/WBE Program as detailed in Section 23.01.10 as follows:

Documentation attached: yes _____ no _____

Based on the information provided above, we request consideration of this waiver request.

Sincerely,

Signature

Print Name

Title

Name of Firm

PUBLIC BUILDING COMMISSION OF CHICAGO
Contract No. 1448

Affidavit of Uncompleted Work

A. Work Under Contract

List below all work Bidder has under contract as either a general contractor or a subcontractor, including all pending low bids not yet awarded or rejected. In a joint venture, list only that portion of the work that is the responsibility of the Bidder. The uncompleted dollar value is to be based upon the most recent estimate of the owner or engineer, and must include work subcontracted to others. If no work is contracted, indicate NONE.

	1	2	3	4	Awards Pending	TOTALS
Project	VA Bldg 5 Boiler Plant	St. Vincent De Paul Residence	South Campus UIC	Columbus School		
Contract With	Dept of Veteran Affairs	Linn-Mathes	Joseph Const	Public Building Commission		
Estimated Completion Date	1/5/07	10/1/06	10/1/06	12/06		
Total Contract Price	\$939,746.00	\$1,500,000.00	\$396,022.00	\$688,000.00		\$3,523,768.00
Uncompleted Dollar Value if Firm is the GC	\$785,258.00			\$688,000.00		\$1,473,258.00
Uncompleted Dollar Value if Firm is a Subcontractor		\$400,000.00	\$39,600.00			\$439,600.00
	TOTAL VALUE OF ALL WORK					\$1,912,858.00

B. Uncompleted Work to be Completed with the Bidder's own Forces

List below the uncompleted dollar value of work for each contract to be completed with the Bidder's own forces, including all work indicated as awards pending. All work subcontracted to others will be listed on C. of this form. In a joint venture, list only that portion of the work to be done by the Bidder. If no work is contracted, indicate NONE.

	1	2	3	4	Awards Pending	TOTALS
Earthwork	38,150					38,150
Demolition	314,905					314,905
Sewer and Drain						
Foundation						
Painting						
Struct. Steel (Bldg Const.)						
Ornamental Steel (Bldg Construction)						
Miscellaneous Concrete	7500					7500
Fireproofing						

PUBLIC BUILDING COMMISSION OF CHICAGO

Contract No. 1449

Affidavit Of Local Business

STATE OF ILLINOIS }
COUNTY OF COOK } SS

Jose Maldonado, being first duly sworn, deposes and says that:

1. He/She is President
(Owner, Partner, Officer)
of Old Veteran Construction, Inc.
(the name of the Bidder that has submitted the attached Bid);

2. Bidder, or partner with at least 50% interest in joint venture Bidder, [X] is is not a "Local Business" as defined by the provisions of Section 21.18 of the Standard Terms and Conditions (Book 1).

3. Bidder, or partner with at least 50% interest in joint venture Bidder, [] does [X] does not have business locations outside the corporate limits of the City of Chicago.

If other business locations exist, provide business addresses and phone numbers:

N/A

4. Bidder, or partner with at least 50% interest in joint venture Bidder, currently employs 28 (insert number) regular full-time people, 28 (insert number) of whom work at business location(s) within the corporate limits of the City of Chicago.

5. Bidder, or partner(s) with at least 50% interest in joint venture Bidder, [] is [X] is not subject to City of Chicago taxes.

(Signed) [Signature]

President (Title)

Subscribed and sworn to before me this 29 day of August, 20 06

(Signature) [Signature]

(SEAL)

(Title) Office Administrator

My Commission expires: 04-17-10



PUBLIC BUILDING COMMISSION OF CHICAGO
Contract No. 1448

	1	2	3	4	Awards Pending	TOTALS
Masonry		400,000	39,600	20,000		459,600
H.V.A.C.						
Mechanical						
Electrical						
Plumbing						
Roofing & Sheet Metal						
Flooring & Tile Work						
Drywall & Plaster Work						
Ceiling Construction						
Hollow Metal & Hardware						
Glazing & Caulking						
Miscellaneous Arch. Work						
Landscaping	5000			40,000		45,000
Fencing				35,000		35,000
Others (List)						
Waterproofing	7500					7500
Paving				20,000		20,000
Playground Equipment				95,000		95,000
Irrigation				25,000		25,000
Trash Compactor				30,000		30,000
Work to be Subcontracted				75,000		75,000
Misc. General Conditions				38,152		38,152
TOTALS	373,055	400,000	39,600	378,152		1,190,807

PUBLIC BUILDING COMMISSION OF CHICAGO
Contract No. 1448

C. Work Subcontracted to Others

List below all work, according to each contract on the preceding page, that the Bidder has subcontracted to others. Do NOT include work to be performed by another general contractor in a joint venture. No work may be indicated as subcontracted to others on awards pending. If no work is subcontracted, indicate NONE.

	1	2	3	4	Awards Pending
Subcontractor	Safe Environment			M-K Excavating	
Type of Work	Abatement			Earthwork	
Subcontract Price	\$58,000.00			\$52,625.00	
Amount Uncompleted	\$14,100.00			\$52,625.00	
Subcontractor	C & W Bldg			ARC Underground	
Type of Work	Plumbing			Site Utilities	
Subcontract Price	\$130,903.00			\$39,365.00	
Amount Uncompleted	\$130,903.00			\$39,365.00	
Subcontractor	Knickerbocker			Tour Turf	
Type of Work	Roofing			Artificial Turf	
Subcontract Price	\$241,700.00			\$68,047.00	
Amount Uncompleted	\$241,700.00			\$68,047.00	
Subcontractor	Knipple Iron			Hanover Specialties	
Type of Work	Structural Steel			Rubber Surfacing	
Subcontract Price	\$25,500.00			\$36,682.00	
Amount Uncompleted	\$25,500.00			\$36,682.00	
Subcontractor	Northern Weather			G & V Construction	
Type of Work	HVAC			Cast-In-Place Conc	
Subcontract Price	\$22,089.00			\$56,900.00	
Amount Uncompleted	0.00			\$56,900.00	
Subcontractor	Allied Power & Ligt			DND Electric	
Type of Work	Electrical			Electrical	
Subcontract Price	\$17,125.00			\$56,229.00	
Amount Uncompleted	0.00			\$56,229.00	
TOTAL Uncompleted	\$412,203.00			\$309,848.00	

City of Chicago
Department of Buildings
General Contractor's License

BY THE AUTHORITY OF THE CITY OF CHICAGO, THE FOLLOWING LICENSE IS HEREBY GRANTED TO:

OLD VETERAN CONSTRUCTION, INC.
10942 S. HALSTED STREET
CHICAGO, IL 60628

LICENSE CLASS: (A) CONSTRUCTION ALL PROJECTS

LICENSE NUMBER: GC04386A

CERTIFICATE NUMBER: GC04386-3

FEE: \$2,000.00

DATE ISSUED: 05/16/2006

DATE EXPIRES: 05/06/2007

THIS LICENSE IS NON-TRANSFERABLE

THIS LICENSE IS ISSUED AND ACCEPTED SUBJECT TO THE REPRESENTATIONS MADE ON THE APPLICATION FOR SAID LICENSE. THIS LICENSE MAY BE SUSPENDED OR REVOKED FOR CAUSE AS PROVIDED BY LAW. THE ABOVE LICENSEE SHALL OBSERVE AND COMPLY WITH ALL LAWS, ORDINANCES, RULES AND REGULATIONS OF THE UNITED STATES, STATE OF ILLINOIS, COUNTY OF COOK, AND CITY OF CHICAGO AND ALL AGENCIES THEREOF.

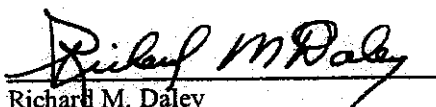
Richard M. Daley
Mayor

John E. Knight
Commissioner of Buildings

PUBLIC BUILDING COMMISSION OF CHICAGO
Contract No. 1448

Affidavit of Uncompleted Work (continued)

I, being duly sworn, do hereby declare that this affidavit is a true and correct statement relating to ALL uncompleted contracts of the undersigned for Federal, State, County, City, and private work including ALL subcontract work, ALL pending low bids not yet awarded or rejected, and ALL estimated completion dates.

Jose Maldonado
Signature

August 22, 2006

Date

Jose Maldonado

President

Name (Type or Print)

Title

Old veteran Construction, Inc.

Bidder Name

10942 S. Halsted St.

Address

Chicago

IL

60628

City

State

Zip

Subscribed and sworn to before me
this 22 day of August, 20 06

Joann M Zajac
Notary Public

(SEAL)

Commission expires: 11/15/06

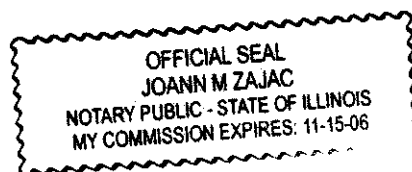

City of Chicago
Department of Buildings
General Contractor's License

BY THE AUTHORITY OF THE CITY OF CHICAGO, THE FOLLOWING LICENSE IS HEREBY GRANTED TO:

OLD VETERAN CONSTRUCTION, INC.
10942 S. HALSTED STREET
CHICAGO, IL 60628

LICENSE CLASS: (A) CONSTRUCTION ALL PROJECTS

LICENSE NUMBER: GC04386A

CERTIFICATE NUMBER: GC04386-3

FEE: \$2,000.00

DATE ISSUED: 05/16/2006

DATE EXPIRES: 05/06/2007

THIS LICENSE IS NON-TRANSFERABLE

THIS LICENSE IS ISSUED AND ACCEPTED SUBJECT TO THE REPRESENTATIONS MADE ON THE APPLICATION FOR SAID LICENSE. THIS LICENSE MAY BE SUSPENDED OR REVOKED FOR CAUSE AS PROVIDED BY LAW. THE ABOVE LICENSEE SHALL OBSERVE AND COMPLY WITH ALL LAWS, ORDINANCES, RULES AND REGULATIONS OF THE UNITED STATES, STATE OF ILLINOIS, COUNTY OF COOK, AND CITY OF CHICAGO AND ALL AGENCIES THEREOF.

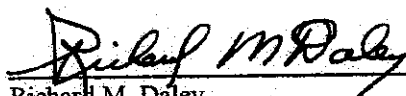
Richard M. Daley
Mayor

John E. Knight
Commissioner of Buildings

JUL 19 2006 FRI 07:05 AM T&D EXCAVATION AND GRAD I FAX NO. 6305435001

P. 02/02

To: Public Building Commission of Chicago
Chicago, IL.

From: LINCOLN LTD.

Address: 18424 S WOLF RD.
MAKENA ILL 60448

Re: Written Authorization for PBC -

Dear Sir / Madam,

We assert that our dump site and/or landfill complies with all local zoning codes, State, Federal and local laws, rules and regulations.

We are authorizing T & D Excavation and Grading, Inc, for the purposes of *bidding only*, to submit our dump site and/or landfill as an acceptable disposal site for the excavated and demolished materials from the Mt. Vernon and Mozart School Campus Parks projects. We absolve ourselves of any responsibility for accepting into our site any excavated or demolished materials until said materials have been deemed as acceptable for disposal by T & D Excavation and Grading, Inc. and our Landfill Facility..

Thank you.

Signature of Disposal Site Representative:



Name of Disposal Site Representative:

LINCOLN LTD.

Date:

7/20/06

PUBLIC BUILDING COMMISSION OF CHICAGO

Contract No. 1448

Statement Of Bidder's Qualifications

At the request of the Commission, the Bidder shall also submit additional information regarding the capability of the Bidder to perform the Contract.

Bidder Old Veteran Construction, Inc.
 Submitted By Jose Maldonado
 Title President
 Permanent Main Office Address 10942 S. Halsted St.
 Local Address Chicago, IL 60628
 Local Telephone No. and FAX No. 773/821-9900 / Fax 773/821-9911

How many years operating as contractor for work of this nature? 20

List of recently completed contracts of similar dollar value and scope of work.

	Name/Address	Dollar Amount	Year of Contract	Nature of Project
1.	2102 W. Ogden DGS	190,000.00	2005	prkg. lot rest. drainage site work
2.	1424 Iron Street DGS	150,000.00	2005	Site imprv. Landscaping
3.	Area 4 Police concrete Repairs	200,000.00	2006	Concrete deck & drainage repairs
4.	Jesse Brown VA Hospital			
5.	208 S. Damen, Chgo IL	4,992,000.00	2006	Modernization ER Dept. Site Improvement
6.				
7.	Hines VA Hospital	939,746.00	2006	Site Improvements, Boiler
8.	Chicago, IL			Plant Facility, Roofing System Waterproofing, Insulation, Remove heat exchanger

Further references can be provided upon request.

PUBLIC BUILDING COMMISSION OF CHICAGO

Contract No. 1448

Statement Of Bidder's Qualifications (continued)

The undersigned hereby authorizes any person, firm, or corporation to furnish any information requested by the Public Building Commission of Chicago in verification of this Statement of Bidder's Qualifications.

If submitted by a corporation:

- (a) Corporation Name Old Veteran Construction, Inc.
- (b) State and City in which incorporated Illinois
- (c) If incorporated in another state, is firm authorized to do business in the State of Illinois?
Yes _____ No _____
- (d) Name and address of registered agent in Illinois
Old Veteran Construction, Inc. 10942 S. Halsted St. Chicago, IL 60628

(e) Names and titles of officers authorized to sign contracts

<u>Jose Maldonado</u>	<u>President</u>
Name	Title
_____	_____
Name	Title

If submitted by a partnership:

- (a) Firm Name _____
- (b) Official Address _____
- (c) Names of all Partners: _____

If submitted by an individual:

- (a) Firm Name _____
- (b) The Owner _____
- (c) Official Address _____

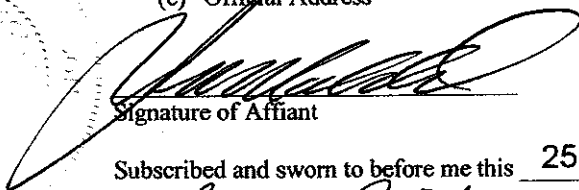
Signature of Affiant

Subscribed and sworn to before me this 25 day of August 2006

Sonia Renteria
Notary Public

(SEAL)

My Commission expires:



PUBLIC BUILDING COMMISSION OF CHICAGO

Contract No. 1448

PERFORMANCE AND PAYMENT BOND

Contract No. 1448

Bond No. B8883706

KNOW ALL MEN BY THESE PRESENTS, that we, Old Veterans Construction Inc.
a corporation organized and existing under the laws of the State of Illinois, with offices in the City of
Chicago, State of Illinois, as _____ Corporate _____ Principal, and

The Cincinnati Insurance Company

6200 S. Gilmore Road

Fairfield, OH 45014-5141

a corporation organized and existing under the laws of the State of OH _____, with offices in the State of
* OH *, as Surety, are held and firmly bound unto the Public Building Commission of Chicago,
hereinafter called "Commission", in the penal sum of One Million Nine Hundred Seventy Two Thousand
Three Hundred Dollars and Thirty Eight Cents (\$1,972,300.38) for the payment of which sum well and
truly to be made, we bind ourselves, our heirs, executors, administrators, and successors, jointly and
severally, firmly by these presents.

The condition of this obligation is such, that whereas the Principal entered into a certain Contract, hereto
attached, with the Commission, dated September 12, 2006, for the fabrication, delivery, performance and
installation of

*7th District Police Station
1400 W. 63rd Street, Chicago, IL

in the referenced project area and other miscellaneous work collateral thereto.

NOW, THEREFORE, if the Principal shall well and truly perform and fulfill all the undertakings,
covenants, terms, conditions, and agreements of said Contract during the original term of said Contract and
any extension thereof that may be granted by the Commission, with or without notice to the Surety, and
during the life of any guarantee required under the Contract, and shall also well and truly perform and
fulfill all the undertakings, covenants, terms, conditions and agreements of any and all authorized
modifications of said Contract that may be made; and also if the Principal shall promptly pay all persons,
firms, and corporations supplying labor, materials, facilities, or services in the prosecution of the work
provided for in the Contract, and any and all duly authorized modifications of said Contract that may be
made, notice of which modifications being hereby waived; and also, if the Principal shall fully secure and
protect the said Commission, its legal successor and representative, from all liability in the premises and
from all loss or expense of any kind, including all costs of court and attorney's fees, made necessary or
arising from the failure, refusal, or neglect of the aforesaid Principal to comply with all the obligations

PUBLIC BUILDING COMMISSION OF CHICAGO

Contract No. 1448

assumed by said Principal or any subcontractors in connection with the performance of said Contract and all such modifications thereof; and also, if the Principal shall deliver all Work called for by said Contract of the Principal with the Commission, free and clear of any and all claims, liens and expenses of any kind or nature whatsoever, and in accordance with the terms and provisions of said Contract, and any and all modifications of said Contract; then, this said Bond shall become null and void; otherwise it shall remain in full force and effect.

The Surety does further hereby consent and yield to the jurisdiction of the State Civil Courts of the County of Cook, City of Chicago, and State of Illinois, and does hereby formally waive any plea of jurisdiction on account of the residence elsewhere of the Surety. The Principal and Surety severally and jointly agree that this Bond, and the undertakings contained herein, are also for the benefit of any and all subcontractors and other persons furnishing materials, labor, facilities, or services to the Principal or for the performance by the Principal of said Contract with the Commission as originally executed by said Principal and the Commission or as thereafter modified, and that any such subcontractor or persons furnishing labor, materials, facilities, or services may bring suit on this Bond, or any undertaking herein contained, in the name of the Commission against the said Principal and Surety or either of them.

It is expressly understood and agreed that this Bond, in the penal sum of One Million Nine Hundred Seventy Two Thousand Three Hundred Dollars and Thirty Eight Cents (\$ 1,972,300.38), shall secure the payment of all sums due of and by the Principal under the Contract, and guarantee the faithful performance of the Contract.

No modifications, omissions, or additions, in or to the terms of said Contract, the plans or specifications, or in the manner and mode of payment shall in any manner affect the obligations of the Surety in connection with aforesaid Contract. Notice to the Surety of any and all modifications in said Contract of the Principal with the Commission and of any additions or omissions to or from said Contract are hereby expressly waived by the Surety.

PUBLIC BUILDING COMMISSION OF CHICAGO
Contract No. 1448

IN WITNESS WHEREOF, the above bounden parties have executed this instrument under their several seals this 9/19/2006 -, the name and corporate seal of each corporate party being hereto affixed and these presents duly signed by its undersigned representative pursuant to authority of its governing body.

WITNESS:

Name BY _____ (Seal)
Individual Principal

Business Address _____ (Seal)
Individual Principal

City _____ State _____

CORPORATE SEAL

ATTEST:

BY [Signature]
Secretary
Title

Old Veterans Construction, Inc.
Corporate Principal
BY [Signature]
President
Title

10942 S. Halsted St.
Chicago, IL 60628

BY Deborah L. Gems
Deborah L. Gems
6200 S. Gilmore, Fairfield OH
Business Address & Telephone
(630) 694-5461

The Cincinnati Insurance Company
Corporate Surety
Attorney in Fact
Title
CORPORATE SEAL

FOR CLAIMS (Please Print):
Contact Name: Claims Dept.
Business Address: 6200 S. Gilmore Road, Fairfield, OH 45014-5141
Telephone: 513-870-2412 Fax: 513-870-2093

The rate of premium of this Bond is \$ 9.00/9.00/6.30 per thousand. **
Total amount of premium charged is \$ 13,775.00 **

* The current power of attorney for the persons who sign for any surety company shall be attached to this Bond. Such power of attorney shall be sealed and certified with a "first-hand signature" by an officer of the surety. The Commission will not accept a facsimile signature.

PUBLIC BUILDING COMMISSION OF CHICAGO
Contract No. 1448

** Must be filled in by the Corporate Surety.

BOND APPROVAL

BY

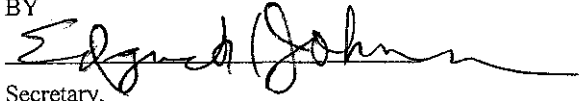

Secretary,

Public Building Commission of Chicago

CERTIFICATE AS TO CORPORATE SEAL

I, Jose Maldonado, certify that I am the Corporate Secretary of the Old Veterans Construction Inc., corporation named as Principal in the foregoing performance and payment bond, that Jose Maldonado who signed on behalf of the Principal was then President of said corporation; that I know this person's signature, and the signature is genuine; and that the Bond was duly signed, sealed, and attested, for and in behalf of said corporation by authority of its governing body.

Dated this 20 day of sep 2006.

CORPORATE SEAL

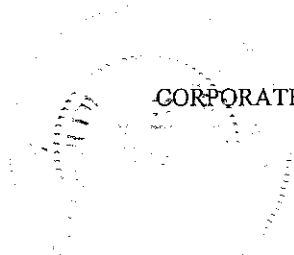

THE CINCINNATI INSURANCE COMPANY

Fairfield, Ohio

POWER OF ATTORNEY

KNOW ALL MEN BY THESE PRESENTS: That THE CINCINNATI INSURANCE COMPANY, a corporation organized under the laws of the State of Ohio, and having its principal office in the City of Fairfield, Ohio, does hereby constitute and appoint

Deborah L. Gems

of Oswego, Illinois

its true and lawful Attorney(s)-in-Fact to sign, execute, seal, and deliver on its behalf as Surety, and as its act and deed, any and all bonds, policies, undertakings, or other like instruments, as follows:

Any such obligations in the United States, in any amount.

This appointment is made under and by authority of the following resolution passed by the Board of Directors of said Company at a meeting held in the principal office of the Company, a quorum being present and voting, on the 6th day of December, 1958, which resolution is still in effect:

"RESOLVED, that the President or any Vice President be hereby authorized, and empowered to appoint Attorneys-in-Fact of the Company to execute any and all bonds, policies, undertakings, or other like instruments on behalf of the Corporation, and may authorize any officer or any such Attorney-in-Fact to affix the corporate seal; and may with or without cause modify or revoke any such appointment or authority. Any such writings so executed by such Attorneys-in-Fact shall be binding upon the Company as if they had been duly executed and acknowledged by the regularly elected officers of the Company."

"RESOLVED, that the signature of the President or a Vice President and the seal of the Company may be affixed by facsimile on any power of attorney granted, and the signature of the Secretary and Treasurer and the seal of the Company may be affixed by facsimile to any certificate of any such power of certificate bearing such facsimile signature and seal shall be valid and binding on the Company. Any such power so executed and sealed shall, with respect to any bond or undertaking to which it is attached, continue to be valid and binding on the Company."

IN WITNESS WHEREOF, THE CINCINNATI INSURANCE COMPANY has caused these presents to be sealed with its corporate seal, duly attested by its Senior Vice President or Vice President this 1st day of October, 2004.

THE CINCINNATI INSURANCE COMPANY

Thomas H. Kelly
Thomas H. Kelly
Vice President

STATE OF OHIO) ss:
COUNTY OF BUTLER)

On this 1st day of October, 2004 before me came the above-named Senior Vice President or Vice President of THE CINCINNATI INSURANCE COMPANY, to me personally known to be the officer described herein; and acknowledged that the seal affixed to the preceding instrument is the corporate seal of said Company and the corporate seal and the signature of the officer were duly affixed and subscribed to said instrument by the authority and direction of said corporation.

JANIS METZ
Notary Public, State of Ohio
My Commission Expires 01-31-06

Janis Metz

I the undersigned Secretary or Assistant Secretary of THE CINCINNATI INSURANCE COMPANY, hereby certify that the above is the Original Power of Attorney issued by said Company, and do hereby further certify that the said Power of Attorney is still in full force and effect.

GIVEN under my hand and seal of said Company at Fairfield, Ohio.
this 19 day of September 2006

Gregory J. Schloemer
Gregory J. Schloemer
Assistant Secretary

SURETY COMPANY ACKNOWLEDGMENT

STATE OF ILLINOIS)
COUNTY OF DUPAGE) ss:

On this 19 day September in the year 2006, before me personally came Deborah L. Gems to me known, who, being by me duly sworn, did depose and say that she resides in Oswego, IL; that she is the ATTORNEY-IN-FACT of the The Cincinnati Insurance Company the corporation described in and which executed the above instrument; that he knows the seal of said corporation; that the seal affixed to said instrument is such corporate seal; that it was so affixed by order of the board of directors of said corporation, and that he signed his name thereto by like order.

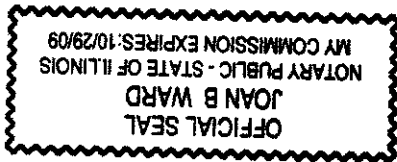

Joan B Ward

Notary Public

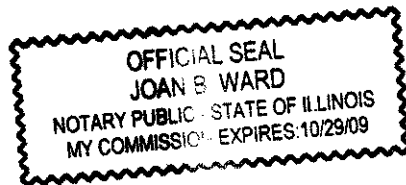

DISCLOSURE OF RETAINED PARTIES

A. Definitions and Disclosure Requirements

1. As used herein, "Contractor" means a person or entity who has any contract or lease with the Public Building Commission of Chicago ("Commission").
2. Commission contracts and/or qualification submittals must be accompanied by a disclosure statement providing certain information about attorneys, lobbyists, consultants, subcontractors, and other persons whom the Contractor has retained or expects to retain with respect to the contract or lease. In particular, the Contractor must disclose the name of each such person, his or her business address, the name of the relationship, and the amount of fees paid or estimated to be paid. The Contractor is not required to disclose employees who are paid solely through the Contractor's regular payroll.
3. "Lobbyists" means any person (a) who for compensation or on behalf of any person other than himself undertake to influence any legislative or administrative action, or (b) any part of whose duties as an employee of another includes undertaking to influence any legislative or administrative action.

B. Certification

Contractor hereby certifies as follows:

1. This Disclosure relates to the following transaction: 7th District Police Station Sitework/Underground Utilities
Description of goods or services to be provided under Contract: # 1448
2. Name of Contractor: Old Veteran Construction, Inc.
3. EACH AND EVERY attorney, lobbyist, accountant, consultant, subcontractor, or other person retained or anticipated to be retained by the Contractor with respect to or in connection with the contract or lease is listed below. Attach additional pages if necessary. NOTE: You must include information about certified MBE/WBEs you have retained or anticipate retaining, even if you have already provided that information elsewhere in the contract documents.

Retained Parties:

Name	Business Address	Relationship (Attorney, Lobbyist, Subcontractor, etc.)	Fees (indicate whether paid or estimated)
See Attached			

Check Here If No Such Persons Have been Retained or Are Anticipated To Be Retained: _____

DISCLOSURE OF RETAINED PARTIES

4. The Contractor understands and agrees as follows:
- a. The information provided herein is a material inducement to the Commission execution of the contract or other action with respect to which this Disclosure of Retained Parties form is being executed, and the Commission may rely on the information provided herein. Furthermore, if the Commission determines that any information provided herein is false, incomplete, or inaccurate, the Commission may terminate the contract or other transaction, terminate the Contractor's participation in the contract or other transactions with the Commission.
 - b. If the Contractor is uncertain whether a disclosure is required under the Contractor must either ask the Commission's Representative or his or her manager whether disclosure is required or make the disclosure.
 - c. This Disclosure of Retained Parties form, some or all of the information provided herein, and any attachments may be made available to the public on the Internet, in response to a Freedom of Information Act request, or otherwise. The Contractor waives and releases any possible rights or claims it may have against the Commission in connection with the public release of information contained in the completed Disclosure of Retained Parties form and any attachments.

Under penalty of perjury, I certify that I am authorized to execute this Disclosure of Retained Parties on behalf of the Contractor and that the information disclosed herein is true and complete.



Signature

9/25/06
Date

Jose Maldonado
Name (Type or Print)

President
Title

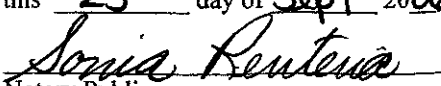
Subscribed and sworn to before me

this 25 day of Sept 2006

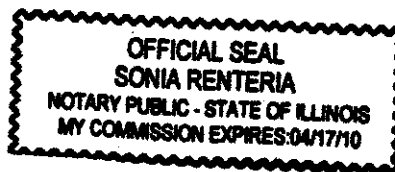
Notary Public



RETAINED PARTIES - PBC 7th District Police Station

NAME	BUSINESS ADDRESS	RELATIONSHIP	FEES	FEE TYPE
T&D Excavation & Grading	20W327 Belmont Pl., Addison, IL 60101	Subcontractor	\$ 800,000.00	Estimated
Metro Tank & Pump	1111 W. Dundee Rd., Wheeling, IL 60610	Subcontractor	\$ 70,000.00	Estimated
ARC Underground	2114 W. Thomas St., Chicago, IL 60622	Subcontractor	\$ 293,000.00	Estimated
Sanchez Paving	16309 S. Crawford Ave., Markham, IL 60426	Subcontractor	\$ 126,600.00	Estimated
Tortorello's Sprinkling	3220 S. Shields, Chicago, IL 60616	Subcontractor	\$ 18,000.00	Estimated
Fence Masters	20400 Cottage Grove Ave., Chicago Heights, IL 60411	Subcontractor	\$ 59,600.00	Estimated
Genex Corp.	1411 Opus Place, Suite 120, Downers Grove, IL 60515	Subcontractor	\$ 41,000.00	Estimated
Accumark, Inc.	439 Greenhill Lane, Schaumburg, IL 60193	Subcontractor	\$ 10,000.00	Estimated

ACORD CERTIFICATE OF LIABILITY INSURANCE

OP ID 23
OLDVE-1

DATE (MM/DD/YYYY)
09/20/06

PRODUCER

Hausman-Kunkel, Inc
 40 South Prospect
 Roselle IL 60172
 Phone: 630-894-7510 Fax: 630-894-4333

INSURED

Old Veteran Construction Inc.
 10942 S Halsted
 Chicago IL 60628

THIS CERTIFICATE IS ISSUED AS A MATTER OF INFORMATION ONLY AND CONFERS NO RIGHTS UPON THE CERTIFICATE HOLDER. THIS CERTIFICATE DOES NOT AMEND, EXTEND OR ALTER THE COVERAGE AFFORDED BY THE POLICIES BELOW.

INSURERS AFFORDING COVERAGE	NAIC #
INSURER A: Central Insurance Companies	20222
INSURER B: Accident Fund	13044
INSURER C:	
INSURER D:	
INSURER E:	

COVERAGES

THE POLICIES OF INSURANCE LISTED BELOW HAVE BEEN ISSUED TO THE INSURED NAMED ABOVE FOR THE POLICY PERIOD INDICATED. NOTWITHSTANDING ANY REQUIREMENT, TERM OR CONDITION OF ANY CONTRACT OR OTHER DOCUMENT WITH RESPECT TO WHICH THIS CERTIFICATE MAY BE ISSUED OR MAY PERTAIN, THE INSURANCE AFFORDED BY THE POLICIES DESCRIBED HEREIN IS SUBJECT TO ALL THE TERMS, EXCLUSIONS AND CONDITIONS OF SUCH POLICIES. AGGREGATE LIMITS SHOWN MAY HAVE BEEN REDUCED BY PAID CLAIMS.

INSR ADD'L LTR INSRD	TYPE OF INSURANCE	POLICY NUMBER	POLICY EFFECTIVE DATE (MM/DD/YY)	POLICY EXPIRATION DATE (MM/DD/YY)	LIMITS
A	GENERAL LIABILITY	CLP7976266	03/05/06	03/05/07	EACH OCCURRENCE \$ 1000000
	<input checked="" type="checkbox"/> COMMERCIAL GENERAL LIABILITY				DAMAGE TO RENTED PREMISES (Ea occurrence) \$ 100000
	<input type="checkbox"/> CLAIMS MADE <input checked="" type="checkbox"/> OCCUR				MED EXP (Any one person) \$ 5000
					PERSONAL & ADV INJURY \$ 1000000
					GENERAL AGGREGATE \$ 2000000
					PRODUCTS - COMPROP AGG \$ 2000000
	GEN'L AGGREGATE LIMIT APPLIES PER: <input type="checkbox"/> POLICY <input type="checkbox"/> PRO-JECT <input type="checkbox"/> LOC				
X	AUTOMOBILE LIABILITY	BAP7974114	03/05/06	03/05/07	COMBINED SINGLE LIMIT (Ea accident) \$ 1000000
	<input checked="" type="checkbox"/> ANY AUTO	BAP7974114	03/05/06	03/05/07	BODILY INJURY (Per person) \$
	<input type="checkbox"/> ALL OWNED AUTOS				BODILY INJURY (Per accident) \$
	<input type="checkbox"/> SCHEDULED AUTOS				PROPERTY DAMAGE (Per accident) \$
X	<input checked="" type="checkbox"/> HIRED AUTOS				
X	<input checked="" type="checkbox"/> NON-OWNED AUTOS				
	GARAGE LIABILITY				AUTO ONLY - EA ACCIDENT \$
	<input type="checkbox"/> ANY AUTO				OTHER THAN EA ACC \$
					AUTO ONLY: AGG \$
A	EXCESS/UMBRELLA LIABILITY	CXS7976267	03/05/06	03/05/07	EACH OCCURRENCE \$ 9000000
	<input checked="" type="checkbox"/> OCCUR <input type="checkbox"/> CLAIMS MADE				AGGREGATE \$ 9000000
	<input type="checkbox"/> DEDUCTIBLE				\$
	RETENTION \$				\$
B	WORKERS COMPENSATION AND EMPLOYERS' LIABILITY	WCV5010480	03/05/06	03/05/07	<input checked="" type="checkbox"/> WC STATU-TORY LIMITS <input type="checkbox"/> OTH-ER
	ANY PROPRIETOR/PARTNER/EXECUTIVE OFFICER/MEMBER EXCLUDED?				E.L. EACH ACCIDENT \$ 500000
	If yes, describe under SPECIAL PROVISIONS below				E.L. DISEASE - EA EMPLOYEE \$ 500000
A	OTHER	CLP7976266	03/05/06	03/05/07	E.L. DISEASE - POLICY LIMIT \$ 500000
	Equipment Floater				All Risk 145,000 500 Ded

DESCRIPTION OF OPERATIONS / LOCATIONS / VEHICLES / EXCLUSIONS ADDED BY ENDORSEMENT / SPECIAL PROVISIONS
 Contract #1448 Project: 7th District Police Station

CERTIFICATE HOLDER

CHIC-11

City of Chicago
 Public Building Commission
 50 W Washington St
 Chicago IL 60602

CANCELLATION

SHOULD ANY OF THE ABOVE DESCRIBED POLICIES BE CANCELLED BEFORE THE EXPIRATION DATE THEREOF, THE ISSUING INSURER WILL ENDEAVOR TO MAIL 30 DAYS WRITTEN NOTICE TO THE CERTIFICATE HOLDER NAMED TO THE LEFT, BUT FAILURE TO DO SO SHALL IMPOSE NO OBLIGATION OR LIABILITY OF ANY KIND UPON THE INSURER, ITS AGENTS OR REPRESENTATIVES.

AUTHORIZED REPRESENTATIVE
 Hausman Kunkel

Cook County Prevailing Wage for August 2006

Trade Name	RG	TYP	C	Base	FRMAN	*M-F>8	OSA	OSH	H/W	Pensn	Vac	Trng
ASBESTOS ABT-GEN	ALL			30.150	30.900	1.5	1.5	2.0	6.860	3.940	0.000	0.170
ASBESTOS ABT-MEC	BLD			23.300	24.800	1.5	1.5	2.0	7.860	4.910	0.000	0.000
BOILERMAKER	BLD			37.700	41.090	2.0	2.0	2.0	6.720	6.790	0.000	0.210
BRICK MASON	BLD			33.250	36.580	1.5	1.5	2.0	6.450	7.020	0.000	0.440
CARPENTER	ALL			35.320	37.320	1.5	1.5	2.0	6.760	5.310	0.000	0.490
CEMENT MASON	ALL			36.600	37.850	2.0	1.5	2.0	6.110	4.920	0.000	0.150
CERAMIC TILE FNSHER	BLD			28.520	0.000	2.0	1.5	2.0	5.650	5.750	0.000	0.330
COMM. ELECT.	BLD			31.440	33.940	1.5	1.5	2.0	6.300	5.290	0.000	0.700
ELECTRIC PWR EQMT OP	ALL			36.050	42.000	1.5	1.5	2.0	7.870	9.730	0.000	0.270
ELECTRIC PWR GRNDMAN	ALL			28.120	42.000	1.5	1.5	2.0	6.140	7.600	0.000	0.210
ELECTRIC PWR LINEMAN	ALL			36.050	42.000	1.5	1.5	2.0	7.870	9.730	0.000	0.270
ELECTRICIAN	ALL			35.150	37.750	1.5	1.5	2.0	8.680	6.850	0.000	0.750
ELEVATOR CONSTRUCTOR	BLD			40.745	45.840	2.0	2.0	2.0	7.775	5.090	2.445	0.400
FENCE ERECTOR	ALL			25.840	27.090	1.5	1.5	2.0	7.250	7.080	0.000	0.200
GLAZIER	BLD			31.400	32.400	1.5	2.0	2.0	6.490	9.050	0.000	0.500
HT/FROST INSULATOR	BLD			33.300	35.050	1.5	1.5	2.0	7.860	8.610	0.000	0.310
IRON WORKER	ALL			36.250	37.750	2.0	2.0	2.0	8.970	10.77	0.000	0.300
LABORER	ALL			30.150	30.900	1.5	1.5	2.0	6.860	3.940	0.000	0.170
LATHER	BLD			35.320	37.320	1.5	1.5	2.0	6.760	5.310	0.000	0.490
MACHINIST	BLD			36.890	38.890	2.0	2.0	2.0	4.380	5.650	2.550	0.000
MARBLE FINISHERS	ALL			25.750	0.000	1.5	1.5	2.0	6.070	7.020	0.000	0.580
MARBLE MASON	BLD			33.250	36.580	1.5	1.5	2.0	6.450	7.020	0.000	0.580
MILLWRIGHT	ALL			35.320	37.320	1.5	1.5	2.0	6.760	5.310	0.000	0.490
OPERATING ENGINEER	BLD 1			41.550	45.550	2.0	2.0	2.0	6.850	5.600	1.900	0.700
OPERATING ENGINEER	BLD 2			40.250	45.550	2.0	2.0	2.0	6.850	5.600	1.900	0.700
OPERATING ENGINEER	BLD 3			37.700	45.550	2.0	2.0	2.0	6.850	5.600	1.900	0.700
OPERATING ENGINEER	BLD 4			35.950	45.550	2.0	2.0	2.0	6.850	5.600	1.900	0.700
OPERATING ENGINEER	FLT 1			42.700	42.700	1.5	1.5	2.0	6.050	4.850	1.800	0.000
OPERATING ENGINEER	FLT 2			41.200	42.700	1.5	1.5	2.0	6.050	4.850	1.800	0.000
OPERATING ENGINEER	FLT 3			36.650	42.700	1.5	1.5	2.0	6.050	4.850	1.800	0.000
OPERATING ENGINEER	FLT 4			30.500	42.700	1.5	1.5	2.0	6.050	4.850	1.800	0.000
OPERATING ENGINEER	HWY 1			39.750	43.750	1.5	1.5	2.0	6.850	5.600	1.900	0.700
OPERATING ENGINEER	HWY 2			39.200	43.750	1.5	1.5	2.0	6.850	5.600	1.900	0.700
OPERATING ENGINEER	HWY 3			37.150	43.750	1.5	1.5	2.0	6.850	5.600	1.900	0.700
OPERATING ENGINEER	HWY 4			35.750	43.750	1.5	1.5	2.0	6.850	5.600	1.900	0.700
OPERATING ENGINEER	HWY 5			34.550	43.750	1.5	1.5	2.0	6.850	5.600	1.900	0.700
ORNAMNTL IRON WORKER	ALL			33.600	35.350	2.0	2.0	2.0	7.250	10.09	0.000	0.750
PAINTER	ALL			34.400	38.700	1.5	1.5	1.5	6.200	6.400	0.000	0.390
PAINTER SIGNS	BLD			27.640	31.030	1.5	1.5	1.5	2.600	2.210	0.000	0.000
PILEDRIIVER	ALL			35.320	37.320	1.5	1.5	2.0	6.760	5.310	0.000	0.490
PIPEFITTER	BLD			36.100	38.100	1.5	1.5	2.0	7.910	6.100	0.000	0.800
PLASTERER	BLD			33.850	35.350	1.5	1.5	2.0	6.740	7.100	0.000	0.400
PLUMBER	BLD			38.400	40.400	1.5	1.5	2.0	7.170	3.940	0.000	0.790
ROOFER	BLD			33.650	35.650	1.5	1.5	2.0	6.110	3.160	0.000	0.330
SHEETMETAL WORKER	BLD			33.400	36.070	1.5	1.5	2.0	6.460	7.850	0.000	0.590
SIGN HANGER	BLD			24.640	25.490	1.5	1.5	2.0	3.980	2.050	0.000	0.000
SPRINKLER FITTER	BLD			37.500	39.500	1.5	1.5	2.0	8.000	5.850	3.600	0.500
STEEL ERECTOR	ALL			36.250	37.750	2.0	2.0	2.0	8.970	10.77	0.000	0.300
STONE MASON	BLD			33.250	36.580	1.5	1.5	2.0	6.450	7.020	0.000	0.440
TERRAZZO FINISHER	BLD			29.290	0.000	1.5	1.5	2.0	5.650	6.940	0.000	0.270

TERRAZZO MASON	BLD	33.650	36.650	1.5	1.5	2.0	5.650	8.610	0.000	0.300
TILE MASON	BLD	34.600	38.600	2.0	1.5	2.0	5.650	7.000	0.000	0.460
TRAFFIC SAFETY WRKR	HWY	22.800	24.400	1.5	1.5	2.0	3.078	1.875	0.000	0.000
TRUCK DRIVER	E ALL 1	29.150	29.800	1.5	1.5	2.0	5.650	4.300	0.000	0.000
TRUCK DRIVER	E ALL 2	29.400	29.800	1.5	1.5	2.0	5.650	4.300	0.000	0.000
TRUCK DRIVER	E ALL 3	29.600	29.800	1.5	1.5	2.0	5.650	4.300	0.000	0.000
TRUCK DRIVER	E ALL 4	29.800	29.800	1.5	1.5	2.0	5.650	4.300	0.000	0.000
TRUCK DRIVER	W ALL 1	29.700	30.250	1.5	1.5	2.0	6.500	3.400	0.000	0.000
TRUCK DRIVER	W ALL 2	29.850	30.250	1.5	1.5	2.0	6.500	3.400	0.000	0.000
TRUCK DRIVER	W ALL 3	30.050	30.250	1.5	1.5	2.0	6.500	3.400	0.000	0.000
TRUCK DRIVER	W ALL 4	30.250	30.250	1.5	1.5	2.0	6.500	3.400	0.000	0.000
TUCKPONTER	BLD	34.500	35.500	1.5	1.5	2.0	4.710	6.340	0.000	0.400

Legend:

M-F>8 (Overtime is required for any hour greater than 8 worked each day, Monday through Friday.)

OSA (Overtime is required for every hour worked on Saturday)

OSH (Overtime is required for every hour worked on Sunday and Holidays)

H/W (Health & Welfare Insurance)

Pensn (Pension)

Vac (Vacation)

Trng (Training)

Explanations

COOK COUNTY

TRUCK DRIVERS (WEST) - That part of the county West of Barrington Road.

The following list is considered as those days for which holiday rates of wages for work performed apply: New Years Day, Memorial/Decoration Day, Fourth of July, Labor Day, Veterans Day, Thanksgiving Day, Christmas Day. Generally, any of these holidays which fall on a Sunday is celebrated on the following Monday. This then makes work performed on that Monday payable at the appropriate overtime rate for holiday pay. Common practice in a given local may alter certain days of celebration such as the day after Thanksgiving for Veterans Day. If in doubt, please check with IDOL.

EXPLANATION OF CLASSES

ASBESTOS - GENERAL - removal of asbestos material/mold and hazardous materials from any place in a building, including mechanical systems

where those mechanical systems are to be removed. This includes the removal of asbestos materials/mold and hazardous materials from ductwork or pipes in a building when the building is to be demolished at the time or at some close future date.

ASBESTOS - MECHANICAL - removal of asbestos material from mechanical systems, such as pipes, ducts, and boilers, where the mechanical systems are to remain.

CERAMIC TILE FINISHER

The grouting, cleaning, and polishing of all classes of tile, whether for interior or exterior purposes, all burned, glazed or unglazed products; all composition materials, granite tiles, warning detectable tiles, cement tiles, epoxy composite materials, pavers, glass, mosaics, fiberglass, and all substitute materials, for tile made in tile-like units; all mixtures in tile like form of cement, metals, and other materials that are for and intended for use as a finished floor surface, stair treads, promenade roofs, walks, walls, ceilings, swimming pools, and all other places where tile is to form a finished interior or exterior. The mixing of all setting mortars including but not limited to thin-set mortars, epoxies, wall mud, and any other sand and cement mixtures or adhesives when used in the preparation, installation, repair, or maintenance of tile and/or similar materials. The handling and unloading of all sand, cement, lime, tile, fixtures, equipment, adhesives, or any other materials to be used in the preparation, installation, repair, or maintenance of tile and/or similar materials. Ceramic Tile Finishers shall fill all joints and voids regardless of method on all tile work, particularly and especially after installation of said tile work. Application of any and all protective coverings to all types of tile installations including, but not be limited to, all soap compounds, paper products, tapes, and all polyethylene coverings, plywood, masonite, cardboard, and any new type of products that may be used to protect tile installations, Blastrac equipment, and all floor scarifying equipment used in preparing floors to receive tile. The clean up and removal of all waste and materials. All demolition of existing tile floors and walls to be re-tiled.

COMMUNICATIONS ELECTRICIAN - Installation, operation, inspection, maintenance, repair and service of radio, television, recording, voice sound vision production and reproduction, telephone and telephone interconnect, facsimile, data apparatus, coaxial, fibre optic and wireless equipment, appliances and systems used for the transmission and reception of signals of any nature, business, domestic, commercial, education, entertainment, and residential purposes, including but not limited to, communication and telephone, electronic and sound equipment, fibre optic and data communication systems, and the performance of any task directly related to such installation or service whether at new or existing sites, such tasks to include the placing of wire and cable and electrical power conduit or other raceway work within the equipment room and pulling wire and/or cable through conduit and the installation of any incidental conduit, such that the employees covered hereby can complete any job in full.

MARBLE FINISHER

Loading and unloading trucks, distribution of all materials (all stone, sand, etc.), stocking of floors with material, performing all rigging for heavy work, the handling of all material that may be needed for the installation of such materials, building of scaffolding, polishing if needed, patching, waxing of material if damaged, pointing up, caulking, grouting and cleaning of marble, holding water on diamond or Carborundum blade or saw for setters cutting, use of tub saw or any other saw needed for preparation of material, drilling of holes for wires that anchor material set by setters, mixing up of molding plaster for installation of material, mixing up thin set for the installation of material, mixing up of sand to cement for the installation of material and such other work as may be required in helping a Marble Setter in the handling of all material in the erection or installation of interior marble, slate, travertine, art marble, serpentine, alberene stone, blue stone, granite and other stones (meaning as to stone any foreign or domestic materials as are specified and used in building interiors and exteriors and customarily known as stone in the trade), carrara, sanionyx, vitrolite and similar opaque glass and the laying of all marble tile, terrazzo tile, slate tile and precast tile, steps, risers treads, base, or any other materials that may be used as substitutes for any of the aforementioned materials and which are used on interior and exterior which are installed in a similar manner.

TERRAZZO FINISHER

The handling of sand, cement, marble chips, and all other materials that may be used by the Mosaic Terrazzo Mechanic, and the mixing, grinding, grouting, cleaning and sealing of all Marble, Mosaic, and Terrazzo work, floors, base, stairs, and wainscoting by hand or machine, and in addition, assisting and aiding Marble, Masonic, and Terrazzo Mechanics.

TRAFFIC SAFETY

Work associated with barricades, horses and drums used to reduce lane usage on highway work, the installation and removal of temporary lane markings, and the installation and removal of temporary road signs.

TRUCK DRIVER - BUILDING, HEAVY AND HIGHWAY CONSTRUCTION - EAST & WEST

Class 1. Two or three Axle Trucks. A-frame Truck when used for transportation purposes; Air Compressors and Welding Machines, including those pulled by cars, pick-up trucks and tractors; Ambulances; Batch Gate Lockers; Batch Hopperman; Car and Truck Washers; Carry-alls; Fork Lifts and Hoisters; Helpers; Mechanics Helpers and Greasers; Oil Distributors 2-man operation; Pavement Breakers; Pole Trailer, up to 40 feet; Power Mower Tractors; Self-propelled Chip Spreader; Skipman; Slurry Trucks, 2-man operation; Slurry Truck Conveyor Operation, 2 or 3 man; TEAMSTERS Unskilled dumpman; and Truck Drivers hauling warning lights, barricades, and portable toilets on the job site.

Class 2. Four axle trucks; Dump Crets and Adgetors under 7 yards;

Dumpsters, Track Trucks, Euclids, Hug Bottom Dump Turnapulls or Turnatrailers when pulling other than self-loading equipment or similar equipment under 16 cubic yards; Mixer Trucks under 7 yards; Ready-mix Plant Hopper Operator, and Winch Trucks, 2 Axles.

Class 3. Five axle trucks; Dump Crets and Adgetors 7 yards and over; Dumpsters, Track Trucks, Euclids, Hug Bottom Dump Turnatrailers or turnapulls when pulling other than self-loading equipment or similar equipment over 16 cubic yards; Explosives and/or Fission Material Trucks; Mixer Trucks 7 yards or over; Mobile Cranes while in transit; Oil Distributors, 1-man operation; Pole Trailer, over 40 feet; Pole and Expandable Trailers hauling material over 50 feet long; Slurry trucks, 1-man operation; Winch trucks, 3 axles or more; Mechanic--Truck Welder and Truck Painter.

Class 4. Six axle trucks; Dual-purpose vehicles, such as mounted crane trucks with hoist and accessories; Foreman; Master Mechanic; Self-loading equipment like P.B. and trucks with scoops on the front.

OPERATING ENGINEERS - BUILDING

Class 1. Mechanic; Asphalt Plant; Asphalt Spreader; Autograde; Backhoes with Caisson attachment; Batch Plant; Benoto; Boiler and Throttle Valve; Caisson Rigs; Central Redi-Mix Plant; Combination Back Hoe Front End-loader Machine; Compressor and Throttle Valve; Concrete Breaker (Truck Mounted); Concrete Conveyor; Concrete Paver; Concrete Placer; Concrete Placing Boom; Concrete Pump (Truck Mounted); Concrete Tower; Cranes, All; Cranes, Hammerhead; Cranes, (GCI and similar Type); Creter Crane; Crusher, Stone, etc.; Derricks, All; Derricks, Traveling; Formless Curb and Gutter Machine; Grader, Elevating; Grouting Machines; Highlift Shovels or Front Endloader 2-1/4 yd. and over; Hoists, Elevators, outside type rack and pinion and similar machines; Hoists, one, two and three Drum; Hoists, Two Tugger One Floor; Hydraulic Backhoes; Hydraulic Boom Trucks; Hydro Vac (and similar equipment); Locomotives, All; Motor Patrol; Pile Drivers and Skid Rig; Post Hole Digger; Pre-Stress Machine; Pump Cretes Dual Ram; Pump Cretes; Squeeze Cretes-screw Type Pumps; Raised and Blind Hole Drill; Roto Mill Grinder; Scoops - Tractor Drawn; Slip-form Paver; Straddle Buggies; Tournapull; Tractor with Boom and Side Boom; Trenching Machines.

Class 2. Bobcat (over 3/4 cu. yd.); Boilers; Brick Forklift; Broom, All Power Propelled; Bulldozers; Concrete Mixer (Two Bag and Over); Conveyor, Portable; Forklift Trucks; Greaser Engineer; Highlift Shovels or Front Endloaders under 2-1/4 yd.; Hoists, Automatic; Hoists, inside Freight Elevators; Hoists, Sewer Dragging Machine; Hoists, Tugger Single Drum; Laser Screed; Rock Drill (self-propelled); Rock Drill (truck mounted); Rollers, All; Steam Generators; Tractors, All; Tractor Drawn Vibratory Roller; Winch Trucks with "A" Frame.

Class 3. Air Compressor; Combination - Small Equipment Operator; Generators; Heaters, Mechanical; Hoists, Inside Elevators - (Rheostat Manual Controlled); Hydraulic Power Units (Pile Driving, Extracting, and Drilling); Pumps, over 3" (1 to 3 not to exceed a total of 300 ft.); Pumps, Well Points; Welding Machines (2 through 5); Winches, 4

small Electric Drill Winches; Bobcat (up to and including 3/4 cu. yd.).

Class 4. Bobcats and/or other Skid Steer Loaders; Oilers; and Brick Forklift.

OPERATING ENGINEERS - FLOATING

Class 1. Craft foreman (Master Mechanic), diver/wet tender, engineer (hydraulic dredge).

Class 2. Crane/backhoe operator, mechanic/welder, assistant engineer (hydraulic dredge), leverman (hydraulic dredge), and diver tender.

Class 3. Deck equipment operator (machineryman), maintenance of crane (over 50 ton capacity) or backhoe (96,000 pounds or more), tug/launch operator, loader, dozer and like equipment on barge, breakwater wall, slip/dock or scow, deck machinery, etc.

Class 4. Deck equipment operator (machineryman/fireman), (4 equipment units or more) and crane maintenance 50 ton capacity and under or backhoe weighing 96,000 pounds or less, assistant tug operator.

OPERATING ENGINEERS - HEAVY AND HIGHWAY CONSTRUCTION

Class 1. Craft Foreman; Asphalt Plant; Asphalt Heater and Planer Combination; Asphalt Heater Scarfire; Asphalt Spreader; Autograder/GOMACO or other similar type machines; ABG Paver; Backhoes with Caisson attachment; Ballast Regulator; Belt Loader; Caisson Rigs; Car Dumper; Central Redi-Mix Plant; Combination Backhoe Front Endloader Machine, (1 cu. yd. Backhoe Bucket or over or with attachments); Concrete Breaker (Truck Mounted); Concrete Conveyor; Concrete Paver over 27E cu. ft.; Concrete Placer; Concrete Tube Float; Cranes, all attachments; Cranes, Hammerhead, Linden, Peco & Machines of a like nature; Crete Crane; Crusher, Stone, etc.; Derricks, All; Derrick Boats; Derricks, Traveling; Dowell machine with Air Compressor; Dredges; Field Mechanic-Welder; Formless Curb and Gutter Machine; Gradall and Machines of a like nature; Grader, Elevating; Grader, Motor Grader, Motor Patrol, Auto Patrol, Form Grader, Pull Grader, Subgrader; Guard Rail Post Driver Mounted; Hoists, One, Two and Three Drum; Hydraulic Backhoes; Backhoes with shear attachments; Mucking Machine; Pile Drivers and Skid Rig; Pre-Stress Machine; Pump Cretes Dual Ram; Rock Drill - Crawler or Skid Rig; Rock Drill - Truck Mounted; Roto Mill Grinder; Slip-Form Paver; Soil Test Drill Rig (Truck Mounted); Straddle Buggies; Hydraulic Telescoping Form (Tunnel); Tractor Drawn Belt Loader (with attached pusher - two engineers); Tractor with Boom; Tractaire with Attachments; Trenching Machine; Truck Mounted Concrete Pump with Boom; Raised or Blind Hole; Drills (Tunnel Shaft); Underground Boring and/or Mining Machines; Wheel Excavator; Widener (APSCO).

Class 2. Batch Plant; Bituminous Mixer; Boiler and Throttle Valve; Bulldozers; Car Loader Trailing Conveyors; Combination Backhoe Front Endloader Machine (less than 1 cu. yd. Backhoe Bucket or over or with attachments); Compressor and Throttle Valve; Compressor, Common

Receiver (3); Concrete Breaker or Hydro Hammer; Concrete Grinding Machine; Concrete Mixer or Paver 7S Series to and including 27 cu. ft.; Concrete Spreader; Concrete Curing Machine, Burlap Machine, Belting Machine and Sealing Machine; Concrete Wheel Saw; Conveyor Muck Cars (Haglund or Similar Type); Drills, All; Finishing Machine - Concrete; Greaser Engineer; Highlift Shovels or Front Endloader; Hoist - Sewer Dragging Machine; Hydraulic Boom Trucks (All Attachments); Hydro-Blaster; All Locomotives, Dinky; Pump Cretes; Squeeze Cretes-Screw Type Pumps, Gypsum Bulker and Pump; Roller, Asphalt; Rotary Snow Plows; Rototiller, Seaman, etc., self-propelled; Scoops - Tractor Drawn; Self-Propelled Compactor; Spreader - Chip - Stone, etc.; Scraper; Scraper - Prime Mover in Tandem (Regardless of Size); Tank Car Heater; Tractors, Push, Pulling Sheeps Foot, Disc, Compactor, etc.; Tug Boats.

Class 3. Boilers; Brooms, All Power Propelled; Cement Supply Tender; Compressor, Common Receiver (2); Concrete Mixer (Two Bag and Over); Conveyor, Portable; Farm-Type Tractors Used for Mowing, Seeding, etc.; Fireman on Boilers; Forklift Trucks; Grouting Machine; Hoists, Automatic; Hoists, All Elevators; Hoists, Tugger Single Drum; Jeep Diggers; Pipe Jacking Machines; Post-Hole Digger; Power Saw, Concrete Power Driven; Pug Mills; Rollers, other than asphalt; Seed and Straw Blower; Steam Generators; Stump Machine; Winch Trucks with "A" Frame; Work Boats; Tamper - Form-Motor Driven.

Class 4. Air Compressor; Combination - Small Equipment Operator; Directional Boring Machine; Generators; Heaters, Mechanical; Hydraulic Power Unit (Pile Driving, Extracting, or Drilling); Hydro-Blaster; Light Plants, All (1 through 5); Pumps, over 3" (1 to 3 not to exceed a total of 300 ft.); Pumps, Well Points; Tractaire; Welding Machines (2 through 5); Winches, 4 Small Electric Drill Winches.

Class 5. Bobcats (all); Brick Forklifts, Oilers.

Other Classifications of Work:

For definitions of classifications not otherwise set out, the Department generally has on file such definitions which are available. If a task to be performed is not subject to one of the classifications of pay set out, the Department will upon being contacted state which neighboring county has such a classification and provide such rate, such rate being deemed to exist by reference in this document. If no neighboring county rate applies to the task, the Department shall undertake a special determination, such special determination being then deemed to have existed under this determination. If a project requires these, or any classification not listed, please contact IDOL at 618/993-7271 for wage rates or clarifications.

LANDSCAPING

Landscaping work falls under the existing classifications for laborer, operating engineer and truck driver. The work performed by landscape plantsman and landscape laborer is covered by the existing classification of laborer. The work performed by landscape operators

(regardless of equipment used or its size) is covered by the classifications of operating engineer. The work performed by landscape truck drivers (regardless of size of truck driven) is covered by the classifications of truck driver.

PUBLIC BUILDING COMMISSION OF CHICAGO

**ADDENDUM NO. 1 TO CONTRACT NO. 1448
FOR**

**7th District Police Station
1438 W. 63rd Street**

FOR

Site Work and Underground Utilities

BY: VOA Associates Incorporated
224 South Michigan Avenue
Suite 1400
Chicago, Illinois 60604

DATE: August 17, 2006

NOTICE OF CHANGES IN CONTRACT DOCUMENTS

The following changes are hereby made in the Contract Documents. Insofar as the prior Contract Documents are inconsistent herewith, the changes mentioned hereinafter shall govern unless the original language takes precedence according to the Order of Precedence of Components of the Contract Documents.

In Book 2, "Project Information, Instructions, and Execution Documents"

CHANGE 1: Section II "Proposal and Execution Documents", Phase I-Site Package Unit Price Breakdown, **change** the first line to read as:

UNIT PRICES SUB-TOTAL (A) page 24	\$
--	----

CHANGE 2: Section III "Proposal Support Documents", part B "Unit Prices", page 23, **item no. 35** "1" PVC Irrigation Pipe", **change** the "Approx Qty" to read as **650**.

DELETE 1: In section III "Proposal Support Documents", part B "Unit Prices", page 24 is to be deleted in its entirety and replaced with the attached revision, dated August 17, 2006

In Book 3A, Technical Specification, SECTION 01270, "UNIT PRICES"

DELETE 2: **DELETE** article 1.5 LLL "Unit Price **No. 64** in its entirety.

ADD 1: **ADD new article 1.5 MMM "Unit Price **No. 65 Temporary Street Closure Barricade**" to read as below. Record unit price to be included as a part of the bid to Book 2 page 24.**

Mayor Richard M. Daley, Chairman

Montel Gayles, Executive Director

PUBLIC BUILDING COMMISSION OF CHICAGO

Unit Price No. **65 Temporary Street Closure Barricade:**

1. Description: For potential additions and deletions to the Contract, provide a unit price for temporary street closure barricades. Unit price shall be inclusive of all costs, including but not limited to: labor, material, equipment, tools, permits, overhead, profit etc. required to furnish, maintain and remove the required items of work.
2. Unit of Measurement: per each sign

ADD 2: **ADD new article 1.5 NNN "Unit Price No. 66 Manhole"** to read as below. Record unit price to be included as a part of the bid to Book 2 page 24.

Unit Price No. **66 Manhole:**

1. Description: For potential additions and deletions to the Contract, provide a unit price for a 4-foot diameter manhole. Unit price shall be inclusive of all costs, including but not limited to: labor, materials, equipment, excavation, disposal, granular backfill, tools, overhead, profit, submittals including LEED submittals, etc. required to furnish and install complete per the appropriate Specifications, the required items of work.
2. Unit of Measurement: per each manhole

ADD 3: **Add new article, 1.5. 000 "Unit Price No. 67 "Fire Hydrant Relocation"** to read as below. Record unit price to be included as a part of the bid to Book 2 page 24.

Unit Price No. **67 Relocating Fire Hydrant:**

1. Description: For potential additions and deletions to the Contract, provide a unit price to relocate the existing fire hydrant at the corner of W63rd. St. and S. Bishop St. as indicated on CSK.10. Unit price shall be inclusive of all costs, including but not limited to: labor, materials, equipment, excavation, disposal, granular backfill, tools, overhead, profit, submittals including LEED submittals, etc. required to furnish and install complete per the appropriate Specifications, the required items of work.
2. Unit of Measurement: per each hydrant

ADD 4: **Add new article, 1.5 PPP "Unit Price No. 68 2" PVC Sleeve"** to read as below. Record unit price to be included as a part of the bid to Book 2 page 24.

Unit Price No. **68 PVC Sleeve:**

1. Description: For potential additions and deletions to the Contract, provide a unit price for a 2" PVC sleeve to be installed around all 1" and 1 ¼" PVC irrigation piping crossing under paved areas. Unit price shall be inclusive of all costs, including but not limited to: labor, materials, equipment, excavation, disposal, granular backfill, tools, overhead, profit, submittals including LEED submittals, etc. required to furnish and install complete per the appropriate Specifications, the required items of work.
2. Unit of Measurement: Linear Feet

Mayor Richard M. Daley, Chairman

Montel Gayles, Executive Director

PUBLIC BUILDING COMMISSION OF CHICAGO

ADD 5: Add new article 1.5 QQQ "Unit Price No. 69 1-1/4" PVC irrigation pipe" to read as below. Record unit price to be included as a part of the bid to Book 2 page 24.

Unit Price No. 69 1-1/4" PVC irrigation pipe:

1. Description: For potential additions or deletions to the Contract, provide a unit price for 1-inch PVC irrigation piping. Unit price shall be inclusive of all costs, including but not limited to: labor, materials, equipment, excavation, disposal, granular backfill, traffic control, permits, tools, overhead, profit, fees, submittals including LEED submittals, etc. required to furnish and install complete per the appropriate Specifications, the required items of work.
2. Unit of Measurement: per linear foot

In Book 3A, Technical Specification, SECTION 02064 "CONTAMINATED SOILS REMOVAL"

ADD 6: ADD to paragraph 3.08 "BACKFILL" A: "Reference Appendix 'D', letter regarding Clean Fill Sample Analysis, dated 7/20/2006."

In Book 3A, Technical Specification, SECTION 02300 "EARTHWORK"

ADD 7: ADD to paragraph 1.2 "RELATED DOCUMENTS", item D. to read as the following:

Related Sections:

1. Section 02064: Contaminated Soil Removal
2. Section 02900: Landscaping
3. Appendix A: Parcel Plans
4. Appendix B: Geotechnical Subsurface Exploration Report
5. Appendix C: Environmental Trenching Report
6. Appendix D: Letter Regarding Clean Fill Sample Analysis

ADD 8: ADD paragraph 1.4 "Submittals", item D. to read as;

"Site Survey(s): For each application for payment submitted, a licensed surveyor shall provide a topographical survey for the purpose of verifying quantities of excavation removed from the site. Submit certified survey, including excavated quantities, with payment application."

In Book 3A, Technical Specification, SECTION 02900 "LANDSCAPING"

CHANGE 3: CHANGE paragraph 1.2.B. "Related Sections", in its entirety to read as follows:

Related Sections:

1. Section 02064: Contaminated Soil Removal
2. Section 02212: Finish Grading
3. Section 02300: Earthwork

ADD 9: ADD to paragraph 1.3.C "Topsoil Sample", the following: "All applicable conditions of Section 02064 and Appendix 'D' regarding "Backfill" and/or "Clean Fill" shall also apply."

Mayor Richard M. Daley, Chairman

Montel Gayles, Executive Director

PUBLIC BUILDING COMMISSION OF CHICAGO

ADD 10: **ADD** to paragraph **1.3.D "Topsoil Tests"**, the following: item no. **2**.

All applicable tests listed in Section 02064 and Appendix 'D' shall also be considered as required tests."

ADD 11: **ADD** to paragraph **1.3.E "Topsoil Test Results"**, after the word "Architect", **add** "and the Commission's Environmental Consultant"

ADD 12: **ADD** to paragraph **1.3.E "Topsoil Test Results"** add item no. 4 to read as:

Submit results of all testing required in Section 02064 and Appendix 'D'.

ADD 13: **ADD** new article 1.12 "Definitions", to read as follows:

1.12 DEFINITIONS

A: Landscape Planting Soil:

1. For the purposes of bidding a unit price for the work, the term Landscape Planting Soil shall refer to and be inclusive of, but not limited to the following terminology: "Planting Soil", "Planting Soil Mix", "Soil Mix", "Specified Soil Mix", "Topsoil Mix"
2. Landscape Planting Soil shall be defined as: Suitable topsoil complying with the specification requirements, mixed with amendments and fertilizer at rates recommended by the soil testing agency.

B. Topsoil: Shall be defined by article 2.6 A, this section and shall meet all requirements of a Clean Fill material as defined by Appendix 'D'.

In Book 3A, Technical Specification, Table of Contents

Clarification 1: To clarify, Appendix 'C' is the Carnow, Connibear & Assoc., Ltd. letter dated 5/25/06 in its entirety, including all exhibits, tables, and photographs therein.

ADD 14: **ADD** to **Book 3A Technical Specifications, Appendix 'C' cover sheet** immediately behind the final page of Appendix 'B' and in front of the Carnow, Connibear & Assoc., Ltd. letterhead dated 5/25/06; copy attached.

ADD 15: **ADD** to **Book 3A Technical Specifications, Appendix 'D'** in its entirety; copy attached.

DRAWINGS:

2.1 SHEET C1.0

1. Revise sheet as indicated on CSK.1.0; copy attached.
2. Revise sheet as indicated on CSK.2.0; copy attached.

Mayor Richard M. Daley, Chairman

Montel Gayles, Executive Director

PUBLIC BUILDING COMMISSION OF CHICAGO

3. Note 10 shall be revised in its entirety to read: "REMOVE SEWER AND PLUG PER DEPARTMENT OF WATER MANAGEMENT REQUIREMENTS WHERE SHOWN ON DRAWINGS. REMOVE AND CAP ALL UTILITY SERVICES TO EXISTING BUILDINGS TO BE DEMOLISHED."

4. Add the following note this sheet: "16. THE CONTRACTOR TO CLEAN DEBRIS FROM EXISTING CATCH BASIN PRIOR TO COMPLETING WORK."

5. Revise sheet as indicated on CSK.10; copy attached.

2.2 SHEET C1.1

1. Revise sheet as indicated on CSK.3.0; copy attached.

2.4 SHEET C2.0

1. Revise sheet as indicated on CSK.4.0; copy attached.
2. Revise sheet as indicated on CSK.5.0; copy attached.

2.5 SHEET C2.1

1. Revise sheet as indicated on CSK.6.0; copy attached.

2.6 SHEET C3.0

1. Revise sheet as indicated on CSK.7.0; copy attached.

2.7 SHEET C3.1

1. Revise sheet as indicated on CSK.8.0; copy attached.

2.8 SHEET C6.2

1. Add to this sheet detail 3A as indicated on CSK.9.0; copy attached.

2.9 SHEET AS.1

1. Add to this sheet photograph of Commercial Sign 1 as shown on ASK.01; copy attached.
2. Add to this sheet photograph of Commercial Sign 2 as shown on ASK.02; copy attached.
3. Revise drawing 1/AS.1 Phasing Plan as indicated on ASK.03; copy attached.

ATTACHMENTS:

Unit Prices page 24

APPENDIX 'C' COVER

APPENDIX 'D'

CSK.01

Mayor Richard M. Daley, Chairman

Montel Gayles, Executive Director

PUBLIC BUILDING COMMISSION OF CHICAGO

CSK.02

CSK.03

CSK.04

CSK.05

CSK.06

CSK.07

CSK.08

CSK.09

CSK.10

ASK.01

ASK.02

ASK.03

END OF ADDENDUM NO. 01

Mayor Richard M. Daley, Chairman

Montel Gayles, Executive Director

PUBLIC BUILDING COMMISSION OF CHICAGO
Contract No. 1448

	TYPE OF WORK	UNIT(S)	Approx Qty	Unit Price	Extended Price (qty x unit price)
52.	New 24' Construction Site Gate and Temporary Drive	Pair	4		
53.	Geotextile Filter Fabric	Square Foot	25000		
54.	Permeable Paver Sub-Base Material (CA-1)	Cubic Yard	770		
55.	Permeable Paver Base Material (CA-7)	Cubic Yard	580		
56.	Asphalt Aggregate Base Course (CA-6)	Cubic Yard	1200		
57.	Curb and Gutter	Linear Foot	4200		
58.	5" Thick Concrete Sidewalk Replacement	Square Foot	1000		
59.	Concrete Retaining Wall	Linear Foot	100		
60.	Winterize RPZ Valve / Irrigation System	Lump Sum	1		
61.	Landscape Planting Soil	Cubic Yard	6000		
62.	Soils Erosion Control -Temporary Hydroseeding	Square Foot	45000		
63.	Soils Erosion Control -at Storm Structure	Each	9		
64.	DELETED-LEAVE BLANK				
65.	Temporary Street Closure Barricade	Each	7		
66.	Manhole	Each	1		
67.	Fire Hydrant Relocation	Each	1		
68.	2" PVC Sleeve	Linear Foot	100		
69.	1-1/4" PVC Irrigation Pipe	Linear Foot	250		

UNIT PRICES SUB-TOTAL (A) (insert unit prices sub total (A) on page 13)				\$
---	--	--	--	----

Notes:

- "Unbalanced Bids" - Bidders pricing for each line item should carry its share of the cost of the work, plus its share of overhead and profit. Bidders should avoid nominal pricing for some line items and enhanced pricing for other lines. Bids that the Commission considers to be materially unbalanced will be rejected.
- "Disposal Sites" - As stipulated in Specification Section #02064, obtain and provide copies of all written authorizations from licensed/permitted construction and demolition debris disposal sites and land fills for the disposal of excavated materials from the site. The authorizations must be signed/executed by the disposal facilities representatives, and state that the site complies with all local zoning codes, State, Federal, and local laws, rules, and regulations. Contractor shall submit the name and address of minimum of three (3) disposal facilities that will be utilized for this project. The written authorizations from the three (3) disposal facilities must be submitted with Contractors' bid.

PUBLIC BUILDING COMMISSION OF CHICAGO

**7th District Police Station
1400 West 63rd Street, Chicago IL**

Appendix 'C'

Environmental Trenching Report

PUBLIC BUILDING COMMISSION OF CHICAGO

**7th District Police Station
1400 West 63rd Street, Chicago IL**

Appendix 'D'

Letter Regarding Clean Fill Sample Analysis



CARNOW, CONIBEAR & ASSOC., LTD.

Occupational and Environmental Health Consultants

300 West Adams Street, Suite 1200, Chicago, IL 60606

Tel: (312)782-4486 (800) 359-1979 Fax: (312) 782-5145

July 20, 2006

Mr. Kevin Curran
VOA Associates Incorporated
224 South Michigan Avenue
Suite 1400
Chicago, Illinois 60604

Re: Clean Fill Sample Analyses
Police District 7 Site
West 63rd Street
Chicago, Illinois

Dear Mr. Curran:

Carnow, Conibear & Assoc., Ltd. (CCA) has prepared this letter regarding "clean" fill to be utilized at the Public Building Commission of Chicago (PBCC) Police District 7 site. In the project specifications (Section 02064 Contaminated Soil Removal), it is indicated that the Remediation Areas must not be backfilled without approval of the Owner or Environmental Consultant. "Clean" fill may include stone (e.g., CA-6) or soil imported to the site or processed/recycled materials, but must be approved by the Owner or Environmental Consultant prior to transport to the site, storage at the site, or use at the site. For the use of "clean" fill as backfill material at the site, the general contractor (or designated subcontractor) shall follow these procedures:

1. Identify a potential source site/location and provide the potential source information to PBCC and CCA. Source information must include, at a minimum, location and past/current uses of the location. If recognized environmental conditions or potential contamination sources are identified, a historical report (including environmental database searches) should be prepared to and reviewed to determine whether the potential location is suitable as a source for "clean" fill;
2. Determine whether the potential "clean" fill requires quantitative analysis prior to use at the site. The only potential "clean" fill materials which would not require quantitative analysis of a representative sample are stones/gravel which are quarried and transported to the site for use. The general contractor must provide a letter to PBCC and CCA indicating that the material has not been processed or recycled. This letter must be from the quarry owner/operator and must be on corporate letterhead. Processed quarry materials and/or recycled quarry materials will require quantitative analysis. All soils and any other processed or recycled materials (e.g., concrete) must be quantitatively analyzed prior to transport, storage, and use at the Police District 7 site.
3. For quarried stone, PBCC and CCA shall review the letter from the quarry. CCA will provide written notification of the review. Based upon the results of the review, PBCC (or its designated representative) will issue written notification providing approval for use of the quarried material or denying the use of the quarried material.
4. Collect a representative sample of the proposed "clean" fill material and have the sample quantitatively analyzed to ensure that no Tier 1 Soil Remediation Objectives (SROs) are

- exceeded for this source. The quantitative analyses required for each sample are listed in **Attachment A**.
5. Provide a written copy of the sample analytical results and the laboratory analytical data package to PBCC and CCA for review and/or approval. CCA will provide written notification of the review of the analysis results. Based upon the results of the review, PBCC (or its designated representative) will issue written notification providing approval for use of the proposed "clean" fill material or denying the use of the material.
 6. Should the analyses indicate that any analyte is present at a level exceeding a Tier 1 SRO, as promulgated in Illinois Administrative Code Title 35 Part 742 (35 IAC 742), the material shall be deemed unsuitable for use as "clean" fill and shall not be used at the Police District 7 site. As indicated in the specifications, should unsuitable material be placed at the site, it will be the responsibility and cost of the contractor to remove these materials;
 7. Should the analyses indicate that the analyte levels are below Tier 1 SROs, the material shall be deemed suitable for use as "clean" fill and can be used at the Police District 7 site. One (1) soil sample from each source must be analyzed and determined to be suitable for use for every 1,000 cubic yards of "clean" fill to be placed at the site. No more than 1,000 cubic yards of "clean" fill can be transported, stored, and/or used at the site until additional sample results are provided to PBCC and CCA and the proposed "clean" fill material is approved for use (regardless of whether the proposed source has been previously approved for use). Backfill volumes utilized to determine the frequency of "clean" fill sampling shall be based on the assumption that one (1) truckload is equivalent to fifteen (15) cubic yards. This equivalency is only for use in determining the frequency of "clean" fill sampling and shall not be utilized to determine payment;
 8. Once written notification is provided that the material is suitable for use, the soil may be placed in the Remediation Areas of the site.
 9. Please note that these requirements do not include physical soil parameters (e.g., grain size) which may be required by the Architect or landscape consultant to determine the suitability of fill materials for use at the site.

These guidelines should provide the information necessary for the general contractor to determine "clean" fill sources and comply with "clean" fill requirements of the Illinois Environmental Protection Agency (IEPA).

Should you have any questions, please contact the undersigned at 312/762-2912.

Sincerely,

CARNOW, CONIBEAR & ASSOC., LTD.



Mike Duet
Team Manager

ATTACHMENT A

**REQUIRED QUANTITATIVE ANALYSES
FOR PROPOSED "CLEAN" FILL MATERIALS**

Analysis	U.S. EPA Analytical Method
Volatle Organic Compounds (VOCs)	EPA Methods 5035/8260B
Semivolatile Organic Compounds (SVOCs)	EPA Method 8270
Polychlorinated Biphenyls (PCBs)	EPA Method 8082
Pesticides	EPA Method 8081
Total Target Analyte List (TAL) Inorganic Constituents	EPA Methods 6020/7470A/7471A
pH	EPA Method 9045C
Total Petroleum Hydrocarbons (TPH)	EPA Method 8015 Modified

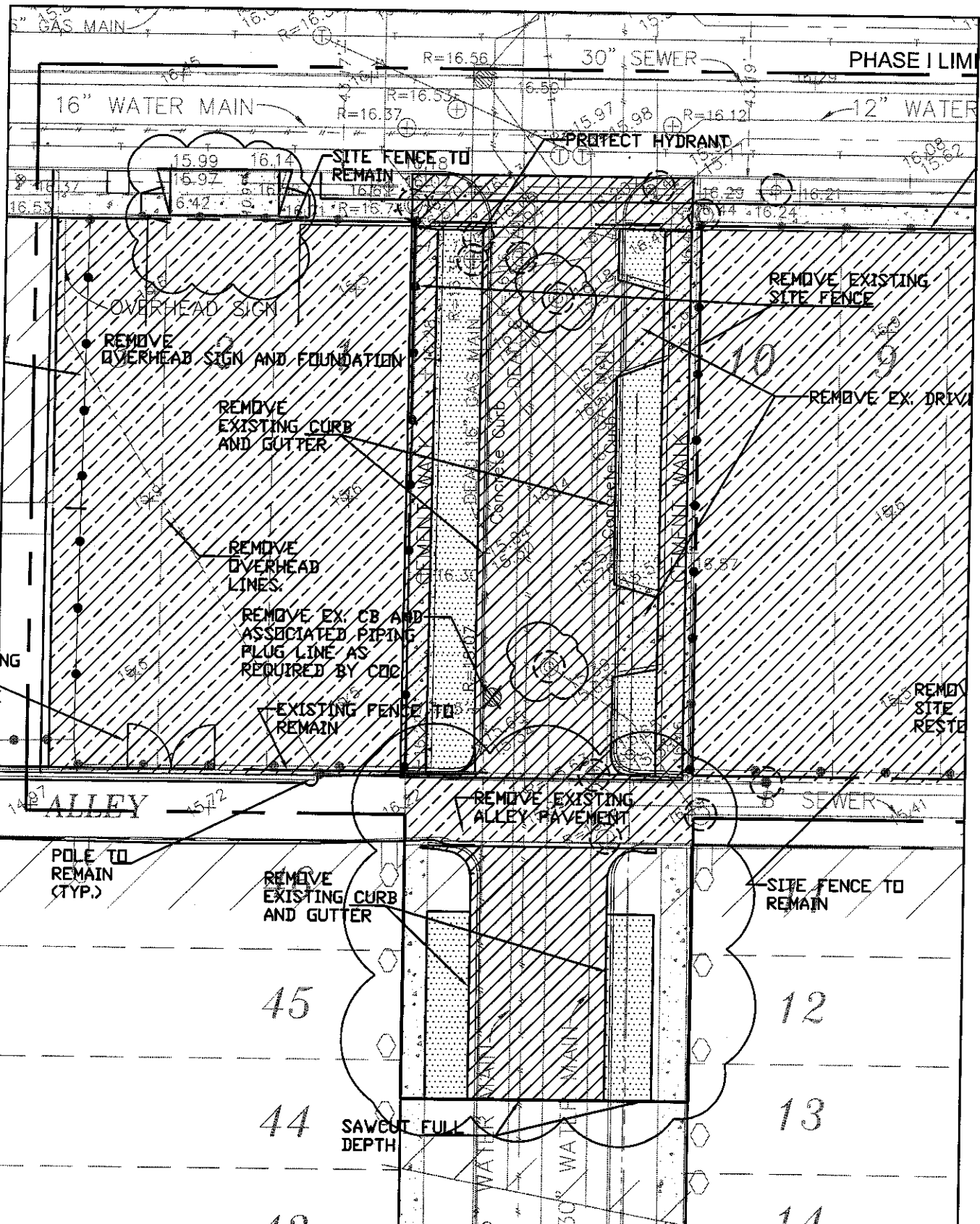

FILE: M:\POLICE\CIVIL 8-04-06\C 1.0.dwg

	VOA ASSOCIATES, INC. Architecture/Planning/Interior Design 224 South Michigan Avenue #1400 Chicago, Illinois 60604 PH: (312)554-1400 FAX: (312)554-1412	PUBLIC BUILDING COMMISSION OF CHICAGO CHICAGO POLICE DEPARTMENT - 7TH DISTRICT STATION 1400 WEST 63RD STREET, CHICAGO, IL 60636 SITE DEMOLITION REVISIONS - C1.0 ISSUED FOR ADDENDUM 01	SCALE: 1.0"=30'	DRAWN BY: GM	SHEET: CSK.1.0
			DATE: 08.10.06	CHECKED BY: KC	

PRINTED: 08/09/2006

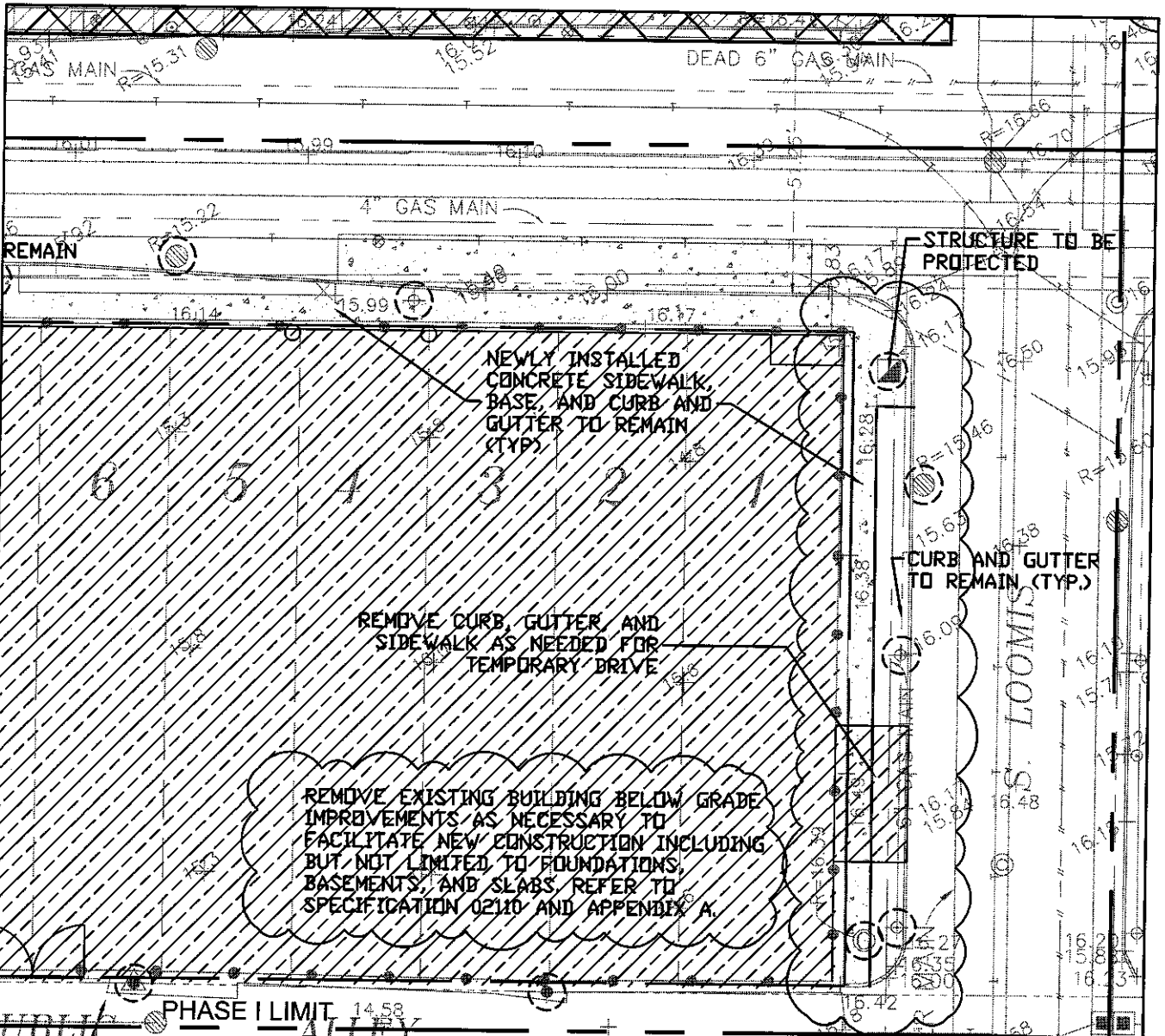

- THE EXTENT OF DEMOLITION WORK IS INDICATED ON THE DRAWINGS AND SPECIFIED HEREIN AND INCLUDES, BUT IS NOT LIMITED TO:
1. REMOVAL OF ALL UTILITIES, PILING AND OTHER SITE FEATURES WHICH CONFLICT WITH THE CONSTRUCTION OF THE NEW FACILITY, OR ARE OBSOLETE.
 2. CONDUCT DEMOLITION OPERATIONS AND REMOVAL OF DEBRIS AND SPOILS TO INSURE MINIMAL INTERFERENCE WITH FACILITY OPERATIONS.
 3. INSURE SAFE PASSAGE OF PERSONS AROUND AREAS OF DEMOLITION, REMOVED FROM SITE ALL DEBRIS, RUBBISH AND OTHER MATERIALS RESULTING FROM DEMOLITION.
 4. NOTIFY OWNED 48 HOURS IN ADVANCE OF ANY UTILITY STOPPAGE.
 5. THE CONTRACTOR SHALL COORDINATE WITH THE OWNER/ARCHITECT ALL ITEMS TO BE DEMOLISHED.
 6. IF ANY ITEMS ARE ENCOUNTERED IN THE FIELD THAT ARE NOT SHOWN ON THE PLAN NOTIFY IMMEDIATELY THE ARCHITECT. THE CONTRACTOR SHALL COORDINATE THE REMOVAL/PROTECTION WITH THE OWNER/ARCHITECT.
 7. THE SURVEY BASE PROVIDED HEREIN IS FOR INFORMATIONAL PURPOSES ONLY. THE OWNER/ARCHITECT/ENGINEER HAS NOT RESPONSIBILITY FOR ANY MISPLACED OR UNMARKED UTILITIES, OR OTHER ERRORS OBTAINED. IT IS THE RESPONSIBILITY OF THE CONTRACTOR TO VERIFY ALL SITE CONDITIONS.

8. THE CONTRACTOR SHALL PROTECT ALL UTILITIES UNDETERMINED TO REMAIN. ANY UTILITIES DAMAGED BY THE CONTRACTOR SHALL BE REPAIRED AT THE CONTRACTOR'S EXPENSE.
9. THE CONTRACTOR SHALL PAY ALL PERMITS FEES TO THE CITY OF CHICAGO AND ANY OTHER AGENCY REQUIRED FOR COMPLETION OF DEMOLITION WORK.
10. REMOVE SEWER AND PEARL PEAR DEPARTMENT OR WATER MANAGEMENT REQUIREMENTS UNLESS SHOWN ON DRAWINGS. REMOVE AND CAP ALL UTILITY SERVICES TO EXISTING BUILDINGS TO BE DEMOLISHED.
11. ALL FOUNDATION WALLS SHALL BE DEMOLISHED TO 2 FEET OR MORE BELOW FINISHED GRADE. THE EXISTING FILL SURFACE SHOULD BE PROOF-ROLLED WITH A TIRE LOADED RAMP TRUCK WITH A MINIMUM WEIGHT OF 20 TONS. ANY SOFT OR WEAK AREAS ENCOUNTERED SHOULD BE UNDOUBTEDLY. IF THERE ARE ANY AREAS WITH A SIGNIFICANT AMOUNT OF WOOD OR OTHER BULKY MATERIALS, THESE AREAS SHOULD ALSO BE UNDOUBTEDLY. NEW FILL MATERIALS SHOULD THEN BE BROUGHT INTO THE SITE TO MAKE THE GRADE BACK UP TO FINISHED GRADE. THE NEW FILL SHOULD BE DEPOSITED IN LIFTS NOT EXCEEDING 2' IN LOOSE THICKNESS AND OF ASTM D-1557 DENSITY.
12. ANY DISTURBANCE TO THE RIGHT OF WAY DUE TO UTILITIES, TRENCHING, OR GRADING WORK, SHOULD BE RESTORED TO ORIGINAL CONDITION BY CODE REQUIREMENTS.

13. REPAIR STRUCTURE OR APPROPRIATEly COORDINATE WITH THE CITY OF CHICAGO. SITE FENCE THAT IS DAMAGED OR DISPLACED DURING CONSTRUCTION/DEMOLITION.
14. DEMOLITION WORK INCLUDES BUT IS NOT LIMITED TO THE REMOVAL AND DISPOSAL OF EXISTING FOUNDATIONS TO A DEPTH OF 2 FEET BELOW THE BOTTOM OF THE SUBGRADE. THE USE OF AN EXISTING FOUNDATION WALL SHALL BE TO THE EXTENT THAT IT WILL NOT HOLD WATER.
15. ALL NEWLY INSTALLED SIDEWALKS AND CURBS AND GUTTERS TO REMAIN. CONTRACTOR TO PROVIDE DRAINAGE CONSTRUCTION AND RETURN TO ORIGINAL CONDITION. ALL EXISTING UTILITIES TO REMAIN UNLESS OTHERWISE INDICATED.
16. THE CONTRACTOR TO CLEAN DEBRIS FROM EXISTING CATCH BASIN PRIOR TO COMPLETING WORK.

FILE: M:\POLICE\CIVIL 8-04-06\C 1.0.dwg

ALLEY

8" WATER

1" SEWER

GAS MAIN

WATER MAIN

S. LOOMIS

VOA ASSOCIATES, INC. Architecture/Planning/Interior Design 224 South Michigan Avenue #1400 Chicago, Illinois 60604 PH: (312)554-1400 FAX:(312)554-1412	PUBLIC BUILDING COMMISSION OF CHICAGO CHICAGO POLICE DEPARTMENT - 7TH DISTRICT STATION 1400 WEST 63RD STREET, CHICAGO, IL 60636	SCALE: 1.0"=30'	DRAWN BY: GM	SHEET: CSK.2.0
	SITE DEMOLITION REVISIONS - C1.0 ISSUED FOR ADDENDUM 01	DATE: 08.10.06	CHECKED BY: KC	

PRINTED: 08/09/2006

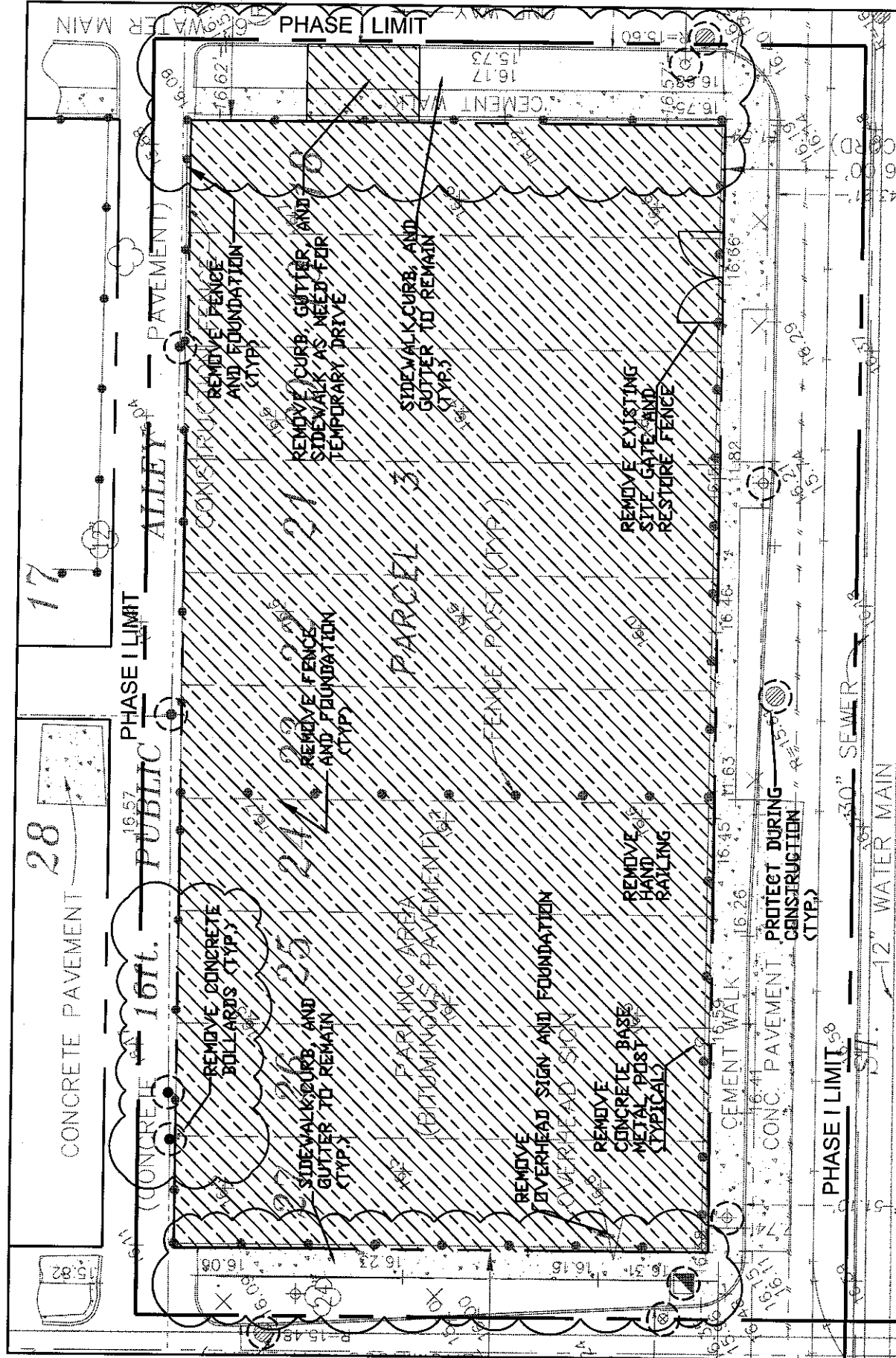

VOA ASSOCIATES, INC. Architecture/Planning/Interior Design 224 South Michigan Avenue # 400 Chicago, Illinois 60604 PH: (312)554-1400 FAX: (312)554-1412		PUBLIC BUILDING COMMISSION OF CHICAGO CHICAGO POLICE DEPARTMENT - 7TH DISTRICT STATION 1400 WEST 63RD STREET CHICAGO, IL 60638 SITE DEMOLITION REVISIONS - C1.1		SCALE: 1.0" = 30' DATE: 08.10.06	DRAWN BY: GM CHECKED BY: KC	SHEET: CSK.3.0
REVISION: ISSUED FOR ADDENDUM 01						

PRINTED: 08/09/2006

FILE: M:\POLICE\CIVIL 8-04-06\C 2.0.dwg

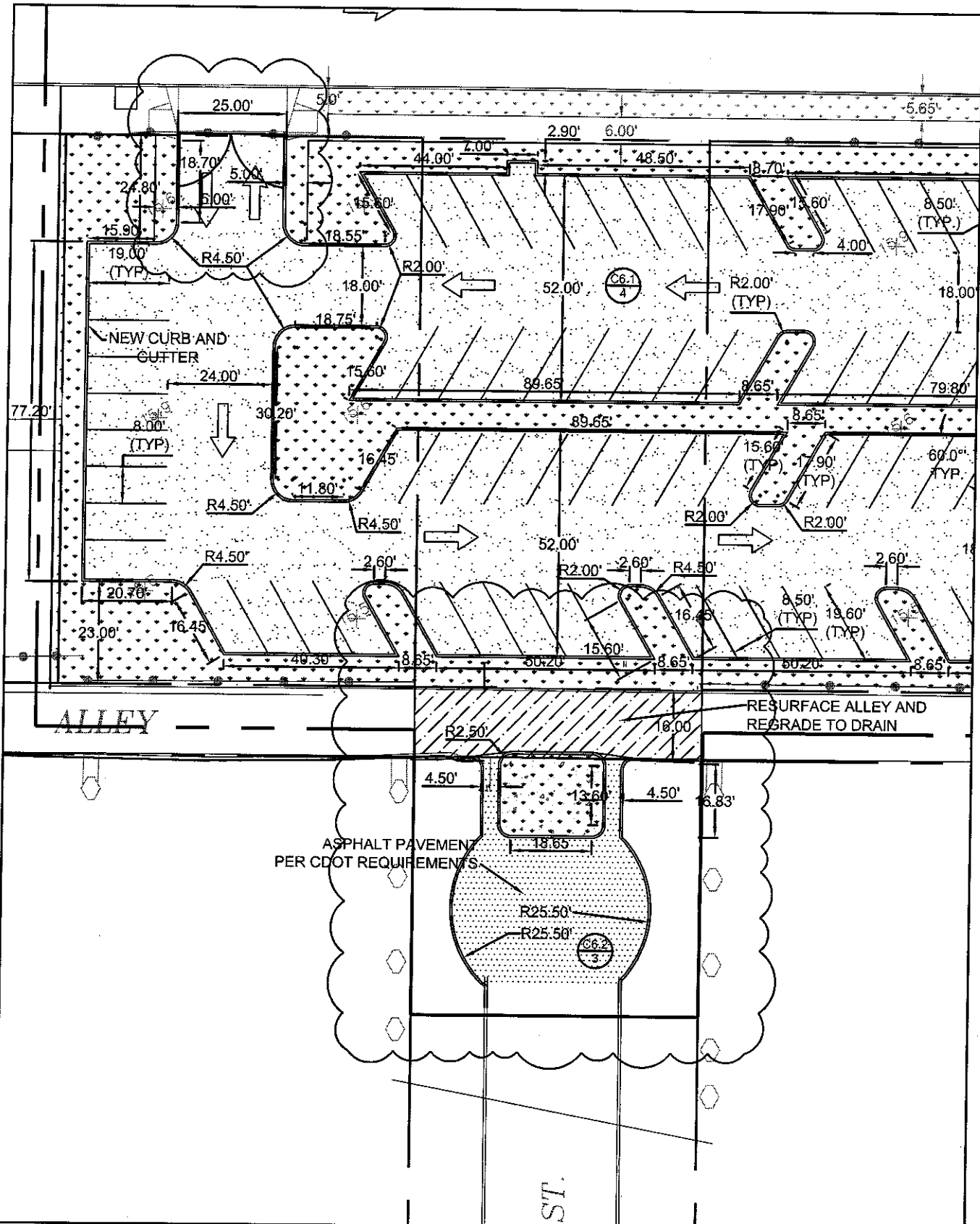

VOA ASSOCIATES, INC. Architecture/Planning/Interior Design 224 South Michigan Avenue #1400 Chicago, Illinois 60604 PH: (312)554-1400 FAX:(312)554-1412	PUBLIC BUILDING COMMISSION OF CHICAGO CHICAGO POLICE DEPARTMENT - 7TH DISTRICT STATION 1400 WEST 63RD SREET, CHICAGO, IL 60636	SCALE: 1.0"=30'	DRAWN BY: GM	SHEET: CSK.4.0
	DIMENSION REVISIONS - C2.0 ISSUED FOR ADDENDUM 01	DATE: 08.10.06	CHECKED BY: KC	

PRINTED: 08/09/2006

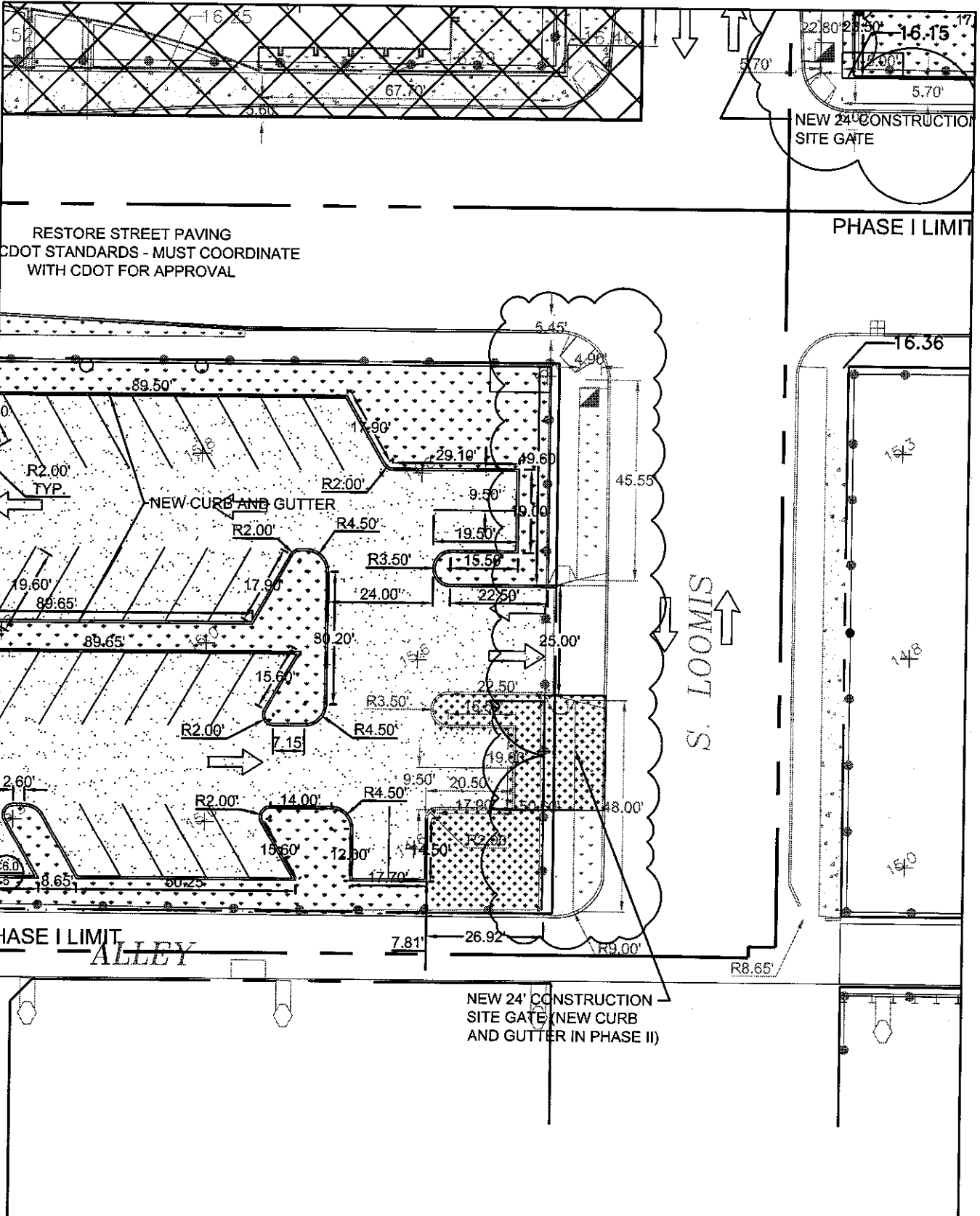

FILE: M:\POLICE\CIVIL 8-04-06\C 2.0.dwg

	VOA ASSOCIATES, INC. Architecture/Planning/Interior Design 224 South Michigan Avenue #1400 Chicago, Illinois 60604 PH: (312)554-1400 FAX: (312)554-1412	PUBLIC BUILDING COMMISSION OF CHICAGO CHICAGO POLICE DEPARTMENT - 7TH DISTRICT STATION 1400 WEST 63RD STREET, CHICAGO, IL 60636	SCALE: 1.0"=30'	DRAWN BY: GM	SHEET: CSK.5.0
	DIMENSION REVISIONS - C2.0 ISSUED FOR ADDENDUM 01	DATE: 08.10.06	CHECKED BY: KC		

PRINTED: 08/09/2006

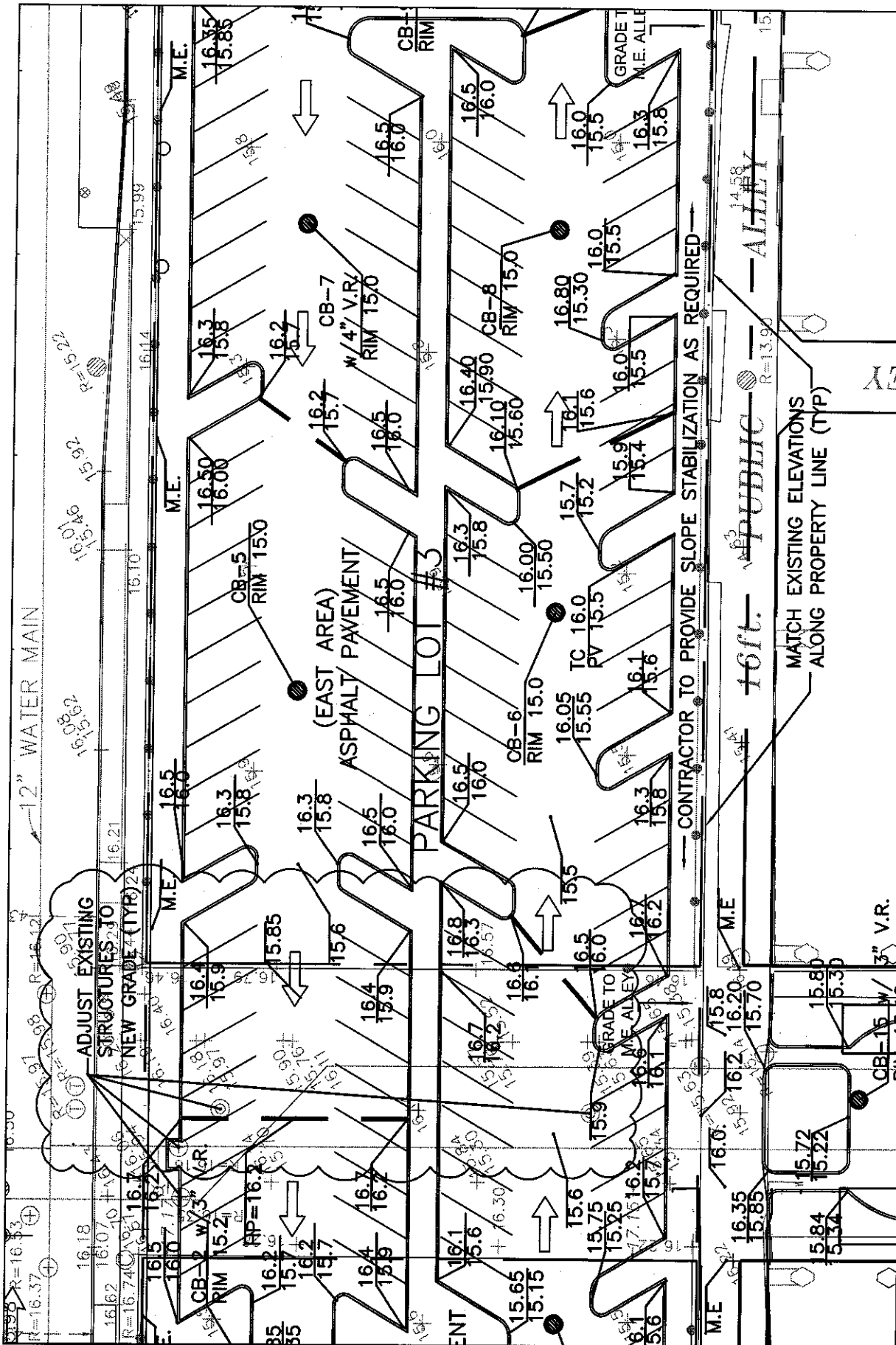

VOA ASSOCIATES, INC. Architecture/Planning/Interior Design 224 South Michigan Avenue #1400 Chicago, Illinois 60604 PH: (312)554-1400 FAX: (312)554-1412	PUBLIC BUILDING COMMISSION OF CHICAGO CHICAGO POLICE DEPARTMENT - 7TH DISTRICT STATION 1400 WEST 63RD STREET, CHICAGO, IL 60638		SCALE: 1.0" = 30'	DRAWN BY: GM	SHEET: CSK.7.0
	GRADING REVISIONS - C3.0 REVISION: ISSUED FOR ADDENDUM 01		DATE: 08.10.06	CHECKED BY: KC	

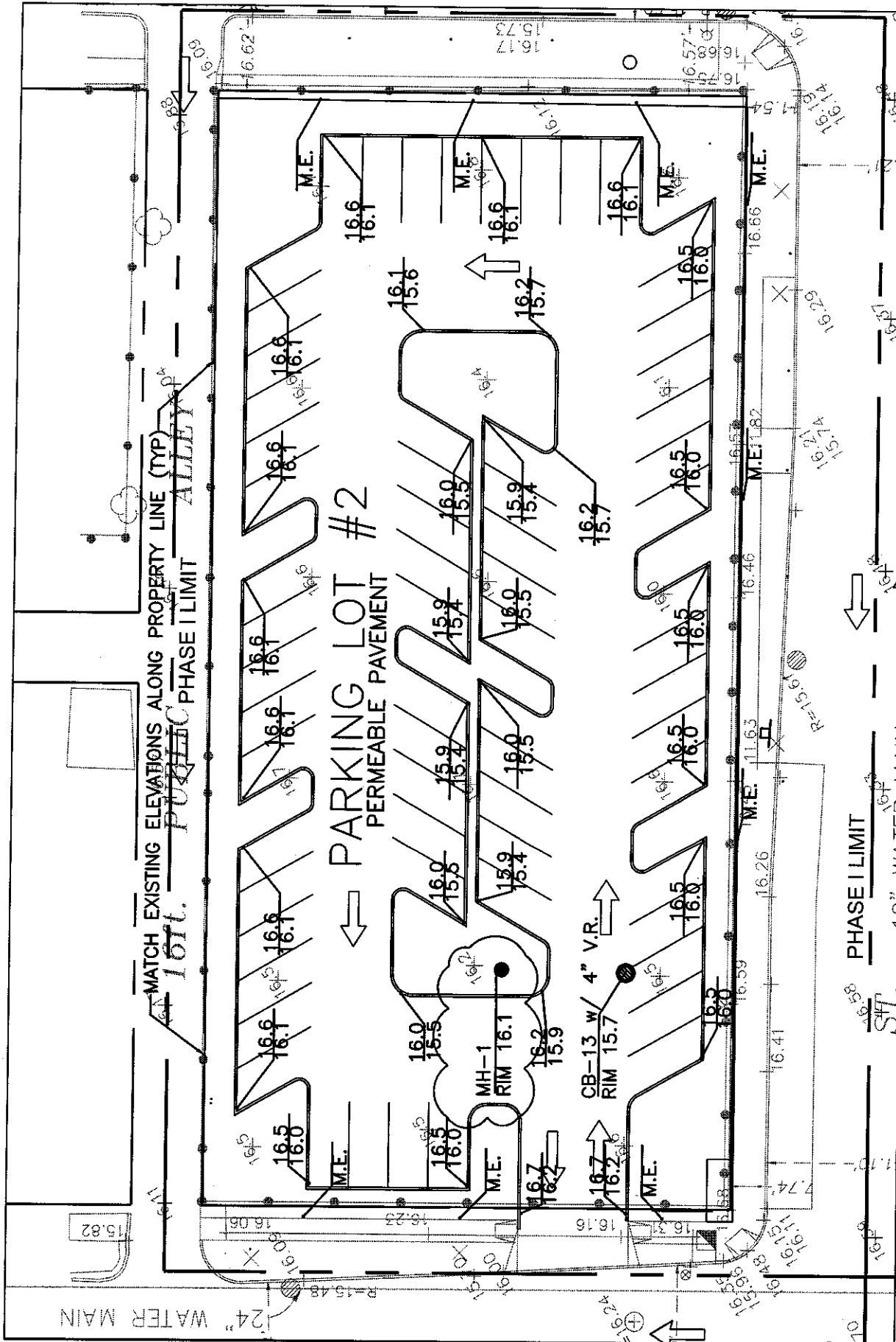

VOA ASSOCIATES, INC. Architecture/Planning/Interior Design 224 South Michigan Avenue # 1400 Chicago, Illinois 60604 PH: (312)554-1400 FAX: (312)554-1412	PUBLIC BUILDING COMMISSION OF CHICAGO CHICAGO POLICE DEPARTMENT - 7TH DISTRICT STATION 1100 WEST 63RD STREET, CHICAGO, IL 60636		SCALE: 1.0" = 30' DATE: 08.10.06	DRAWN BY: GM CHECKED BY: KC	SHEET: CSK.8.0
	GRADING REVISIONS - C3.1 ISSUED FOR ADDENDUM 01				

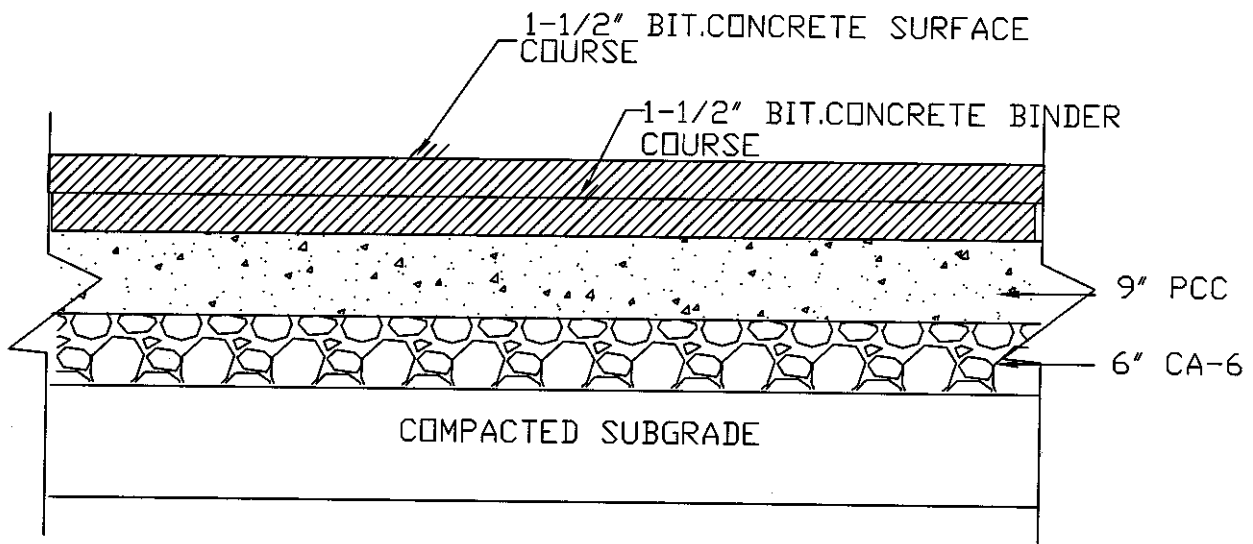

3A CDOT PAVEMENT
(N.T.S.)

FILE: M:\POLICE\CIVIL 8-04-06\C 6.0.dwg

VOA VOA ASSOCIATES, INC. Architecture/Planning/Interior Design 224 South Michigan Avenue #1400 Chicago, Illinois 60604 PH: (312)554-1400 FAX:(312)554-1412	PUBLIC BUILDING COMMISSION OF CHICAGO CHICAGO POLICE DEPARTMENT - 7TH DISTRICT STATION 1400 WEST 63RD SREET, CHICAGO, IL 60636	SCALE: N.T.S.	DRAWN BY: GM	SHEET: CSK.9
	DETAIL REVISIONS - C6.2 ISSUED FOR ADDENDUM 01	DATE: 08.10.06	CHECKED BY: KC	

PRINTED: 08/09/2006

NOTE:

REMOVE OVERHEAD SIGN
AND FOUNDATION. REFER
TO CIVIL DRAWINGS. PHOTO
PROVIDED FOR REFERENCE
ONLY.



VOA ASSOCIATES, INC.
Architecture/Planning/Interior Design
224 South Michigan Avenue #1400
Chicago, Illinois 60604
PH: (312)554-1400 FAX: (312)554-1412

VOA

PRINTED: 08/16/2006

PUBLIC BUILDING COMMISSION OF CHICAGO

CHICAGO POLICE DEPARTMENT - 7TH DISTRICT STATION
1400 WEST 53RD STREET, CHICAGO, IL 60636

REVISIONS TO AS 1
COMMERCIAL SIGN 1 ON LOT #3

REVISION:
ISSUED FOR ADDENDUM 01

SCALE:
N.T.S.

DRAWN BY:
MZ

SHEET:
ASK.01

DATE:
08.16.06

CHECKED BY:
KC

NOTE:
 REMOVE OVERHEAD SIGN,
 FOUNDATION AND ALL
 ASSOCIATED OVERHEAD
 WIRES. REFER TO CIVIL
 DRAWINGS. PHOTO
 PROVIDED FOR REFERENCE
 ONLY.

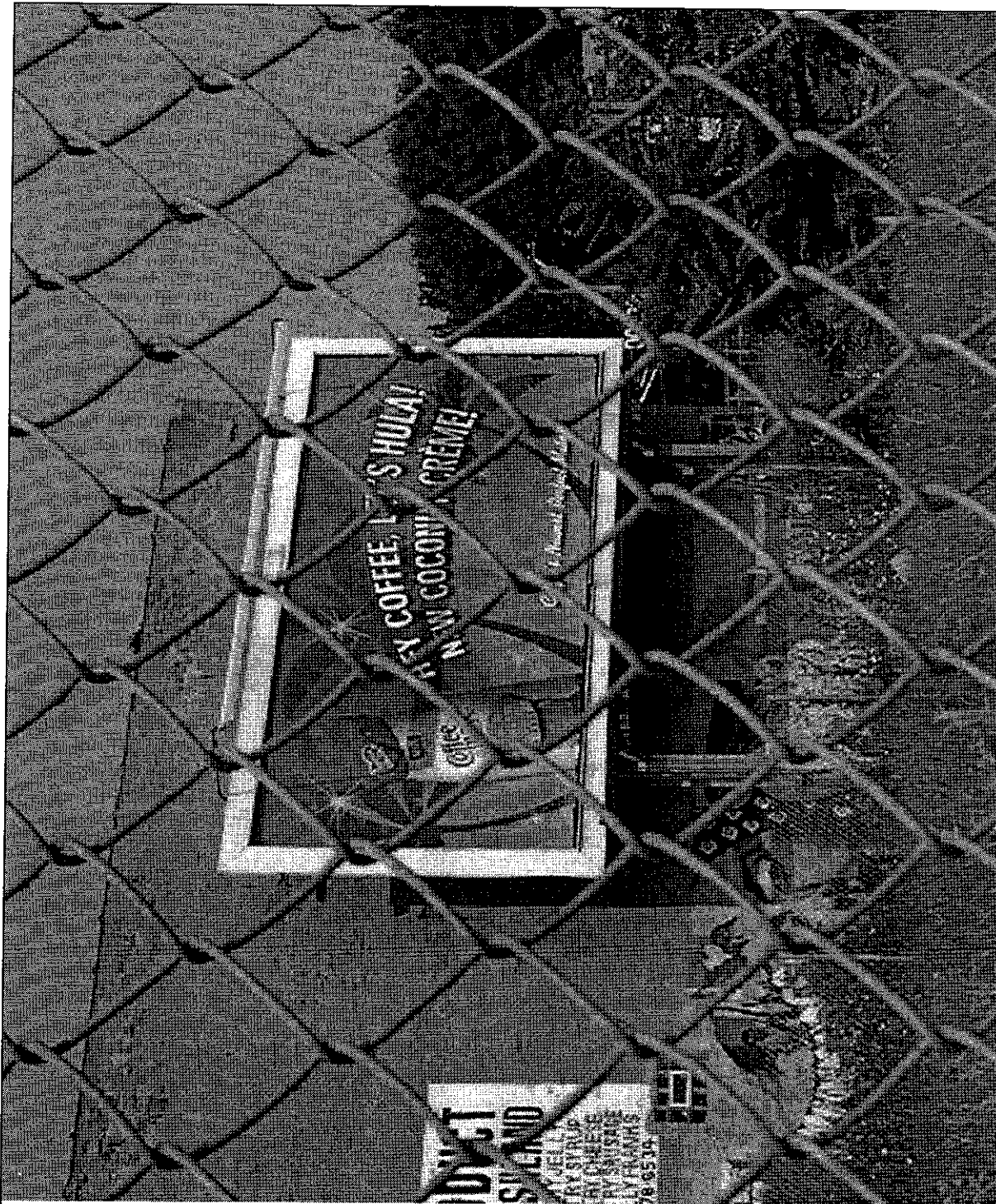

VOA ASSOCIATES, INC.
 Architecture/Planning/Interior Design
 224 South Michigan Avenue # 1400
 Chicago, Illinois 60604
 PH: (312)554-1400 FAX: (312)554-1412

VOA

PRINTED: 08/16/2006

PUBLIC BUILDING COMMISSION OF CHICAGO
 CHICAGO POLICE DEPARTMENT - 7TH DISTRICT STATION
 1400 WEST 63RD STREET, CHICAGO, IL 60638

REVISIONS TO AS.1
 COMMERCIAL SIGN 2 ON LOT #4/5
 REVISION:
 ISSUED FOR ADDENDUM 01

SCALE:
 N.T.S.

DRAWN BY:
 MZ

SHEET:
 ASK.02

CHECKED BY:
 KC

DATE:
 08.15.06

PRINTED: 08/17/2006



VOA ASSOCIATES, INC.
 Architectural/Planning/Interior Design
 224 South Michigan Avenue #1400
 Chicago, Illinois 60604
 Ph: (312)554-1400 FAX: (312)554-1412

PUBLIC BUILDING COMMISSION OF CHICAGO
 CHICAGO POLICE DEPARTMENT - 7TH DISTRICT STATION
 1400 WEST 69TH STREET, CHICAGO, IL 60636

UTILITY PLAN REVISIONS - C4.0
 REVISION:
 ISSUED FOR ADDENDUM 01

SCALE:
 1.0" = 30'

DATE:
 08.10.06

DRAWN BY:
 GM

CHECKED BY:
 KC

SHEET:
 CSK.10

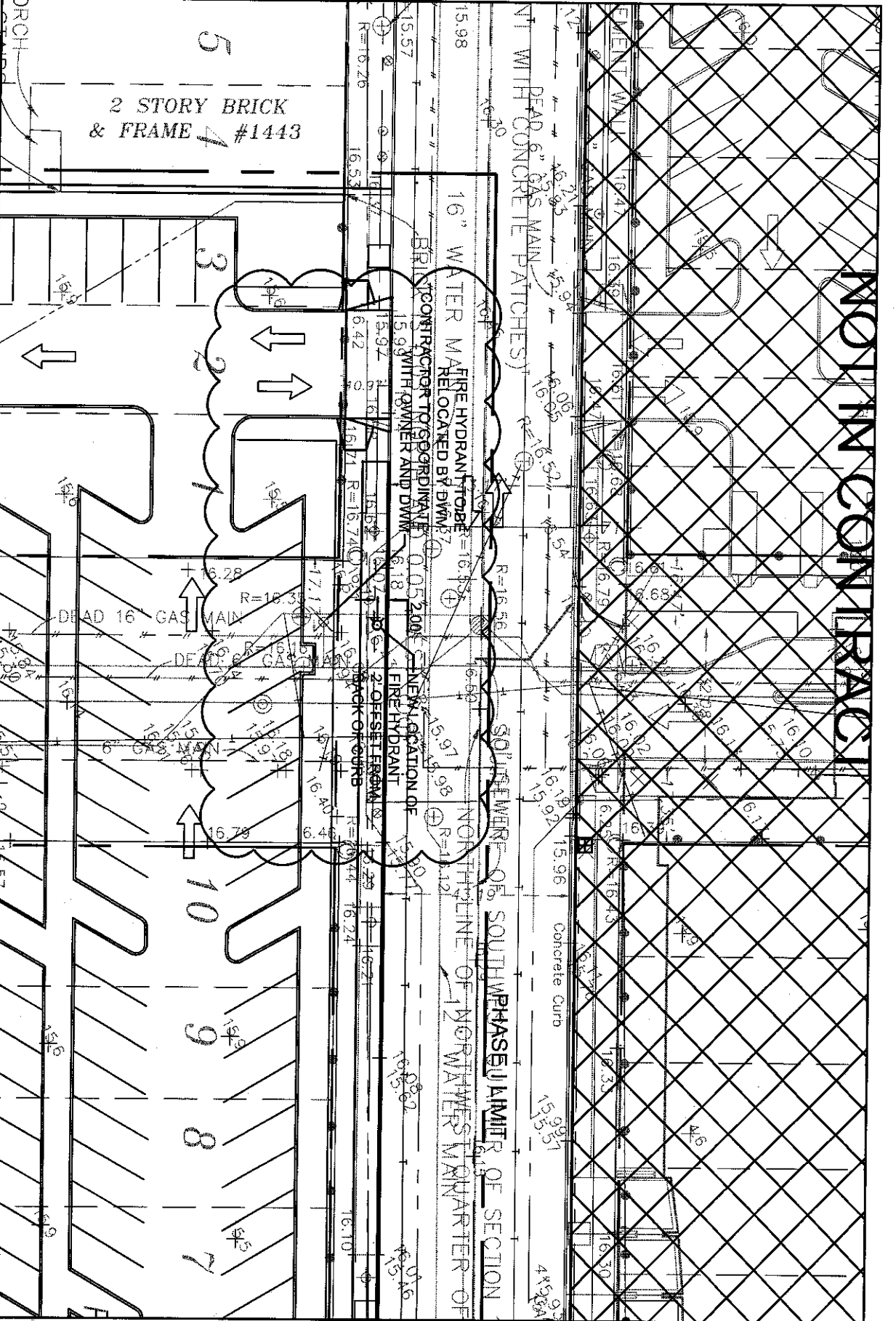

NOT IN CONTACT

PUBLIC BUILDING COMMISSION OF CHICAGO

**ADDENDUM NO. 2 TO CONTRACT NO. 1448
FOR**

**7th District Police Station
1438 W. 63rd Street**

FOR

Site Work and Underground Utilities

BY: VOA Associates Incorporated

DATE: August 21, 2006

NOTICE OF CHANGES IN CONTRACT DOCUMENTS

The following changes are hereby made in the Contract Documents. Insofar as the prior Contract Documents are inconsistent herewith, the changes mentioned hereinafter shall govern unless the original language takes precedence according to the Order of Precedence of Components of the Contract Documents.

VOID DID NOT ISSUE

END OF ADDENDUM NO. 02

Mayor Richard M. Daley, Chairman

Montel Gayles, Executive Director



September 12, 2006

Richard J. Daley Center
50 W. Washington Street
Room 200
Chicago, Illinois 60602
(312) 744-3090
Fax: (312) 744-8005
www.pbcchicago.com

Jose Maldonado
Old Veterans Construction
10942 S. Halsted St.
Chicago, IL 60628

BOARD OF COMMISSIONERS

Chairman
RICHARD M. DALEY
Mayor
City of Chicago

Treasurer
BISHOP ARTHUR BRAZIER
Pastor
Apostolic Church of God

ADELA CEPEDA
President
A.C. Advisory, Inc.

DR. ROBERT B. DONALDSON II
Forest Preserve District of Cook County

MARIÁ N. SALDAÑA
President
Chicago Park District

CYNTHIA M. SANTOS
Commissioner
Metropolitan Water
Reclamation District

SAMUEL WM. SAX
Chairman
Financial Relations, Inc.

MICHAEL W. SCOTT
President
Chicago Board of Education

JOHN H. STROGER, JR.
President
Board of Commissioners
of Cook County

GERALD M. SULLIVAN
City of Chicago

Executive Director
MONTEL M. GAYLES

Assistant Treasurer
JOHN E. WILSON
John E. Wilson, Ltd.
Certified Public Accountants

Secretary
EDGRICK C. JOHNSON

Assistant Secretary
JOE HARMENING

RE: **Notice of Award**
Contract No.: 1448
Type of Work: Site Work/Underground Utilities
Project: 7th District Police Station

Dear Mr. Maldonado:

Pursuant to resolution duly adopted by the Public Building Commission of Chicago on September 12, 2006 the Commission awarded to your company Contract No. 1448 in the amount of \$1,972,300.38.

Enclosed in duplicate is the completed Performance and Payment Bond form, all copies of which are to be executed by the President or a Vice President of your Company, attested by the Secretary or an Assistant Secretary, impressed with your Corporate Seal, and executed by your surety. Also enclosed, please find the Disclosure of Retained Parties form. All documents must be returned to the Commission, fully executed and in duplicate, along with duplicate copies of the insurance certificate of coverage. Documents must be submitted no later than September 19, 2006.

A copy of the fully executed contract will be released and sent to your office once all requirements have been met.

Sincerely,

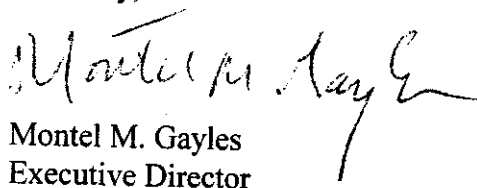
Montel M. Gayles
Executive Director

cc: P. Spieles
Trinal
R. Giderof



Richard J. Daley Center
50 W. Washington Street
Room 200
Chicago, Illinois 60602
(312) 744-3090
Fax: (312) 744-8005
www.pbcchicago.com

BOARD OF COMMISSIONERS

Chairman
RICHARD M. DALEY
Mayor
City of Chicago

Treasurer
BISHOP ARTHUR BRAZIER
Pastor
Apostolic Church of God

ADELA CEPEDA
President
A.C. Advisory, Inc.

DR. ROBERT B. DONALDSON II
Forest Preserve District of Cook County

MARIÁ N. SALDAÑA
President
Chicago Park District

CYNTHIA M. SANTOS
Commissioner
Metropolitan Water
Reclamation District

SAMUEL WM. SAX
Chairman
Financial Relations, Inc.

MICHAEL W. SCOTT
President
Chicago Board of Education

JOHN H. STROGER, JR.
President
Board of Commissioners
of Cook County

GERALD M. SULLIVAN
City of Chicago

Executive Director
MONTEL M. GAYLES

Assistant Treasurer
JOHN E. WILSON
John E. Wilson, Ltd.
Certified Public Accountants

Secretary
EDGRICK C. JOHNSON

Assistant Secretary
JOE HARMENING

November 15, 2006

Jose Maldonado
Old Veterans Construction
10942 S. Halsted St.
Chicago, IL 60628

RE: **NOTICE TO PROCEED**
Contract No.: 1448
Project No.: PD 007
Type of Work: Site Work/Underground Utilities
Project: 7th District Police Station

Dear Mr. Maldonado:

Pursuant to Contract No.1448, which was awarded to your firm on September 12, 2006 you are hereby notified that the commencement date for this project is **November 16, 2006.**

Pursuant to the Contract, all work must be completed within **98** consecutive calendar days of the commencement date. The substantial completion date is established as **March 16, 2007.** Your attention is directed to Section I. F of Book 2 of the Contract regarding Liquidated Damages for failure to complete the work by the completion date.

In accordance with Section 15.02.3 of Book 1, the invoice target date is established as the 15th day of each month. Such invoice shall cover work performed as of the last day of the previous month. If the target date falls on a weekend or holiday, your payment application must be received on the next business day. Failure to submit payment applications as directed constitutes an event of default and may result in payment delays.

The administration and inspection of the work included in this Contract is under the direction of the Public Building Commission. Ray Giderof will perform as the Portfolio Manager for the Public Building Commission. Please submit the original and three copies of all correspondence pertaining to this work to:

Name: Ray Giderof
Company: Public Building Commission of Chicago
Address: 50 W. Washington, Suite 200
Chicago, IL 60602



Please reference the PBC project number and Contract Number on all correspondence.

This Notice To Proceed authorizes you to enter upon the project site and commence with the work on November 16, 2006.

This Notice To Proceed does not authorize any of your subcontractors to enter upon the project site or to commence any work prior to subcontractor approval by the Commission's representative pursuant to Section 19.03 of Book 1 "Standard Terms and Conditions for Construction Contacts".

Sincerely,

Montel M. Gayles
Executive Director

MMG/dz

Cc: J. Plezbert
P. Spieles
K. Holt
K. Curran
M. Witte
J. Brankin
M. Gayles
R. Giderof
J. Stein
N. Jahnel
Trinal

ACORD CERTIFICATE OF LIABILITY INSURANCE		OP ID 23 OLDVE-1	DATE (MM/DD/YYYY) 10/06/06
PRODUCER Hausman-Kunkel, Inc 40 South Prospect Roselle IL 60172 Phone: 630-894-7510 Fax: 630-894-4333		THIS CERTIFICATE IS ISSUED AS A MATTER OF INFORMATION ONLY AND CONFERS NO RIGHTS UPON THE CERTIFICATE HOLDER. THIS CERTIFICATE DOES NOT AMEND, EXTEND OR ALTER THE COVERAGE AFFORDED BY THE POLICIES BELOW.	
INSURED Old Veteran Construction Inc. 10942 S Halsted Chicago IL 60628		INSURERS AFFORDING COVERAGE	NAIC #
		INSURER A: Central Insurance Companies	20222
		INSURER B: Accident Fund	13044
		INSURER C:	
		INSURER D:	
		INSURER E:	

COVERAGES

THE POLICIES OF INSURANCE LISTED BELOW HAVE BEEN ISSUED TO THE INSURED NAMED ABOVE FOR THE POLICY PERIOD INDICATED, NOTWITHSTANDING ANY REQUIREMENT, TERM OR CONDITION OF ANY CONTRACT OR OTHER DOCUMENT WITH RESPECT TO WHICH THIS CERTIFICATE MAY BE ISSUED OR MAY PERTAIN, THE INSURANCE AFFORDED BY THE POLICIES DESCRIBED HEREIN IS SUBJECT TO ALL THE TERMS, EXCLUSIONS AND CONDITIONS OF SUCH POLICIES. AGGREGATE LIMITS SHOWN MAY HAVE BEEN REDUCED BY PAID CLAIMS.

INSR ADD'L LTR INSRG	TYPE OF INSURANCE	POLICY NUMBER	POLICY EFFECTIVE DATE (MM/DD/YY)	POLICY EXPIRATION DATE (MM/DD/YY)	LIMITS		
A	<input checked="" type="checkbox"/> GENERAL LIABILITY <input checked="" type="checkbox"/> COMMERCIAL GENERAL LIABILITY <input type="checkbox"/> CLAIMS MADE <input checked="" type="checkbox"/> OCCUR	CLP7976266	03/05/06	03/05/07	EACH OCCURRENCE \$ 1000000		
					DAMAGE TO RENTED PREMISES (Ea occurrence) \$ 100000		
					MED EXP (Any one person) \$ 5000		
					PERSONAL & ADV INJURY \$ 1000000		
					GENERAL AGGREGATE \$ 2000000		
					PRODUCTS - COMP/OP AGG \$ 2000000		
GEN'L AGGREGATE LIMIT APPLIES PER: <input type="checkbox"/> POLICY <input type="checkbox"/> PRO-JECT <input type="checkbox"/> LOC							
X	<input checked="" type="checkbox"/> AUTOMOBILE LIABILITY <input checked="" type="checkbox"/> ANY AUTO <input type="checkbox"/> ALL OWNED AUTOS <input type="checkbox"/> SCHEDULED AUTOS	BAP7974114	03/05/06	03/05/07	COMBINED SINGLE LIMIT (Ea accident) \$ 1000000		
					BODILY INJURY (Per person) \$		
		X	<input checked="" type="checkbox"/> HIRED AUTOS <input checked="" type="checkbox"/> NON-OWNED AUTOS	BAP7974114	03/05/06	03/05/07	BODILY INJURY (Per accident) \$
							PROPERTY DAMAGE (Per accident) \$
GARAGE LIABILITY <input type="checkbox"/> ANY AUTO							
A	<input checked="" type="checkbox"/> EXCESS/UMBRELLA LIABILITY <input checked="" type="checkbox"/> OCCUR <input type="checkbox"/> CLAIMS MADE	CKS7976267	03/05/06	03/05/07	EACH OCCURRENCE \$ 9000000		
					AGGREGATE \$ 9000000		
					DEDUCTIBLE RETENTION \$		
B	WORKERS COMPENSATION AND EMPLOYERS' LIABILITY ANY PROPRIETOR/PARTNER/EXECUTIVE OFFICER/MEMBER EXCLUDED? If yes, describe under SPECIAL PROVISIONS below	WCV5010480	03/05/06	03/05/07	<input checked="" type="checkbox"/> WC STATUTORY LIMITS <input type="checkbox"/> OTHER \$ 500000		
					E.L. DISEASE - EA EMPLOYEE \$ 500000		
					E.L. DISEASE - POLICY LIMIT \$ 500000		
A	<input type="checkbox"/> OTHER Equipment Floater	CLP7976266	03/05/06	03/05/07	All Risk 145,000 500 Ded		

DESCRIPTION OF OPERATIONS / LOCATIONS / VEHICLES / EXCLUSIONS ADDED BY ENDORSEMENT / SPECIAL PROVISIONS

Contract #1448 Project: 7th District Police Station/Pollution Exposure is included in the amount of \$5million per occurrence, includes completed ops contractual liability, defense, environmental cleanup, remediation and disposal. The Public Building Commission and the City of Chicago are named as Additional Insureds on Primary & Noncontributory basis for any liability

ol come 10/10/06

CERTIFICATE HOLDER CHIC-11 City of Chicago Public Building Commission 50 W Washington St Chicago IL 60602	CANCELLATION SHOULD ANY OF THE ABOVE DESCRIBED POLICIES BE CANCELLED BEFORE THE EXPIRATION DATE THEREOF, THE ISSUING INSURER WILL ENDEAVOR TO MAIL 60 DAYS WRITTEN NOTICE TO THE CERTIFICATE HOLDER NAMED TO THE LEFT, BUT FAILURE TO DO SO SHALL IMPOSE NO OBLIGATION OR LIABILITY OF ANY KIND UPON THE INSURER, ITS AGENTS OR REPRESENTATIVES. AUTHORIZED REPRESENTATIVE Hausman Kunkel
---	---

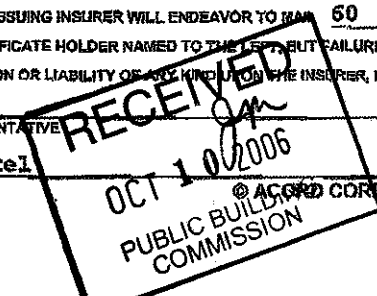

NOTEPAD FILE EDIT VIEW FORMAT TOOLS HELP PAGE 1
NOTEPAD.SAV C:\WINDOWS\SYSTEM32\COMMAND.COM 10/6/06 DATE: 10/06/06

arising directly or indirectly from the work